

Glenbrook North High School

Curriculum Guide

2010-2011

Glenbrook North High School is committed to provide programs which meet the unique educational needs, interests, abilities and aspirations of our varied student body. The curriculum presents opportunities for students to pursue various academic interests through a combination of required academic courses and elective offerings. This *Curriculum Guide* is intended to provide the Glenbrook North school community with a comprehensive list of course offerings available to students as well as school rules and Board Policies that govern the educational program. The formulation of the student's schedule of classes is a very important process that should involve the student, parent(s) and GBN staff. This begins with teacher recommendations regarding courses and level but also involves course selection by the student. We encourage students and parents to spend time reviewing the *Curriculum Guide* prior to scheduled meetings with their counselor. School staffing is dependent upon student course requests, so it is important that students make careful selections and remain committed to those choices. It should be noted that at the time of this printing there are several new courses which are *Pending Board Approval* and will be noted as such in this publication.

Course Selection and Placement

Incoming Freshmen Placement:

Recommendations for placement of incoming freshmen are made in cooperation with eighth grade teachers using a holistic interpretation of the following criteria:

- The student's local percentile scores for reading and language on the Terra Nova Exam (TNVA).
- The student's local percentile TNVA scores in mathematics and InView Quantitative Reasoning subtest (math placement only).
- The student's cognitive score on the TNVA "InView" test.
- Eighth grade teacher assessments of the student's study habits.
- Eighth grade teacher placement recommendations.
- Student's grades in respective eighth grade courses.
- Other pertinent information (special projects, writing awards, evidence of language talent, special interest in the subject area).

No single criterion will determine a student's placement level. The school looks at each student individually and strives to match the student with the course level in which he/she will be academically challenged and also motivated to succeed. This initial placement is not a permanent designation and is reviewed twice yearly.

Appeals:

In order to appeal the placement decision, students must obtain a *Request for Change in Course Level Placement* form which will be available in the junior high or middle schools in March. These forms must be completed and returned to the respective Instructional Supervisor no later than March 22, 2010. The student will be scheduled for a placement test given in April for the respective subject area(s) which will provide additional data for reviewing the student's placement. As a result of this additional information, the final placement decision along with the results of the subject area placement test(s) are mailed to parents. Counselors will adjust the student's schedule when changes are warranted.

Current Student Placement:

Similar to the process described above, the student's current teachers from the respective academic areas make recommendations in course placement level for the upcoming school year. They take into account the student's academic ability and study habits. Teachers consider each student individually, striving to match the student with the course level in which he/she will be academically challenged and also motivated to succeed. This placement is not a permanent designation and is reviewed twice yearly.

2010-2011 CURRICULUM GUIDE

ANTIDISCRIMINATION STATEMENT

Classes and programs are offered to students regardless of their race, color, national origin, sex or disability.

GRADUATION REQUIREMENTS

The following units of credit are required for graduation from the Glenbrook High Schools for students entering as ninth-graders in the 2007-08 school year:

English (1)	4.00 units*
Physical Education (2)	3.50 units
Mathematics (3)	3.00 units
Social Studies (4)	2.00 units
Science (5)	2.00 units
Applied Arts (6)	0.50 units
Consumer Education	0.50 units
Driver Education (7)	0.25 units
Fine Arts (8)	0.50 units
Health	0.50 units
Electives	7.25 units

TOTAL NUMBER OF UNITS: 24 units

**The term "unit" designates a full-year course.*

The Board of Education has prescribed that the following courses are required for graduation:

ENGLISH – 4.0 units of credit.

MATHEMATICS – 3.0 units of credit.

SCIENCE – 2.0 unit of credit.

SOCIAL STUDIES – 2.0 units of credit.

History of World Civilizations (recommended)

U.S. History (required)

PHYSICAL EDUCATION – 3.5 units of credit.

Students are required to be enrolled in a physical education course during each semester they are enrolled in the district; enrollment in the required health course satisfies this requirement for that semester. If the student enrolls in health during summer school, the student is required to enroll in physical education for the entire year.

HEALTH – .5 unit of credit.

DRIVER EDUCATION – .5 unit or .25 unit of credit.

The classroom phase of driver education is required for graduation; the behind-the-wheel phase is not required. Students who elect not to participate in the behind-the-wheel phase may graduate with 0.25 credits less than the total required units of credit.

CONSTITUTION TEST

According to the law of the State of Illinois, a graduate from a public high school must have received a passing grade on an examination covering: (1) the Constitution of the United States and the State of Illinois; (2) The Declaration of Independence; (3) voting procedures; and (4) the proper display of the American flag. Preparation and testing is included as part of the U.S. History course.

CONSUMER EDUCATION – .5 unit of credit.

ELECTIVE COURSES – 7.0 units of credit.

FINE ARTS – .5 unit of credit.

All courses offered in art, drama, music, debate, and Radio/Television Broadcasting meet the Fine Arts requirement.

APPLIED ARTS – .5 unit of credit.

All courses offered in Applied Technology, Business Education, Family and Consumer Science and Radio/Television and Broadcasting meet the Applied Arts requirement.

Exceptions:

Business Mathematics does not meet the Applied Arts requirement. Radio/Television and Photography meet either the Fine Arts or Applied Arts requirement.

TOTAL: 24 units of credit

(Including 4 units of credit required for physical education classes)

Although world language courses are not required for graduation, students are encouraged to take advantage of these opportunities to develop lifelong skills in addition to preparing for post high school educational opportunities.

The Board of Education requires that students be enrolled in a minimum of six courses for credit each semester of enrollment.

GRADING AND GRADING SYMBOLS

The numerical equivalent of the letter grade system at Glenbrook North High School is as follows:

A = 90-100

B = 80-89

C = 70-79

D = 60-69

F = 0-59

All grades, including final grades, are calculated by teachers through the averaging of percentages rather than through the numerical averaging of letter grades.

Once the percentage is determined, it is translated into a letter grade according to the above table. Letter grades are given a numerical weighting for grade point averaging as follows:

A = 4

B = 3

C = 2

D = 1

F = 0

Each number except an "F" grade is increased by one point for honor courses for academic grade point.



GRADE POINT AVERAGE

Two grade point averages will be computed for each student. Both grade point averages will be included on transcripts for other academic institutions or agencies, as requested by the student.

The all-subject grade point average includes all courses for which a letter grade is awarded, for any area of instruction or level of difficulty. No weighting system is used, and all courses are considered of equal rank regardless of the level of instruction (i.e. honors and advanced placement or other courses are also scored on a four-point scale).

The academic grade point average includes only those courses in the areas of English, world language, mathematics, science, and social studies for which a letter grade is awarded. While honors courses are usually limited to these five areas, this does not preclude the possible inclusion of honors courses in the other areas. Such courses are so identified if they meet the criteria established by the superintendent and are approved by the principal/designee.

Weighting of courses is included in the method for determining grade point average as described in paragraph #3, above. The following point system, based upon the level of instruction, will be used:

Grade	Honors, Advanced Placement & Academy	All Other Courses
A	5 points	4 points
B	4 points	3 points
C	3 points	2 points
D	2 points	1 points
F	0 points	0 points

Letter grades received from schools outside District 225. District 225 are recorded on a student's transcript but will not be counted in the student's grade point average.

COURSE DESIGNATIONS

Glenbrook North High School uses a combination of titles and numbers for course designations. Under this system, the first digit indicates the sequence in a series of courses, the second digit indicates the academic level and the third digit indicates the semester of the course. The following should be of help in explaining the course designation system:

First Digit

- 1 – first course in a sequence
- 2 – second course in a sequence
- 3 – third course in a sequence
- 4 – fourth course in a sequence

Second Digit

- 6 – Regular/G/GT
- 7 – Honors
- 8 – Advanced Placement
- 9 – Academy

Third Digit

- 1 – first semester course content (one semester)
- 2 – second semester course content (one semester)
- 3 – first and second semester course content (full year)

Examples:

English 163 is a first course in English at the regular level covering two semesters of work.

Small Engines 161 is a first course in Small Engines at the regular level indicating semester one content.

CREDITS

All credits are awarded on a semester basis. A student receives one-half unit of credit for each course which meets a minimum of one 90-minute block every other day for one semester.

ADVANCED PLACEMENT COURSE POLICY

The purpose of the Advanced Placement program is to prepare students for the AP examination which may result in college credit. In an effort to support the intentions of the program, the following policy has been established:

1. According to Board of Education policy, students enrolled in advanced placement courses must take AP examinations in order to receive AP credit. Students who do not take an AP examination to complete the course will receive honors level credit for the course.
2. All students who enroll in an AP course must pay the examination fee. The fee for this school year will be approximately \$86 per examination. (\$126 for late registration)
3. Fees will not be refunded.
4. Students **who withdraw before completing** the entire course will not receive AP credit.
5. Students who are unable to pay for the AP examinations because of financial difficulties should see their counselors.
6. Students who are not enrolled in an AP class who wish to take an AP exam must obtain permission from the respective instructional supervisor.

HONORS COURSES DIFFERENTIATION

Honors level courses differ from regular level courses in the following ways:

- Honors courses have an increased expectation of independent learning.
- Topics are explored in greater depth.
- Honors courses demand higher inferential thinking, more extensive application and extrapolation of learning.
- The curriculum requires greater analysis, synthesis and evaluation of concepts.
- Assignments and class work require a higher degree of academic rigor.
- Honors courses have more stringent grading/performance standards.

GLENBROOK ACADEMY OF INTERNATIONAL STUDIES

The Academy is a four-year district-wide program for those who have demonstrated a history of academic excellence and interest in a concentrated program of international studies. The Academy meets two blocks daily for coordinated, intensive training in English, world language and social studies. Application is made during the spring of eighth grade. Further information is available from the Academy office, 847-509-2044.

GLENBROOK TEAM PROGRAM

The Glenbrook North Team Program is a regular level academic program designed to help students experience success in their learning through a curriculum that emphasizes both content and skills in appropriately paced instruction. Students may be enrolled in one, two, or all four courses in the areas of math, science, or English and social studies. Interdisciplinary courses help students see the interconnectedness of learning while working to improve reading, writing, oral presentation, test taking, critical thinking and study skills. Most classes are team-taught, and student are evaluated and recommended to transition into and out of the program each year.

For further information contact: Mary Rockrohr, 847-509-2631, or Robin Sheperd, 847-509-2651.

GLENBROOK SCHOLARS

The principal of each school designates as Glenbrook academic scholars members of each year's senior class who meet the established academic criteria for Glenbrook Scholars. The minimal criteria for a student who has completed three full semesters at a Glenbrook high school to be designated as a Glenbrook Scholar is the following:

	Glenbrook Scholar Requirements
English	4.0 Units of Credit
Mathematics	3.0 Units
Science	3.0 Units
Social Studies	3.0 Units
History of World Civ. (<i>recommended</i>)	
U.S. History (<i>required</i>)	
Physical Education	3.5 Units*
Health	0.5 Units
Driver Education	0.5 Units*
Constitution Test (<i>Within U.S. History</i>)	
Consumer Education	0.5 Units*
Elective Courses	3.0 Units
Fine Arts	0.5 Units
Applied Arts	0.5 Units
World Language	2.0 Units
TOTAL	24.0 Units of Credit
Academic GPA Minimum	4.50
All-Subject GPA Minimum	3.50

**Requirement may be fulfilled through an approved exemption.*

NATIONAL HONOR SOCIETY

Membership in Glenbrook North's National Honor Society is based on scholarship, service, leadership and character. Each component is considered essential in the selection process.

To be eligible for election to membership, a student must have at least **junior standing**. The student is required to have a minimum grade point average of 3.5 on the all-subject GPA or 4.0 on the academic GPA.

In addition to academic eligibility, a candidate must submit an application. The application consists of an essay and a list of extracurricular activities, achievements and service experiences. An eligible applicant must be currently involved in at least three activities, one of which is service oriented. Each activity or award must be validated by a sponsor, teacher or coach.

Filing an application does not guarantee membership. After a faculty committee reviews and evaluates each application using the Society's tenets of scholarship, service, leadership and character, a list of students recommended for membership is forwarded to the sponsors of the Society.

HONOR ROLL

At the conclusion of each semester, the Honor Roll is computed, printed and distributed to the appropriate school offices and the local media. Students are selected for the Honor Roll according to the following standards:

A student must earn at least a 3.300 all-subject grade point average (GPA) where: A=4 points; B=3 points; C=2 points. A course will not be considered in the calculation of the grade point average if the student earned any of the following grades in the course: Pass, Audit, Medical, Withdraw or if the course is less than .5 units per semester.

A student is automatically disqualified from consideration if s/he receives any of the following grades in any course used to calculate the honor roll: D, I, F, WE.

PASS-FAIL PROGRAM

The Pass-Fail Program was established to de-emphasize the concern for grades while emphasizing the concern for learning. It is hoped that the program will encourage students to broaden their education by venturing into areas they might otherwise avoid because of the possibility of negatively affecting grade point average. By removing this inhibitor, students should have a greater opportunity to discover and exercise their talents or interests by increasing the array of courses available for selection.

1. In courses awarding more than .25 credit for the semester, students are eligible to take any 6-level course on a per semester pass/fail basis. Honors-level courses require the permission of the principal or the principal's designee.
2. All students are eligible to participate in the Pass/Fail Program for peer counseling/leader and all courses awarding .25 credit or less per semester.
3. A maximum of 2.0 (*4 classes*) credits may be earned in the Pass/Fail Program during the four years of high school. Permission of the principal or the principal's designee is required to exceed the 2.0 credit limit.
4. A student may elect the pass/fail option for one course each semester of eligibility, or two courses in one semester provided no courses are taken pass/fail in any other semester of the same year, including summer school.
5. Pass/Fail students are expected to meet the same course requirements as other students in the class.
6. Prerequisites will not be waived for students seeking to enroll in the Pass/Fail Program.
7. The criteria for receiving credit with "P" for a course taken pass/fail will be a grade of "C" or better on the teacher's grading scale for all students in the class.
8. The course title and a letter grade are entered on the student's quarter grade and final exam report. A grade "P" (pass) or "F" (fail) is entered on the student's report card at the end of the semester.
9. The student's transcript reflects the course title and credit if the course is satisfactorily completed but the "P" grade does not count in grade point average. If the student fails to do satisfactory work, the student's transcript reflects the course title and an "F" grade, which is computed in the grade point average.
10. Students may apply for the program by completing the Pass/Fail Program Request form which is available in the Student Services Office. The request for Pass/Fail will be discussed by the student's counselor, the teacher of the course requested as Pass/Fail, and the student submitting the request between the beginning of the second quarter of the semester and up to eight days after the second quarter progress report due date. Final approval for the Pass/Fail request must be completed by the eighth school day after the second quarter progress report due date. A Pass/Fail request is irrevocable once a course has been approved as Pass/Fail; only a grade of "P" or "F" may be earned for that semester.
11. The principal or the principal's designee is authorized to make exceptions to the Pass/Fail Program on a case-by-case basis.

WITHDRAWAL FROM CLASS

Students are permitted to withdraw from a course during the first two weeks of the semester without penalty. Courses dropped during this time period will not appear on the student's transcript. A student who withdraws within the first nine weeks, but after the second week, receives a "W" grade for that course on his/her transcript. A student must officially withdraw from a class no later than eight (8) school days after the completion of the first quarter of the semester. A student who withdraws after the quarter and eight (8) school days is subject to a "WF" grade for that course on the transcript.

EARLY GRADUATION

Because of the value inherent in a person's high school experience apart from his/her accumulation of the 24 credits necessary for graduation, Glenbrook believes s/he should spend a full four years in high school. Student age and mental development are all factors important in the last year of high school; the last half of the senior year provides further opportunity for the student to realize potential before leaving the high school phase of life. Consequently, a student meeting graduation requirements will graduate at the completion of eight semesters unless compelling circumstances make graduation before eight semesters a matter of urgent importance. Application for early graduation (7 semesters) should be made through the student's counselor by May of the junior year.

REPEAT OF COURSE

Any student who wishes to repeat a course may do so within one calendar year of first enrolling in the course. Both grades received (the initial grade and the repeat grade) are recorded on the student's transcript and the higher of the two grades is calculated into the grade point average. Students repeating a course because of a previous failure and the need to meet a graduation requirement are given priority for enrollment.

ABSENCES AND MAKEUP WORK

Block classes aim to engage students in learning activities which largely cannot be duplicated outside the classroom. Consequently, attending class is critical. Inevitably, students will be absent from class in cases of illness, family emergency and other unavoidable conflicts. **When makeup work accumulates, students may become overwhelmed, the quality of their work may deteriorate and the learning experience may be compromised.** After an absence, **THE STUDENT MUST TAKE RESPONSIBILITY** for making up any missed work, including tests, quizzes, exams, essays, reading assignments and projects.

- For each day of **excused absence**, a student is allowed one day of make-up time; a *day of absence* is defined as a day of school rather than class attendance. [Reason for an excused absence includes illness of the student, death in the family, religious holidays, participating in election day activities, school-sponsored activities and Learning Adjustment Center (LAC) placement.]

EXAMPLE: If Susie Student is absent for her A-day class and returns to school on B-day, that B-day is her makeup time. On that B-day (her return-to-school day), she must pick up the materials she needs for her next A-day class and will be expected to be prepared for that A-day class.

- The same basic rule applies to extended absences.
- If a student is present in school on a particular day but called out to miss a particular period, the work due on that day is still due on that day; extended makeup time does not apply.

- In the instance of an **explained absence**, the student has the obligation to inform his/her teacher prior to the absence and make appropriate arrangements at that time to complete any missed work. If students do not take the initiative in these instances, the teacher is under no obligation to accommodate makeup work. [Parent-approved absences, such as vacations, are considered by the building administrator for approval as an explained absence if the request is made by the parent prior to the absence.]
- If a student is absent on the day prior to an exam or due date for an assignment, except under extreme circumstances, the student is still expected to turn in the work due or take the exam on the day of his or her return.

EXAMPLE: If Paul Pupil has known that on September 19, an A-day he is to turn in his essay on "The Lottery" or that he will be taking a unit exam in algebra, but he was absent on September 18 because of a bout with allergy, his teacher will expect him to turn in his essay or to take his algebra test as scheduled. However, if Paul's mother was taken to the hospital for emergency surgery, his teacher is likely to understand when Paul explains that he has forgotten his essay or was too distracted to prepare for his algebra exam.

- When students do not follow established procedures covering delayed work, teachers are under no obligation to give full or even partial credit.
- In the case of unexcused absences and out-of-school suspensions, teachers may not give full or even partial credit.
- Teachers will respond to extenuating circumstances individually.

WRITING ADVISORY GRADE

Students receive an advisory grade which assesses their writing skills in English, social studies, science, mathematics, health education and consumer education.

The writing advisory grade appears only on the report card. It does not count in grade point average, nor does it appear on the transcript. As the name implies, these grades are only intended to be advisory.

FINAL EXAMINATIONS

The semester evaluation schedules and procedures are developed to implement the Board of Education's Final Examination Policy (7260). Each student must complete semester evaluations according to Administrative guidelines. It is *not* within the teacher's prerogative to permit deviations from established evaluation dates and times.

Semester Evaluation Adjustments:

An adjustment in the evaluation schedule may be arranged if a student is scheduled for three evaluations on one day. The following steps are required: (1) Student obtains evaluation adjustment form from administrative assistant for to Associate Principal/Curriculum. (2) Student requests that teacher of scheduled third evaluation complete form. (3) Student returns evaluation adjustment form to Associate Principal's administrative assistant. (4) Procedure must be completed a minimum of five school days before the scheduled evaluation. (5) No fee is required.

Early/Late Semester Evaluations:

Evaluations are scheduled for the last three school days of each semester. It is imperative that students and parents not schedule vacations, jobs or other commitments during evaluation times; however, in extraordinary circumstances it may be necessary to request a deviation from established dates and times. Parents must contact the Associate Principal/Curriculum to review any adjustment requests. No fee is required.

SECOND SEMESTER SENIOR FINAL EXAM POLICY

1. A senior student with an 80% average and five or fewer absences (school-sponsored field trips, participation in Advanced Placement examinations and other school-sponsored activities will not count against the five excused absences) and with no unexcused absences or out of school suspensions may have the option of waiving the final.
2. A senior student with a 90% average in the class may also have the option of waiving the final. The only attendance requirement is no unexcused absences.
3. By the nature of the course, if a final exam is deemed critical to a fair assessment of the student's work, the student takes the final whether either of the conditions mentioned in #1 or #2 have been met. The instructor of the class, Instructional Supervisor and Principal (or designee) make this decision.
4. The computation of the grade is completed by the teacher one week prior to the senior final time schedule if the option is to be made available to students in their classes.

POLICY ON COURSES TAKEN IN NON-GLENBROOK PROGRAMS

Students are strongly encouraged to take advantage of summer programs offered by the Glenbrooks; however, it is recognized that some student needs are better met by programs offered at educational institutions outside the district. Students sometimes enroll in summer programs at institutions such as other area high schools or nearby colleges or universities. We recognize that courses offered by colleges and universities, as well as other high schools, may enrich students academically and serve as positive learning experiences. However, courses taken for credit outside Glenbrook High School District #225 will not be accepted by the school or entered on the student's official transcript unless the following conditions are met:

1. The school or center within a college or university must be accredited for high school work.
2. The college or university cannot describe the course(s) as "college level." The student cannot receive high school credit for work that is awarded credit at the college level. The exception to this is a class offered at Oakton Community College under the "Concurrent Enrollment" provision.
3. The student must obtain permission from Glenbrook North High School prior to enrolling or participating in an educational course outside the Glenbrooks that is being taken for credit and will be transferred to Glenbrook North for inclusion on the student's transcript.

The amount of credit granted by Glenbrook North will be determined by the number of teacher/student contact hours scheduled by the school or institution and GBN's assessment of the appropriateness of the course.

It should be noted that honors courses offered by the Glenbrooks contain more rigor and extensive content. Any course taken at the honors level outside of Glenbrook will be evaluated individually before it is accepted for honors credit. In a similar manner, summer classes completed in another accredited high school program will be evaluated by the number of contact hours, course title, and the course curriculum, to determine the appropriateness of the course, the level, and the amount of credit awarded. The notation on the student's official GBN transcript indicates that the course was not completed in the Glenbrooks, and the grade appears on the transcript but is not computed into the GPA.

Procedures:

1. The student must see his/her counselor before enrolling in any external school course. The counselor advises the student whether the course is appropriate academically for the student.
2. The student then secures the "Glenbrook North High School Approval Request Form for External Course," completes Section 1 of the form and submits it to the Instructional Supervisor of the appropriate department.
3. The Instructional Supervisor completes Section 2 of the form and submits it to the Assistant Principal for Student Services who distributes it to the parent, counselor and registrar.

Glenbrook North recognizes summer school and other external classes as an acceptable method for students to remediate or gain additional credit for acceleration. However, we reserve the right to grant credit utilizing the above guidelines.

CORRESPONDENCE AND INTERNET COURSES

Under extraordinary circumstances, a student's needs may most appropriately be met by enrollment in a supervised, independent study course by correspondence or internet. In such cases, the administration is authorized to approve enrollment in these courses for credit towards the Glenbrook graduation requirements. A maximum of two units of credit obtained by the completion of approved correspondence/internet courses may be applied towards the Glenbrook graduation requirements.

Students may enroll in a correspondence/internet course only with prior written approval of the Assistant Principal for Student Services. In determining whether enrollment in a correspondence/internet course is the appropriate educational experience for a student, the Assistant Principal for Student Services considers such factors as: 1) the availability of programs provided at Glenbrook, 2) the number of credits needed by the student to meet graduation requirements, 3) the age of the student, 4) the availability of Glenbrook summer and evening school courses. When correspondence/internet classes are approved, their cost is at student/parent expense.



ATHLETIC/PHYSICAL EDUCATION WAIVER

Junior and senior students who participate in a Board of Education approved varsity interscholastic athletic team shall be eligible to substitute the varsity athletic team participation for enrollment in one semester of Physical Education, during the semester in which the student is participating in the varsity athletic team. Eligibility for such substitutions shall be subject to the following conditions:

1. The student shall continue to be required to be enrolled in a minimum of six courses during the semester in which the varsity athletic team participation is substituted for participation in Physical Education.
2. To substitute varsity athletic participation for enrollment in physical education for an entire semester, the student must replace the physical education course with another course for credit.
3. A student who is not enrolled in another course for credit may substitute varsity athletic participation during the official season for participation in the physical education class in which they are enrolled. They will remain enrolled in the physical education class and will be expected to fully participate at all times during the semester that is outside of the official varsity athletic season. Students electing this option will be expected to follow the established policies of the physical education department for attendance during the official varsity athletic season.
4. The student must remain on the varsity athletic team through at least the first scheduled contest. Students removed from a team prior to the last day for class schedule changes shall be re-enrolled in Physical Education.
5. Students who are not able to continue their participation on a varsity athletic team because of injury shall not be required to re-enroll in Physical Education.
6. A student on a winter varsity athletic team, i.e., a team with schedule that spans first and second semester who elects to substitute varsity athletic participation for enrollment in Physical Education, must do so during the first semester.
7. A student participating in athletic teams in two separate seasons (fall, winter, spring) may elect to substitute athletic participation for enrollment in Physical Education during each semester, provided that the two separate seasons are a combination of a fall or winter sport and a spring sport.
8. If a student requests the substitution of participation in a varsity athletic team in Physical Education at registration time, indicating an intention to be a part of an athletic team later in the year, and that student subsequently does not go out for the team or does not complete the other conditions listed above, the student shall be required to make up the enrollment in and credit for Physical Education for that semester.
9. Credit toward graduation will not be given for the semester during which varsity athletic team participation is substituted for physical education.

**ALL REQUESTS FOR FULL SEMESTER EXEMPTION MUST BE RECEIVED
BY THE PHYSICAL EDUCATION INSTRUCTIONAL SUPERVISOR
PRIOR TO THE EIGHTH DAY OF THE SEMESTER**

If a student is cut from or quits the sport for which they are receiving a waiver, they will immediately be assigned to a Physical Education class if room is available. Should room not be available, then summer school may be necessary to comply with graduation requirements.

Waivers must be signed by the student, parent, and coach and may be picked up in the athletic office.



TESTING

- I Testing days
 - A. Definitions
 1. Tests are culminating evaluations of chapter or unit objectives. These instruments constitute a major portion of the 9 week grade.
 2. Quizzes are impromptu or planned evaluations of a lesser value covering a segment of the chapter or unit objectives.
 3. Alternative evaluations are any type of evaluation other than tests or quizzes that are used to measure the attainment of course objectives.
 - B. During the nine week grading periods quizzes and tests can be given any day of the week by any department.
 - C. All major projects for the nine weeks are due on or before the Friday which precedes the last week of the nine week grading period.
- II Grading and return of evaluations
 - A. Quizzes and tests must be graded and returned to the students in a timely fashion.
 - B. All tests and quizzes must be passed back and discussed in class with the students being given the opportunity to ask questions in class.
 - C. Tests and/or quizzes may or may not be given to the student to keep but if not, tests and answer sheets must be kept on file through the end of the semester. Upon request teachers will allow parents and/or students review privileges of the tests under direct supervision of staff. Review privileges will allow the parent and/or student to examine both answer sheet and test.
 - D. Final exams need not be reviewed in class but students and parents must be given review privileges for at least one semester following the exam under direct supervision of staff.
- III In order that evaluations not be interrupted in the last week of the nine week period field trips or other school authorized absences shall not be allowed during this week. Other than senior assemblies held after senior final exams, no assemblies or other class interruptions shall be allowed during this last week of the nine week grading period.
- IV Make-up tests need not be identical to the tests given to the rest of the class but must test the same objectives.
 - A. Make-up tests must be completed within a length of time equal to the absence for all but unexcused absences.
 - B. Students who have an unexcused absence will receive a zero for the test.
- V The type of evaluation shall be the prerogative of the teacher. Alternative evaluations must be defined and expectations must be explained to the students in written form. Evaluations other than written tests must be graded in a timely fashion and the results given to the students in written form.



SCHEDULE CHANGES

Students are permitted to initiate schedule changes only when the changes are clearly warranted. The addition or removal of courses in a student's schedule must be completed by the sixth school day of each new semester. Since registration for each school year is completed by the preceding March, ample time is provided for careful program planning by the parents, counselor and student. School staffing is dependent upon student course requests, so it is important that students make careful selections and remain committed to those choices. Changes in registration are allowed through April 5, with certain important exceptions permitted, when advisable, up to the end of the school year in June.

Despite this policy, it is recognized that circumstances may dictate the following exceptions:

1. A change because of a special approval, prerequisite, or graduation requirement. Evidence must be shown to indicate that such a change is necessary.
2. A change due to attendance or failure to attend summer school or failure of a summer school course.
3. A change from one level to another. Such a change may be made only with the written approval of the department instructional supervisor.
4. A change initiated by a staff member requesting aides, monitors, lab assistants, etc. The student must be in a study hall or SRT for the period requested.
5. A change for reasons of health. The approval of the Assistant Principal of Student Services is required along with a written statement from the student's physician.
6. A change due to administrative action, such as cancellation of a class.
7. Students whose schedule change request does not meet one of the above criteria may drop but not add a class once the semester has begun. Schedule changes are not made for the purpose of specific teacher selections or to provide access to Late Arrival or Early Release.
8. In the rare situation in which a student wishes to request a teacher change, s/he is asked to contact the Instructional Supervisor (I.S.) in the specific academic discipline and explain the reason for the request. The I.S. will address the student's concern, and may consult with the instructor. This process may or may not result in a teacher change.

EARLY DISMISSALS AND LATE ARRIVALS

The Board of Education recognizes that some students may need a shorter school day because of work experiences outside of school, illness or serious home obligations. The Board also understands that a few students may encounter difficulty adjusting to a full day of school and may profit from a shortened school day. The Board authorizes early dismissals and late arrivals to students when circumstances warrant. **Application for early dismissal and late arrival should be made through the student's counselor.**

At least one of the following circumstances must exist before an early dismissal or late arrival is granted:

1. The student has a need for employment which requires a shortened school day.
2. The student has a family-related situation which requires the student's presence.
3. The student needs a shortened school day, in the judgment of the principal.

Students eligible for standard Late Arrival/Early Release must be juniors or seniors. Before granting an early dismissal or late arrival, the following criteria must be met:

1. For Late Arrival, written request from the parent, which indicates the specific need for a shortened school day, must be submitted. In the case of health issues, a letter from the physician is required.
2. Early release applications for employment require the signature of the employer. Please note that we make periodic checks with the employer to be sure the student continues to require early release.
3. The student's current schedule must have openings (no scheduled classes) at the beginning of the day for Late Arrival, or at the end of the day for Early Release. The schedule may not be changed to accommodate this request.
4. Approval of the request must comply with state requirements. The student must be enrolled for at least 300 minutes of school attendance per day.
5. Students must be registered in at least 6 courses.
6. No student is released earlier than 2:10 P.M. for reasons of employment, other than those students enrolled in a school conducted work/study program.
7. Students who have been granted late arrival must report to school by 8:25 am for attendance purposes.
8. No student may have both a late arrival and an early dismissal on the same day.
9. **Students may not shorten their school days because of tutoring, need for additional sleep or transportation convenience.**



LABORATORY ASSISTANT PROGRAM

Certain departments at Glenbrook North offer .25 units of credit each semester to students who successfully perform duties as laboratory assistants. A maximum of one unit of credit may be earned towards graduation.

The laboratory assistant program is designed to provide students with the opportunities to:

1. Gain applied knowledge of a specific subject field.
2. Explore career opportunities.
3. Develop the discipline necessary to function as a lab assistant, teacher or tutor in the specific area assigned.
4. Gain a sense of self-worth through rendering service to others.
5. Apply some of the principles learned in the classroom to a work-related experience.
6. Learn to follow directions and work under the leadership of adults. Students who have a desire to become a lab assistant should contact the instructional supervisor/administrator of the department of interest.
7. Lab assistants are evaluated prior to each grading period. A copy of the evaluation form is sent home and another kept in the student's temporary file.



CLASS SIZE

In accordance with school policy, any course with an enrollment of less than 15 students is subject to cancellation.

INSTRUCTIONAL SUPERVISORS

Career and Life Skills.	Patrick Compobasso	509-2440
Applied Technology		
Business Education		
Family and Consumer Sciences		
English	Ed Solis	509-2501
Fine Arts.	Chad Davidson	509-2455
Art		
Drama		
Music		
Radio/Television Broadcasting		
Mathematics	Robin Levine-Wissing	509-2699
Physical Education/Health/Driver Education.	Bob Pieper	509-2425
Science	Mary Rockrohr	509-2631
Social Studies	Robin Sheperd	509-2561
Special Education	Eric Etherton	509-2667
World Languages.	Ann Koller	509-2525

State Universities in Illinois At a Glance

Summary of Minimum High School Course Requirements for Admission of Freshmen to Illinois Public Universities – Effective 2010 –

	Total	English	Social Studies	Mathematics	Science	Electives and Other Requirements
Chicago State + Eastern Illinois Northeastern Illinois	15	4 ¹	3 ²	3 ¹⁰	3 ¹³	2 years of foreign language, music, vocational education or art 2 years of academic or vocational electives.
Western Illinois +	15	4 ¹	3 ²	3 ¹⁰	3 ¹³	2 years of foreign language (FL) or 2 years of fine arts (FA) or a combination of 1 year FA/FL and 1 year of vocational education. 2 years of foreign language, music, vocational education, art, theatre, film, religion, philosophy, speech or journalism
Illinois State	15	4	2	3 ¹⁰	2 ¹⁴	2 years of one foreign language or fine arts; and 2 years of electives,
Northern Illinois	15	4 ²	3 ¹²	3 ¹¹	3 ¹⁷	2 units (one must be foreign language, art, or music); 3 units of the required 15 units may be distributed by deducting no more than one unit from the categories of social studies, sciences, and electives and completing those 2 units in any of the 5 categories of coursework.
Southern Illinois University						
Carbondale	15 or 16	4 ¹	3 ²	3 or 4 ¹¹	3 ¹³	2 years of electives in foreign language, art, fine arts, music or vocational education; if a foreign language is taken, it must include two semesters of the same language.
Edwardsville	15	4 ¹	3 ²	3 ¹²	3 ¹⁴	2 years chosen from foreign language, music, the visual arts, theatre, dance and/or vocational education.
University of Illinois						
Chicago	15	4 ²	3	3	3 ¹³	2 years of foreign language; 1 year of an elective.
Springfield	15	4 ²	3 ²	3 ¹⁰	3 ¹⁴	2 years of one foreign language or 2 years of fine arts, selected from art, music, dance and theatre are required.
Urbana-Champaign	15 or 15.5	4 ²	2 ²	3 or 3.5 ¹⁴	2 ¹³	2 years of one foreign language are required; and 2 years (flexible academic units) from any of the five subject categories. Approved art, music, or vocational education courses may be counted in the flexible academic units category.

NOTES:

- Suggested Electives – includes other academic courses.
- Emphasizing written and oral communication and literature.
- Three units of English must be courses emphasizing written and oral communication and literature.
- Emphasizing grammar, composition, written and oral communication, and literature; may include not more than 1 year of creative writing or journalism.
- Studies in language, composition, and literature requiring practice in repository writing in all such work. Coursework should emphasize reading, writing, speaking, and listening.
- Emphasize history and government.
- One unit must be U.S. history or a combination of U.S. history and government.
- At least 2 years of history and/or government; other acceptable subjects are anthropology, economics, geography, psychology, and sociology.
- History and government are preferred. Additional acceptable social studies include anthropology, economics, geography, philosophy, political science, psychology, and sociology.
- One unit must be American History plus 1 unit of history, government, psychology, economics or geography.
- Introductory through advanced algebra, geometry, trigonometry, or fundamentals of computer programming (Computer programming not applicable at ISU).
- Three to four units of college-preparatory mathematics, including one year of geometry and one year of advanced algebra and/or trigonometry.
- Algebra I & II, and a proof-based geometry course. A fourth unit is highly recommended; trigonometry and pre-calculus, or statistics, depending on the student's area of interest.
- One year of introductory algebra, 1 year of geometry, 1/2 year of algebra beyond the introductory year, and 1/2 year of more advanced mathematics or fundamentals of computer programming.
- Algebra, geometry, advanced algebra, trigonometry. Typically, such courses as career/occupational mathematics, consumer mathematics, applied business mathematics, pre-algebra, and computer courses are not acceptable. 3.0 years of mathematics including trigonometry are required in the following curricula: Agricultural, Consumer and Environmental Sciences – agricultural engineering; Business – all curricula; Engineering – all curricula; Fine and Applied Arts – architectural studies; Liberal Arts and Sciences – specialized curricula in Biochemistry, chemical engineering, chemistry, geology, and physics.
- Algebra, geometry, advanced algebra, trigonometry.
- Laboratory sciences.
- Two units must be courses in the physical or biological sciences. One unit must be a laboratory science.
- One year of biology, 1 year of chemistry, and 1 additional year of earth science, physics, biology, or chemistry. (All must be laboratory sciences.)
- Laboratory courses in biology, chemistry, or physics are preferred. Laboratory courses in astronomy and geology are also acceptable. General science will not be acceptable.

CAREER AND LIFE SKILLS

APPLIED TECHNOLOGY COURSES	FRESHMAN	SOPHOMORE	JUNIOR	SENIOR
Architecture Studio 163	Offered	Offered	Offered	Offered
Architecture Studio 263		Offered	Offered	Offered
Architecture Studio 363			Offered	Offered
Architecture Studio 463			Offered	Offered
Automotives 161		Offered	Offered	Offered
Automotives 261		Offered	Offered	Offered
Automotives 262		Offered	Offered	Offered
Drafting 161	Offered	Offered	Offered	Offered
CAD Drafting 261	Offered	Offered	Offered	Offered
Construction Skills for Service 161		Offered	Offered	Offered
Game Design & Theory 161		Offered	Offered	Offered
Metals 161	Offered	Offered	Offered	Offered
Metals 263		Offered	Offered	Offered
Metals Tech 163	Offered	Offered	Offered	Offered
Metals Tech 263		Offered	Offered	Offered
Plastics 161	Offered	Offered	Offered	Offered
Small Engines 161	Offered	Offered	Offered	Offered
Small Engines 261		Offered	Offered	Offered
Vocational Survey 161	Offered	Offered	Offered	Offered
Welding 161	Offered	Offered	Offered	Offered
Welding 261	Offered	Offered	Offered	Offered
Intro to Woodworking 161	Offered	Offered	Offered	Offered
Intro to Woodworking 162	Offered	Offered	Offered	Offered
Advanced Wood Machining 261		Offered	Offered	Offered
Intro to Cabinetry 262		Offered	Offered	Offered
Principles of Applied Science and Technology			Offered	Offered
*Robotics/Microprocessors 161		Offered	Offered	Offered
*Electricity 161	Offered	Offered	Offered	Offered
*Living in Space/Robotics 161, 261	Offered	Offered	Offered	Offered
*Electronics 161	Offered	Offered	Offered	Offered
*Electronics 261		Offered	Offered	Offered
*Digital Electronics 161		Offered	Offered	Offered
*Digital Electronics 261		Offered	Offered	Offered
Vocational Autos 363			Offered	Offered

BUSINESS EDUCATION COURSES	FRESHMAN	SOPHOMORE	JUNIOR	SENIOR
Accounting 161		Offered	Offered	Offered
Business Law 161		Offered	Offered	Offered
Computer Applications 161	Offered	Offered	Offered	Offered
Multimedia Applications 261	Offered	Offered	Offered	Offered
Consumer Education G 161				Offered
Consumer Education 161				Offered
Consumer Education 171				Offered
Introduction to Business 161	Offered	Offered	Offered	Offered
Management 161		Offered	Offered	Offered
Marketing 161		Offered	Offered	Offered
Keyboarding 161	Offered	Offered	Offered	Offered
Work Partnership Program 163			Offered	Offered
Career Placement Program 161			Offered	Offered

FAMILY AND CONSUMER SCIENCE COURSES	FRESHMAN	SOPHOMORE	JUNIOR	SENIOR
Introduction to Human Growth & Development 161	Offered	Offered	Offered	Offered
Educational Foundations: Introduction to Teaching 261	Offered	Offered	Offered	Offered
Teaching Internship & Seminar 361			Offered	Offered
Clothing 161	Offered	Offered	Offered	Offered
Clothing 261	Offered	Offered	Offered	Offered
Clothing 361		Offered	Offered	Offered
Fashion and Interior Design 161		Offered	Offered	Offered
Fashion Design Studio 461			Offered	Offered
Introduction to Culinary Arts 161	Offered	Offered	Offered	Offered
Culinary Arts 261: Baking & Pastry	Offered	Offered	Offered	Offered
Culinary Arts 361: Catering & Meal Preparation			Offered	Offered
Senior Foods 471, 472				Offered
FCS Careers 163			Offered	Offered
Psychology for Living 161		Offered	Offered	Offered

CAREER AND LIFE SKILLS

ANTIDISCRIMINATION STATEMENT:

Career and technical education classes and programs are offered regardless of race, color, national origin, sex or disability

APPLIED TECHNOLOGY

ARCHITECTURE STUDIO 163 (ATH163A0)

GRADE: 9,10,11,12 LENGTH: 2 Sem CREDIT: 1.00 GPA: All Subject
Architecture 163 is a beginner studio course that introduces architectural topics to students seeking to discover if they would like to pursue a career in architecture. Project based, the course delves into theories of space, proportion, lighting, and color as a means to enhance designs and models. Board Drafting is introduced as a precursor to the use of Computer Aided Drafting (CAD) for plan making, 3-D modeling, rendering and animation. Architects, styles, structures are studied in a historical and future context.
PREREQUISITE: None

ARCHITECTURE STUDIO 263 (ATH263A0)

GRADE: 10,11,12 LENGTH: 2 Sem CREDIT: 1.00 GPA: All Subject
Architecture 263 is an intermediate studio course for students interested in a career in architecture. Delving deeper into various architectural topics, theories of space, proportion, lighting, color, and flow are studied and applied to designs and compositions. The debate of Form vs. Function will begin to be considered for all completed projects. Use of Computer Aided Drafting (CAD) for plan making and digital modeling will occur. Software for rendering and animation will be introduced. Architects, styles and structures are further studied in a historical and future context. Students at this level will have the opportunity to compete in the NAWIC Architectural Design Competition.
PREREQUISITE: Architectural Drawing 163

ARCHITECTURE STUDIO 363 (ATH363A0)

GRADE: 11,12 LENGTH: 2 Sem CREDIT: 1.00 GPA: All Subject
Architecture 363 is an advanced studio course that studies and applies various architectural topics for students intending to pursue a career in architecture. Theories of design are studied and applied to compositions and projects for aesthetic appeal. Use of computer software for plan making, digital modeling, rendering and animation will occur to complete and enhance designs. Architects, styles and structures are further studied in a historical and future context. Students at this level will have an opportunity to compete in the NAWIC Architectural Design Competition. Portfolios are assembled from previous works for the college application process.
PREREQUISITE: Architectural Drawing 263

ARCHITECTURE STUDIO 463 (ATH463A0)

GRADE: 12 LENGTH: 2 Sem CREDIT: 1.00 GPA: All Subject
Architecture 463 is intended to prepare students for the transition into a design, architectural, or engineering major. Rigorous in nature, college studio courses are competitive and demanding. Knowledge gained in Architectural Drawing 1-3 is applied to projects and used to create appropriate college-level studio work habits and products. Design theories and software application are integrated for complex and in-depth projects. Portfolios are finalized using work from the Architectural Drawing 1-4 classes for the college application process and potential scholarship submission.
PREREQUISITE: Architectural Drawing 363

GAME DESIGN & THEORY 161 (ATI16100)

GRADE: 10,11,12 LENGTH: 1 Sem CREDIT: .50

Game Design and Theory is a beginner course aimed at teaching students the 3-Dimensional practical and conceptual framework of character and scene development for gaming. This course will use the Unreal Engine and Autodesk programs for content development. Concepts such as Lighting, Proportion, Flow, Anatomy, and Geometry will be used to enhance designs. Throughout the semester, students will test and critique one another's creations in a simulated environment. The goal is to educate students on aesthetic considerations (theory), the software user interface (practice), and college and career options (implementation).
PREREQUISITE: None

AUTOMOTIVES 161 (ATA16100)

GRADE: 10,11,12 LENGTH: 1 Sem CREDIT: .50 GPA: All Subject
Automotives 161 is designed for the automobile owner and user who is interested in obtaining a general knowledge of "what's under the hood." The course emphasis is placed on developing understanding of internal combustion engines and the fuel, electrical, lubrication and cooling system as well as how these systems operate and function. (Lab fee: \$5.00).
PREREQUISITE: None

AUTOMOTIVES 261 (ATA26100)

GRADE: 10,11,12 LENGTH: 1 Sem CREDIT: .50 GPA: All Subject
The emphasis in Automotives 261 is engine performance and fuel systems. The student will learn ignition systems, fuel systems, and computerized engine controls. Emphasis will be placed on trouble shooting utilizing advanced diagnostic equipment. (Lab fee: \$5.00).
PREREQUISITE: Automotives 161 and Drivers License

AUTOMOTIVES 262 (ATA26200)

GRADE: 10,11,12 LENGTH: 1 Sem CREDIT: .50 GPA: All Subject
The emphasis in Automotives 262 is power trains, brakes and suspension systems. The student will learn diagnostic and repair procedures as well as basic maintenance for these systems. Technology such as active suspensions, anti-lock brakes, and variable speed transmissions will be explored. (Lab fee: \$5.00).
PREREQUISITE: Automotives 161 and Drivers License

AUTOMOTIVES, VOCATIONAL 361, 362 (ATA36100)

GRADE: 11,12 LENGTH: 1 Sem CREDIT: 0.50 GPA: All Subject
Designed for the student who is interested in the automotive field as a vocation. Includes preventive maintenance, brake system service, steering and suspension service, tune-up diagnostics, cooling system service, computerized engine control diagnostics, fuel system service, and shop management strategies.
PREREQUISITE: Either Automotives 261 or 262

DRAFTING 161 (ATC16100)

GRADE: 9,10,11,12 LENGTH: 1 Sem CREDIT: .50 GPA: All Subject
Drafting presents the fundamental principles, elements and practices common to all branches of mechanical drawing. This course is designed to provide the basic rules in each area. Introduction of computer aided drafting helps to prepare students for future use of the computer in design. Recommended for students entering the field of engineering. (Lab fee: \$5.00).
PREREQUISITE: None

CAD DRAFTING 261 (ATC26100)

GRADE: 9,10,11,12 LENGTH: 1 Sem CREDIT: .50 GPA: All Subject
This course is a preparation for students who plan to enter a field of engineering. Emphasis is placed on the CAD system for students interested in drafting and architecture. (Lab fee: \$5.00).
PREREQUISITE: Drafting 161

CONSTRUCTION SKILLS FOR SERVICE 161 (ATB16100)

GRADE: 10,11,12 LENGTH: 1 Sem CREDIT: .50 GPA: All Subject
Students gain experience in construction, basic repairs and maintenance around the home. Mini units in painting, wallpapering, framing, electrical, plumbing, appliance repair, designs and energy saving ideas are covered using a hands-on approach. Students will be taught the correct safety procedures in using the different tools to accomplish these objectives. During the semester, students will take 1 or 2-day community service field trips where they will put these skills to practical use. (Lab fee: \$10.00). PREREQUISITE: None

METALS 161 (ATM16100)

GRADE: 9,10,11,12 LENGTH: 1 Sem CREDIT: .50 GPA: All Subject
Metals 161 is an introduction to the metal-working process and the tools and materials used. Students put into practice the fundamentals of computer machining and the use of basic machining processes. (Lab fee: \$5.00 to \$15.00). PREREQUISITE: None

METALS 263 (ATM26300)

GRADE: 10,11,12 LENGTH: 2 Sem CREDIT: 1.00 GPA: All Subject
Metals 263 students study shop operations, organization and development. Emphasis is placed on planning, development, computerized machining and design, and the running of C.I.M. (computer integrated machining) cells with the use of robotics to produce a product. (Lab fee: \$5.00 to \$15.00). PREREQUISITE: Metals 161 or equivalent

METALS TECH 163 (ATN16300)

GRADE: 9,10,11,12 LENGTH: 2 Sem CREDIT: 1.00 GPA: All Subject
Course is designed for students to study the wide ranging technologies that are occurring in the modern world. The students will study CNC and CAD (computerized machining and drafting), robotics, lasers and other high tech related material. Recommended for students entering engineering. (Lab fee: \$5.00). PREREQUISITE: None

METALS TECH 263 (26300)

GRADE: 10,11,12 LENGTH: 2 Sem CREDIT: 1.00 GPA: All Subject
Course is designed for students to study the wide ranging technologies that are occurring in the modern world. The students will study CNC and CAD (computerized machining and drafting), robotics, lasers and other high tech related material. Recommended for students entering engineering. (Lab fee: \$5.00). PREREQUISITE: Metals Tech 163 or Metals 161

PLASTICS 161 (ATP16100)

GRADE: 9,10,11,12 LENGTH: 1 Sem CREDIT: .50 GPA: All Subject
Plastics is a hands-on course. In Plastics students learn to work with acrylic plastics by designing and constructing small, useful projects utilizing many different processes such as laminations, bending, engraving, carving and casting. Students learn about processes used in a manufacturing environment. (Lab fee: \$5.00 to \$15.00). PREREQUISITE: None

SMALL ENGINES 161 (ATS16100)

GRADE: 9,10,11,12 LENGTH: 1 Sem CREDIT: .50 GPA: All Subject
This introductory course is a hands on program where students will rebuild an engine and learn how it works. The students will also learn basic maintenance skills to help keep their power equipment running smoothly. The small engine courses must be taken in sequence. This course helps make a smooth transition to either Small Engines Adv. 261 or Automotives 161. (Lab fee: \$5.00 to \$30.00). PREREQUISITE: None

SMALL ENGINES ADV. 261 (ATS26100)

GRADE: 10,11,12 LENGTH: 1 Sem CREDIT: .50 GPA: All Subject
The advanced course is a lab course designed for students to get a maximum hands-on experience with outboard motors, motorcycles, chain saws and other types of small-engine powered equipment. The small engine courses must be taken in sequence. (Lab fee: \$10.00 to \$30.00). PREREQUISITE: Small Engines 161

VOCATIONAL SURVEY 161 (ATS26100)

GRADE: 9,10,11,12 LENGTH: 1 Sem CREDIT: .50 GPA: All Subject
This course offers a survey of vocational topics to introduce students to career opportunities and provide basic information needed to enroll in other elective courses. Topics will include automotives, metals, woodworking, plastics, and basic trades. Students will explore much of today's technologies such as Production, Energy, Transportation, and Communications. A student enrolled in this class will receive an applied arts credit. PREREQUISITE: None

WELDING 161 (AWE16100)

GRADE: 9,10,11,12 LENGTH: 1 Sem CREDIT: .50 GPA: All Subject
The Welding 161 class introduces oxy-acetylene and arc welding, flame cutting and brazing. Each student designs and constructs a welding project. (\$5.00 in lab fees.). PREREQUISITE: None

WELDING 261 (AEW26100)

GRADE: 9,10,11,12 LENGTH: 1 Sem CREDIT: .50 GPA: All Subject
This advanced course introduces students to MIG and TIG welding and advanced welding techniques. Each student designs and constructs a welding project. (Lab fee: \$5.00). PREREQUISITE: Welding 161

INTRODUCTION TO WOODWORKING 161, 162 (ATW16100)

GRADE: 9,10,11,12 LENGTH: 1 Sem CREDIT: .50 GPA: All Subject
Woodworking is recommended for students who want to learn how to operate basic woodworking equipment, learn correct safety procedures and develop an understanding of the characteristics of wood. By constructing projects, each student develops knowledge of gluing, jointery, fasteners, sanding, staining, finishing and craftsmanship. (Lab fee: \$10.00 to \$35.00). PREREQUISITE: None

ADVANCED WOOD MACHINING 261 (ATW26100)

GRADE: 10,11,12 LENGTH: 1 Sem CREDIT: .50 GPA: All Subject
Students will learn to demonstrate advanced machine skills while designing and producing a wood product of their choice or choosing from several offered by the instructor. PREREQUISITE: Intro. To Woodworking. 161

INTRODUCTION TO CABINETRY 262 (AWC26100)

GRADE: 10,11,12 LENGTH: 1 Sem CREDIT: .50 GPA: All Subject
Students will learn basic cabinetry skills by building a project that contains a drawer and/door. Examples would be: TV/VCR cabinet, Deacon's bench, night stand. or similar project of student choice. (Lab fee: \$30.00 to \$60.00). PREREQUISITE: Intro to Woodworking 161 or 162

PRINCIPLES OF APPLIED SCIENCE AND TECHNOLOGY (SCT16300)

GRADE: 11,12 LENGTH: 2 Sem
CREDIT: .50 Applied Technology & .50 Science GPA: All Subject & Academic
A project based course designed to have students learn the science behind a series of hands-on activities. Problem solving and engineering design are emphasized as students work in teams to overcome problems of design, development, production, and testing of a product. Topics are from both applied technology and science: robotics, pneumatics, hydraulics, computer design, computer controlled machining, optics (including laser technology), mechanics, electricity, and magnetism. Students work in design teams and present achievements to the class. A team of staff is selected for this course form science and applied tech. Students completing only one semester will receive .50 credit in applied technology. PREREQUISITE: 1.00 credit in science

BUSINESS EDUCATION

BUSINESS EDUCATION

ACCOUNTING 161 (BTN16100)

GRADE: 10,11,12 LENGTH: 1 Sem CREDIT: .50 GPA: All Subject
Accounting provides training in skills to serve students in the business and accounting world. Students will be trained in the use of journals and reports on both paper documents and on accounting software. The students will be introduced to the principles needed to set up and keep records for a business. Since special attention is given to accounting theory, accounting is an excellent primer for students considering a business major in college.
PREREQUISITE: None

BUSINESS LAW 161 (BLA16100)

GRADE: 10,11,12 LENGTH: 1 Sem CREDIT: .50 GPA: All Subject
Business Law provides an introduction to every important aspect of contemporary law. Students learn to define rights and duties by studying legal concepts and rules. Basic principles of law are emphasized in terms of everyday transactions in personal and business relationships. PREREQUISITE: None

COMPUTER APPLICATIONS 161 (BTA16100)(F)

GRADE: 9,10,11,12 LENGTH: 1 Sem CREDIT: .50 GPA: All Subject
Computer Applications 161 introduces students to the latest technology available. The curriculum is designed to enable students to become computer literate and help them become efficient for future course work in high school and college. The course provides the students the opportunity to become competent in such applications as word processing (Word), database management (Access), spreadsheets (Excel), presentation software (PowerPoint), desktop publishing (Publisher) and design (Photoshop). Students will also be involved in activities that engage the Internet and e-mail. Highly recommended for all students. PREREQUISITE: None

MULTIMEDIA APPLICATIONS (BTA261C0)

GRADE: 9,10,11,12 LENGTH: 1 Sem CREDIT: .50 GPA: All Subject
This course builds on previous skills from Computer Applications 161. Students will create web pages for personal and school use. The design of web sites, graphics & videos are key components of the class. The newest software and techniques will be utilized for instruction. The curriculum is designed for students who have had previous computer experience.
PREREQUISITE: Computer Applications 161

CONSUMER EDUCATION ESL 161 (BCE13100)

GRADE: 12 LENGTH: 1 Sem CREDIT: .50 GPA: All Subject
Consumer Education satisfies the state competency requirement to give students basic knowledge of consumer issues. The areas of learning required by state law include consumer rights and responsibilities, consumer protection, comparison buying, consumer economics, budgeting, saving, investing, credit, taxes and insurance. This section is only offered to students enrolled in our English as a Second Language program. PREREQUISITE: None



CONSUMER EDUCATION G 161 (BCE15100)

GRADE: 12 LENGTH: 1 Sem CREDIT: .50 GPA: All Subject
Consumer Education satisfies the state competency requirement to give students basic knowledge of consumer issues. The areas of learning required by state law include consumer rights and responsibilities, consumer protection, comparison buying, consumer economics, budgeting, saving, investing, credit, taxes and insurance. This course is for those students who would meet with limited success in a traditional consumer education curriculum.
PREREQUISITE: Recommendation of the department

CONSUMER EDUCATION 161 (BCE16100)

GRADE: 12 LENGTH: 1 Sem CREDIT: .50 GPA: All Subject
This course offers a challenging learning opportunity for capable seniors to study and analyze current consumer topics such as economics, taxation, investments, comparison shopping, budgeting, banking, credit, housing, automobiles, insurance, and identity theft. Extensive use of current events will lead into a short budget project. The students will also complete a stock project. This course fulfills the state consumer education requirement.
PREREQUISITE: None

CONSUMER EDUCATION 171 (BCE17100)

GRADE: 12 LENGTH: 1 Sem CREDIT: .50 GPA: All Subject & Academic
This course offers a challenging learning opportunity for capable seniors to study and analyze current consumer topics such as economics, careers, insurance, taxation, investments, comparison shopping, budgeting, banking and credit. Extensive use of current events will be made as a lead-in to short research projects. Students will also be involved with peer teaching activities. This course fulfills the state consumer education requirement.
PREREQUISITE: Approval of Instructional Supervisor

INTRODUCTION TO BUSINESS 161 (BIB16100)

GRADE: 9,10,11,12 LENGTH: 1 Sem CREDIT: 0.5 GPA: All Subject
Introduction to Business exposes students to the basic operations of the business world. This survey course covers business fundamentals such as marketing, finance, and manufacturing as well as their interactions. Students will learn how to analyze a business opportunity, develop a plan and become an entrepreneur. Students will put their business skills to use through the formation of a class corporation and the selling of a chosen product during the semester. PREREQUISITE: None

MANAGEMENT 161 (BMN16100)

GRADE: 10,11,12 LENGTH: 1 Sem CREDIT: .50 GPA: All Subject

Management introduces students to the numerous roles and functions a manager performs: planning, organizing, directing and controlling. Students will study the traits of an effective manager as well as the varying management positions that exist. Students will put their management skills to use running a mock company via computer simulation and through case studies calling for their recommended course of action. PREREQUISITE: None

MARKETING 161 (Sports and Entertainment) (BMK16100)

GRADE: 10,11,12 LENGTH: 1 Sem CREDIT: .50 GPA: All Subject

Marketing with a sports and entertainment emphasis introduces students to this exciting field which includes advertising, consumer research, product development, and selling. Students will be challenged to create new marketing ideas as they analyze current marketing trends. Real life projects allow students to demonstrate their understanding of these areas. This course will examine the impact of marketing in our everyday lives, as well as teach many critical business concepts to ready students for a career in the area of marketing.

PREREQUISITE: None

KEYBOARDING (BRK16100)

GRADE: 9,10,11,12 LENGTH: 1 Sem CREDIT: .50 GPA: All Subject

This course teaches students how to type properly and become efficient using the keyboard. Principles of composing business letters are also taught. The students will also learn many other computer skills to help them become effective and efficient in high school and college. Highly recommended for all students. PREREQUISITE: None

CAREER PLACEMENT PROGRAM 161 (BPL00100 BPL00200)

GRADE: 11,12 LENGTH: 1 Sem CREDIT: .50 GPA: All Subject

This course is a cooperative work-study program designed for junior or senior students wishing to work part-time and receive school credit. Students in the Career Placement Program must have a stated career/work objective, be enrolled in a GBN course related to the objective and be recommended by the related course instructor, Instructional Supervisor, or school counselor.

This program requires on-site training with an approved cooperating employer and evaluations of work performance by a school coordinator each grading period. Students must have reliable transportation to their jobs.

PREREQUISITE: None

**FAMILY AND CONSUMER SCIENCES****INTRODUCTION TO HUMAN GROWTH & DEVELOPMENT (FCD161C0)**

GRADE: 9,10,11,12 LENGTH: 1 Sem CREDIT: .50 GPA: All Subject

This course teaches growth and development from the prenatal stage through the two year old. Topics such as families, role of the parent/caregiver, reproduction, pregnancy, child birth, health and safety, the newborn, the infant, and the toddler are covered. The students will also work in the GBN Preschool as teacher aides. PREREQUISITE: None

EDUCATIONAL FOUNDATIONS: INTRODUCTION TO TEACHING (FCD261C0)

GRADE: 9,10,11,12 LENGTH: 1 Sem CREDIT: .50 GPA: All Subject

In the Educational Foundations course students will learn to master teaching skills in planning, creating, teaching and evaluating all areas of the early childhood curriculum. They will also learn classroom management in relation to discipline techniques. Students work in groups as lead teachers in GBN Preschool. The course will study the growth and development of the preschool age (3-5 years old) child and early childhood education. Students study early childhood theorists and apply theory while working in GBN Preschool. Students find this class to be extremely valuable in college when studying educational psychology and general psychology classes in addition to learning how to apply teaching skills. This is a one semester course that will target all students interested in teaching as a career.

PREREQUISITE: Introduction to Human Growth & Development 161

TEACHING INTERNSHIP & SEMINAR (FCD361C0)

GRADE: 11,12 LENGTH: 1 Sem CREDIT: .50 GPA: All Subject

This course examines the theoretical and practical application of child development theories. The students explore career opportunities by becoming teacher aides in local elementary, junior high and special education centers. Students must be able to make arrangements for transportation to off-campus sites. PREREQUISITE: Educational Foundations 261

CLOTHING 161 (FCC1610)

GRADE: 9,10,11,12 LENGTH: 1 Sem CREDIT: .50 GPA: All Subject

Clothing 161 is recommended for the beginner. Sewing machine operation, pattern selection, layout, cutting, & pressing techniques, fabric & notion coordination, hems, and zipper insertion are stressed. Students take field trips during class to personally coordinate and select materials for chosen projects. Student projects include pillows/pillowcases, pajama wear, tote and zipper bag accessories. Project work is completed during class. Students are introduced to the serger machine. PREREQUISITE: None

CLOTHING 261 (FCC26100)

GRADE: 9,10,11,12 LENGTH: 1 Sem CREDIT: .50 GPA: All Subject

Clothing 261 expands and improves students', sewing techniques, becoming more proficient with serger sewing. Students are encouraged to personalize projects through selection and coordination of materials, as well as, introductory design modification. Personal fit and alteration is stressed.

Embellishing and finer finishing techniques are introduced. Students are eligible to enter their garments in FCCLA apparel competitive events at the local and state levels. PREREQUISITE: Clothing 161 or equivalent

CLOTHING 361 (FCC36100)

GRADE: 10,11,12 LENGTH: 1 Sem CREDIT: .50 GPA: All Subject

Clothing 361 is designed to refine knowledge and skills acquired in previous courses. Students desiring career study in fashion and design or who love to create are strongly encouraged to take this class. Emphasis is placed on streamlining techniques to include a variety of zipper, closure and finishing skills, as well as, more design and alteration modification. Students complete project work in class and are encouraged to enhance their skills outside of the classroom. Student choice steers project work and class field trips permit teacher and student interaction at all levels of project coordination. Apparel recycling, redesigning and personal project design is encouraged. Students are eligible to compete and proficiency towards FCCLA competition at local and state levels. PREREQUISITE: Clothing 261 or equivalent

FASHION DESIGN STUDIO 461 (FCC46100)

GRADE: 10,11,12 LENGTH: 1 Sem CREDIT: .50 GPA: All Subject
 Students who have completed course work in Clothing 161, 261 or 361 may continue advanced study in that area by enrolling in Fashion Design Studio. Students complete a combination of class and independent work.
 PREREQUISITE: Clothing class and department recommendation

FASHION & INTERIOR DESIGN 161 (FCC16700)

GRADE: 10,11,12 LENGTH: 1 Sem CREDIT: .50 GPA: All Subject
 This course is for students who are interested in the fashion and/or interior design fields. Common elements between the areas will be emphasized: design elements and principles, color theory, textile coordination, current trends, visual displays, and presentations by career professionals. A working portfolio of activities and projects is developed during the course. Students also experience client profile simulations in fashion design and floor plan evaluation. Opportunities to attend and/or participate in fashion exhibitions, competitions, and tours are course highlights. PREREQUISITE: None

INTRODUCTION TO CULINARY ARTS 161 (FCF161F0/FCF162F0)**CULINARY ARTS 261: BAKING & PASTRY (FCF261F0/FCF262F0)****CULINARY ARTS 361: CATERING & MEAL PREPARATION (FCF361F0/FCF362F0)**

GRADE: 9,10,11,12 LENGTH: 1 Sem CREDIT: .50 GPA: All Subject
 The Culinary Arts Program provides information and experiences for students wishing to improve their knowledge of nutrition, food-handling techniques, meal management, menu planning, hospitality, and the purchasing, preparation, and serving of foods.

Course content in Baking and Pastry 261 includes the study of cake decorating and baking of a variety of desserts. Plate decorating and final food presentation are stressed. Food industry occupations are reviewed.

Catering and Meal Preparation 361 is designed for students interested in advanced food techniques and gourmet cookery. Opportunities for experiences in quantity food production and service are provided.

PREREQUISITE for 161: None; for 261: Foods & Nutrition 161; for 361: Foods & Nutrition 261 with department recommendation

SENIOR FOODS (FCF16500 FCF 16600)

GRADE: 12 LENGTH: 1 Sem CREDIT: 1.00 GPA: All Subject
 Senior Foods will help fulfill several State of Illinois Education Standards. These may include such standards as solving problems, working with others, communicating orally with others on the same maturity level, and clarifying purposes and goals. The course is designed for any senior who has not previously taken a Foods course offered in the department.

FCS CAREERS CLASS 163 (FCH163C0)**FCS CAREERS WORK 163 (FCH583C0)**

GRADE: 11,12 LENGTH: 2 Sem CREDIT: 1.00 Class 1.00 Work
 GPA: All Subject

FCS CAREERS is a Capstone Cooperative Work-Study Educational Program. Instruction is geared to the individual's career interest in the areas of interior design, culinary arts, clothing, fashion or education. Initial emphasis is placed on securing employment and curricular momentum moves the students through workplace skills. Students develop individualized projects related to their interest areas, as well as, implement a self-directed service project. Students are provided opportunities to participate and attend leadership conferences and competitions at local, state, and national levels.
 PREREQUISITE: Completion of or concurrent enrollment in two course levels of one area of family and consumer sciences (with the exception of fashion students who need only one course), the consent of program coordinator and concurrent enrollment in FCS Careers Cooperative Education Work 163

PSYCHOLOGY FOR LIVING 161 (FCP16100)

GRADE: 11, 12 LENGTH: 1 Sem CREDIT: .50 GPA: All Subject
 Psychology for Living discusses today's problems of interpersonal and family relationships. The class focuses on teen issues that students may face currently or as they head to college. Interactive discussions feature guest speakers, literature, and films that revolve around teen issues including: AIDS, sexually transmitted infections, depression and suicide, death and grief, eating disorders, and drugs and alcohol. PREREQUISITE: None



ENGLISH Core Courses

SEQUENCE	FRESHMAN	SOPHOMORE	JUNIOR	SENIOR
Team	English GT 163	English GT 263	English GT 363	English 463: GT Literature & Composition
Regular	English 163	English 263	English 363 American Studies: English 363	English 463: Seminar Literature & Composition English 463: Literature & Composition - Exploring Self, Society & Media English 463: Humanities English 463: Contemporary Social Themes
Honors	English 173	English 273	English 373	English 483: AP Literature English 483: AP Language & Composition English 473: Honors Literature & College Writing English 473: Honors Humanities English 473: Honors Contemporary Social Themes
Academy	English 193	English 293	English 393	English 493
ESL 163	Offered	Offered	Offered	Offered
ESL 263	Offered	Offered	Offered	Offered
ESL 363		Offered	Offered	Offered
ESL-Reading/Writing	Offered	Offered	Offered	Offered

Skill Support Options

SEQUENCE	FRESHMAN	SOPHOMORE	JUNIOR	SENIOR
Reading Skill Development 163	Offered			
Reading Skill Development 263			Offered	
Foundations of Writing	Offered		Offered	



ENGLISH

ENGLISH GT 163 (ENG14300)

GRADE: 9 **LENGTH:** 2 Sem **CREDIT:** 1.00 **GPA:** All Subject & Academic
Freshman Team English GT 163 combines English and World Civilization topics using a thematic, project-based approach in a team-teaching structure. Instructional strategies employed in the Team classroom include collaborative learning, oral presentations, and process writing. Students concentrate on study strategies, critical thinking, group interaction, and basic skill development. Additionally, students learn how to use technologies to enhance their learning. **PREREQUISITE:** Placement recommendation by eighth grade language arts teacher and GBN English Department.

ENGLISH 163 (ENG16300)

GRADE: 9 **LENGTH:** 2 Sem **CREDIT:** 1.00 **GPA:** All Subject & Academic
Freshman English 163 is organized around two concepts: critical thinking and identity. Through the study of a variety of literary works and genres, students confront questions about how we learn, about individual differences in learning, and about the cultural sources of learning. Students are challenged to become independent readers who can distinguish between literal and figurative language and who understand the formal structures of literary language. Critical thinking tasks focus on the ability to support assertions about a text with specific evidence from the text. Students are expected to master standard English usage and to use writing and discussion for exploring problems, clarifying understanding, and demonstrating both personal insight and content mastery. **PREREQUISITE:** Placement recommendation by eighth grade language arts teacher and GBN English Department.

ENGLISH 173 (ENG17300)

GRADE: 9 **LENGTH:** 2 Sem **CREDIT:** 1.00 **GPA:** All Subject & Academic
Freshman Honors English 173 is organized around two concepts: critical thinking and identity. Through the study of a variety of literary works and genres, students will confront questions about how we learn, about individual differences in learning, and about the cultural sources of learning. Students are challenged to develop reading skills for literary interpretation and critical thinking skills for problem solving. They will use writing and discussion to explore new ideas and complex problems, to clarify their own understanding, and to demonstrate for themselves and others their paths of reasoning. Honors students are expected to demonstrate language talent, high motivation, and authentic curiosity. Because many texts for this course are written well above grade level, enrollment in this course requires that students have already developed high level independent reading skills. **PREREQUISITE:** Placement recommendation by eighth grade language arts teacher and GBN English Department.

ENGLISH GT 263 (ENG24300)

GRADE: 10 **LENGTH:** 2 Sem **CREDIT:** 1.00 **GPA:** All Subject & Academic
Sophomore Team English GT 263 combines English and Social Studies instruction. Students focus on English skills, including research, oral presentations, listening, independent reading, critical thinking and process writing, while pursuing social studies content organized around basic legal concepts: the criminal process, the jury system, selected Supreme Court landmark cases, personal rights and responsibilities. The project-based approach, team-teaching structure, and interactive instructional strategies introduced in Freshman Team are continued in the Sophomore Team experience. **PREREQUISITE:** Placement recommendation by ninth grade Team teachers.

ENGLISH 263 (ENG26300)

GRADE: 10 **LENGTH:** 2 Sem **CREDIT:** 1.00 **GPA:** All Subject & Academic
Sophomore English 263 builds on skills and content mastery attained in English 163. Students' work in achieving mastery of standard English usage continues as they learn more about the complexities of language and the distinction between fact and inference. Students will pursue formal study of presentation strategies and public speaking. They will continue frequent class discussion, the basic strategy for building confidence in expression. **PREREQUISITE:** English 163 or equivalent with teacher recommendation and Instructional Supervisor approval.

ENGLISH 273 (ENG27300)

GRADE: 10 **LENGTH:** 2 Sem **CREDIT:** 1.00 **GPA:** All Subject & Academic
Sophomore Honors English 273 builds on skills and content mastery attained in English 173. Students continue to work collaboratively in interpreting literary works. Critical thinking challenges require students to identify and question assumptions and to examine alternative perspectives as they are raised in works of literature and in response to works of literature. Students both write to learn and to show learning. In addition to daily discussion for understanding, students practice formal presentation and speech skills. Because a genuine honors experience depends upon the interaction of highly motivated and demonstrably able students, enrollment in this course requires evidence of independence, enthusiasm, and follow-through in having met the challenges of English 173. Students with lower than a "B" average in English 173 should not expect to continue in English 273. **PREREQUISITE:** English 173 or equivalent with teacher recommendation and Instructional Supervisor approval.

ENGLISH GT 363 (ENG34300)

GRADE: 11 LENGTH: 2 Sem CREDIT: 1.00 GPA: All Subject & Academic
 Junior Team English GT 363 combines the study of American history and American literature. The literature, including short stories, poems, short novels, and non-fiction, illustrates and extends the history content and concepts introduced in the course. The course emphasis, however, is on skill building rather than content coverage. Thus students learn collaborative work strategies through cooperative research projects on topics including Native Americans, Presidential crises, and Westward Expansion. Students extend their writing skills by maintaining portfolios which are assessed and updated in one-on-one conferences throughout the year. The project-based approach, team-teaching structure, and interactive instructional strategies introduced in Sophomore Team are continued in the Junior Team experience.
 PREREQUISITE: Placement recommendation by tenth grade Team teachers.

ENGLISH 363 (ENG36300)

GRADE: 11 LENGTH: 2 Sem CREDIT: 1.00 GPA: All Subject & Academic
 Junior English 363 explores American culture, ideas, and identity. Through a study of American literary works, students confront questions about who we are as a people, what values define us, and what historical experiences have shaped us. The critical thinking focus is on how context shapes perspective and on the need then to test personal, national, and historical assumptions against alternative experiences and perspectives. Reading and writing serve dual purposes: personal reflection and mastery of analytical response. Students complete both personal and expository writing as well as a formal research paper. PREREQUISITE: English 263 or equivalent with teacher recommendation and Instructional Supervisor approval.

AMERICAN STUDIES: ENGLISH 363 (ENG363A0)

GRADE: 11 LENGTH: 2 Sem CREDIT: 1.00 GPA: All Subject & Academic
 American Studies is an interdisciplinary option for regular level juniors to fulfill their English and U.S. History requirements. The American Studies curriculum and planning are integrated, capitalizing on the relationship among American history, culture, literature, art, and music. The course has a thematic framework and a chronological structure. Each section of American Studies is composed of a 90-minute block for English and a coordinating block for U.S. History. That is, both sections will be made up of a single group of students. The English/history teacher team will coordinate daily instruction. Scheduling will make possible shared large group presentations. PREREQUISITE: English 263 or equivalent with teacher recommendation and Instructional Supervisor approval.

ENGLISH 373 (ENG37300)

GRADE: 11 LENGTH: 2 Sem CREDIT: 1.00 GPA: All Subject & Academic
 Junior Honors English 373 is devoted to an exploration of American culture, ideas, and identity. Through a study of American literary works, students confront questions about who we are as a people, what values define us, and what historical experiences have shaped us. Reading and critical thinking focuses on how context shapes perspective and on the need then to test personal, national, and historical assumptions against alternative experiences and perspectives. Students complete both personal and expository writing as well as a formal research paper. Because a genuine honors experience depends upon the interaction of highly motivated and demonstrably able students, enrollment in this course requires evidence of independence, enthusiasm, and follow-through in having met the challenges of English 273. Students with lower than a "B" average in English 273 should not expect to continue in English 373. PREREQUISITE: English 273 or equivalent with teacher recommendation and Instructional Supervisor approval.

ENGLISH 463: GT LITERATURE & COMPOSITION (ENW153R0)

GRADE: 12 LENGTH: 1 Sem CREDIT: 1.00 GPA: All Subject & Academic
 English Seminar GT 463 is college preparatory English for students who have completed English 363 GT. Reading instruction focuses on skill development while exposing students to a variety of texts and tasks that address four concept clusters: truth, trust, and certainty; self, others, and responsibility; history, family, and legacy; and time, imagination, and the future. Writing instruction focuses on mastery of standard English usage through short, exploratory writings and longer, fully developed essays. In preparation for college, students address study skills and habits of mind to support successful reading, writing, speaking, listening, viewing, and researching.
 PREREQUISITE: Teacher recommendation

ENGLISH 463: SEMINAR LITERATURE & COMPOSITION (ENW163R0)

GRADE: 12 LENGTH: 2 Sem CREDIT: 1.00 GPA: All Subject & Academic
 English Seminar 463 is college preparatory English for students who have completed English 363. Reading instruction focuses on analytical strategies while exposing students to texts from the U.S. and around the world. The approach to literature will include background study of contemporary social issues raised in the literature. Students will continue to hone their active reading skills. Writing instruction expands and broadens students' ability to write narrative and descriptive essays as well as exposition and argument.
 PREREQUISITE: Teacher recommendation

ENGLISH 463: LITERATURE & COMPOSITION - EXPLORING SELF, SOCIETY & MEDIA (ENW263R0)

GRADE: 12 LENGTH: 2 Sem CREDIT: 1.00 GPA: All Subject & Academic
 English 463 is college preparatory English for students who have completed English 363. This course focuses on how our various cultural media (print and visual, fiction and non-fiction) serves the relationship between the individual and society. Special attention is paid to how our media influences our choices, and so students explore how media is a cultural force that persuades us to accept social mores and values, helps us resist thoughtless acceptance, and inspires us to create new visions of what our world can be. Students develop their critical thinking and analytical skills as they read, view, discuss, and write. PREREQUISITE: Teacher recommendation

ENGLISH 473: HONORS LITERATURE & COLLEGE WRITING (ENW273R0)

GRADE: 12 LENGTH: 2 Sem CREDIT: 1.00 GPA: All Subject & Academic
 English 473 explores connections among literary and cinematic texts, both fictional and non-fictional, contemporary and classic, from the United States and around the world. Reading instruction focuses on analytical strategies and rhetorical techniques while exposing students to texts and tasks that address four concept clusters: truth, trust, and certainty; self, others, and responsibility; history, family, and legacy; and time, imagination, and the future. Writing instruction focuses on rhetorical strategies and modes; writing assignments, varied in form and length, are both personal and text-based. Because a genuine honors experience depends upon the interaction of highly motivated and demonstrably able students, enrollment in this course requires evidence of independence, enthusiasm, and follow-through as demonstrated in English 373. PREREQUISITE: Successful completion of English 373 and teacher recommendation



ENGLISH 463: HUMANITIES (ENH16300)

GRADE: 12 LENGTH: 2 Sem CREDIT: 1.00 GPA: All Subject & Academic Humanities 463 seeks to foster an understanding of and respect for diverse human perspectives while instilling in students a sense of responsibility for global issues. As conflicts arise and resources become scarce, how can we learn to work with others to solve the challenges of the 21st century? Through a critical study of contemporary global literature, film, and art, students learn to ask questions from a human rights perspective and see themselves as part of a larger community. The course design encourages students to express their understanding in both traditional and alternative modes; in addition to writing papers and taking quizzes and tests, students create a sketchbook in which they record their responses to print, visual and audio texts by drawing and writing. Field trips are an integral part of the course: students will visit museums, cultural institutions and exhibits, as well as attend plays, concerts, speeches and other events. In preparation for college, students continue to hone study skills and habits of mind to support successful reading, writing, speaking, listening, viewing, and researching. PREREQUISITE: Successful completion of English 363 and teacher recommendation

ENGLISH 473: HONORS HUMANITIES (ENH17300)

GRADE: 12 LENGTH: 2 Sem CREDIT: 1.00 GPA: All Subject & Academic Humanities 473 seeks to foster an understanding of and respect for diverse human perspectives while instilling in students a sense of responsibility for global issues. As conflicts arise and resources become scarce, how can we learn to work with others to solve the challenges of the 21st century? Through a critical study of contemporary global literature, film, and art, students learn to ask questions from a human rights perspective and see themselves as part of a larger community. The course design encourages students to express their understanding in both traditional and alternative modes; in addition to writing papers and taking quizzes and tests, students create a sketchbook in which they record their responses to print, visual and audio texts by drawing and writing. Field trips are an integral part of the course; students will visit museums, cultural institutions and exhibits, as well as attend plays, concerts, speeches and other events. In preparation for college, students continue to hone both literacy skills and habits of mind, and must be prepared for intellectual tasks which require higher-level critical thinking skills. Because a genuine honors experience depends upon the interaction of highly motivated and demonstrably able students, enrollment in this course requires evidence of independence, enthusiasm, and follow-through as demonstrated in English 373. PREREQUISITE: Successful completion of English 373 and teacher recommendation

ENGLISH 463: CONTEMPORARY SOCIAL THEMES (ENL16300)**ENGLISH 473: HONORS CONTEMPORARY SOCIAL THEMES (ENL17300)**

GRADE: 12 LENGTH: 2 Sem CREDIT: 1.00 GPA: All Subject & Academic Contemporary Social Themes combines English, History, and Sociology as we consider the themes of consciousness, power, perspective, and activism. A major goal of the course is to illustrate the complexity of social issues by examining them from different perspectives. All of the learning and exploration leads up to the second semester Community Action Project, where students create and implement plans for action based on problems they have identified throughout the year. Students should be prepared to spend time outside of class working on this project. This class utilizes the reading of nonfiction works, novels, short stories, case studies, poetry, and film, while relying heavily on group work and class discussion. Students who take the course for honors credit are expected to complete additional readings and are evaluated using different criteria (for writing and discussion). PREREQUISITE: English 363 for regular credit; English 373 or equivalent with teacher recommendation and Instructional Supervisor approval for honors credit. Enrollment in this course may be subject to a lottery.

ENGLISH 483: AP LANGUAGE & COMPOSITION (ENW28300)

GRADE: 12 LENGTH: 2 Sem CREDIT: 1.00 GPA: All Subject & Academic AP Language 483 & Composition explores connections among literary and cinematic texts both fictional and non-fictional, both contemporary and classic, from both the United States and around the world. Reading instruction focuses on analytical strategies and rhetorical techniques while exposing students to texts and tasks that address four concept clusters: truth, trust, and certainty; self, others, and responsibility; history, family, and legacy; and time, imagination, and the future. Writing instruction focuses on rhetorical strategies and modes; writing assignments, varied in form and length, are both personal and text-based. During the second semester, students in this course hone both literacy skills and habits of mind in preparation for the Advanced Placement English Examination in Language and Composition. Board of Education policy requires that students register for and take the Advanced Placement examination in order to receive AP credit for the course. PREREQUISITE: Successful completion of English 373 and teacher recommendation

ENGLISH 483: AP LITERATURE (ENG48300)

GRADE: 12 LENGTH: 2 Sem CREDIT: 1.00 GPA: All Subject & Academic AP Literature 483 emphasizes the development of literacy skills and habits of mind for independent literary analysis and interpretation. Reading instruction focuses on representative selections from the College Board's list of recommended texts; students must, therefore, be willing and able to read a substantial number of challenging novels, plays, and poems. Because a genuine Advanced Placement experience depends upon the interaction of highly motivated and demonstrably able students, enrollment in this course requires evidence of independence, enthusiasm, and follow-through as demonstrated in English 373. Board of Education policy requires that students register for and take the Advanced Placement examination in order to receive AP credit for the course. PREREQUISITE: Successful completion of English 373 and teacher recommendation

GLENBROOK ACADEMY 193 GRADE: 9 (ENG19300)

GLENBROOK ACADEMY 293 GRADE: 10 (ENG29300)

GLENBROOK ACADEMY 393 GRADE: 11 (ENG39300)

GLENBROOK ACADEMY 493 GRADE: 12 (ENG49300)

LENGTH: 2 Sem CREDIT: 1.00 GPA: All Subject & Academic Academy English is an integral element of the overall Academy program. This interdisciplinary program emphasizes the interrelatedness of knowledge. Students study works of great literature toward the larger aim of understanding the history, values and beliefs of various cultures. Reading and writing skills are taught as pieces of critical thinking. Students have many opportunities for independent work, completing creative projects or research experiences. The concepts of culture and global awareness are the topics which organize Academy study, an educational experience designed for the motivated and capable student. PREREQUISITE: Original placement is by selection process at the end of eighth grade; continued enrollment is dependent upon subsequent successful completion of preceding course.

ESL 163 (ESL16300)

GRADE: 9,10,11,12 LENGTH: 2 Sem CREDIT: 1.00

GPA: All Subject & Academic

Non-native speakers of English with minimal fluency are provided with English language instruction and support for content area courses. During the course of this instruction, students develop their understanding of written and spoken English. Initially, the goal is to provide students with language survival skills. As the course progresses, the student comprehends both written and spoken English at increasingly higher levels of difficulty. The ELL experience provides a means by which non-native speakers may make the transition into regular English classes and other classes in which English fluency is necessary. Placement subject to recommendation of the ELL Coordinator.



ESL 263 (ESL26300)

GRADE: 9,10,11,12 LENGTH: 2 Sem CREDIT: 1.00
GPA: All Subject & Academic

This intermediate course for English language learners builds on basic skills to further develop proficiency in English. Progress in listening, speaking, reading and writing is promoted as students continue to work toward the goals of communicative competence in English and expanded participation in mainstream curricular offerings. Placement subject to recommendation of the ELL Coordinator.

ESL 363 (ESL36300)

GRADE: 10,11,12 LENGTH: 2 Sem CREDIT: 1.00
GPA: All Subject & Academic

An advanced course for students who do not speak English as their native language, this class provides a “bridge” between the ELL program and mainstream English classes. Reading and writing activities focus on a variety of literary works, and activities reinforce those skills that are most challenging to English language learners. Placement subject to recommendation of the ELL Coordinator.

ESL READING/WRITING (ESR16300)

GRADE: 9,10,11,12 LENGTH: 2 Sem CREDIT: 1.00
GPA: All Subject & Academic

ESL Reading/Writing provides additional reinforcement of skills for ESL students. While listening and speaking skills are involved, there is particular emphasis on literacy development in English. Placement subject to recommendation of the ELL Coordinator.

FOUNDATIONS OF WRITING (ENR14100)

GRADE: 9,10 LENGTH: 1 Sem CREDIT: .50 GPA: All Subject
Foundations of Writing is a support course offered to students in need of writing enrichment. Lessons provide instruction in the core areas of writing development: Focus, Organization, Fluency, Conventions, and Voice. In this workshop environment, students will develop their academic writing skills through a variety of writing projects. In addition, students work on critical thinking skills and writing strategies using both in-class assignments and writing assignments from other subject areas. For this course, students receive .50 of elective credit and all subject rank. PREREQUISITE: Placement recommendation by eighth or ninth grade language arts/English teacher.

READING SKILL DEVELOPMENT 163 (ENR16300)

GRADE: 9 LENGTH: 2 Sem CREDIT: 1.00 GPA: All Subject & Academic
Reading Skill Development (RSD) is a support program offered to students in need of reading enrichment. Lessons provide instruction in vocabulary and comprehension strategies to be applied in all disciplines. Specifically, RSD teachers give reading support for the coursework in English 163 and History of World Civilization. Students work with both a teacher and instructional assistant to complete homework assignments and practice successful study habits. Prior to semester exams, RSD teachers also model test-taking strategies. Incoming freshman with a discrepancy between cognitive ability and test scores in vocabulary and/or comprehension would benefit from taking Reading Skill Development. PREREQUISITE: Placement recommendation by eighth grade language arts teachers, the Instructional Supervisor of English, and the GBN reading specialist.

READING SKILL DEVELOPMENT 263 (ENR26300)

GRADE: 10,11 LENGTH: 2 Sem CREDIT: 1.00
GPA: All Subject & Academic
Reading Skill Development (RSD) is a support program offered to students in need of reading enrichment. Lessons provide instruction in vocabulary and comprehension strategies to be applied in all disciplines. RSD 263 teachers give additional support to students preparing for ACT testing and junior year research projects. Students work with both a teacher and instructional assistant to complete homework assignments and practice successful study habits. Prior to semester exams, RSD teachers also model test-taking strategies. PREREQUISITE: Placement recommendation by teacher, Instructional Supervisor of English, and the GBN reading specialist.

NEWSPAPER STAFF (ETJ10300, ETJ20300)

GRADE: 10,11,12 LENGTH: 2 Sem
CREDIT: 1.00 GPA: All Subject
All work on the TORCH is completed in this course. Newspaper Staff offers on-the-job training for staff reporters and editors of the student newspaper. Enrollment is limited and final selections are made by the English Department Publications Committee. Continued enrollment for subsequent years depends upon instructor review. This course may not be used toward the four-year English graduation requirement. PREREQUISITE: English 163/173 and teacher recommendation. See Publication Staff Selection Process.

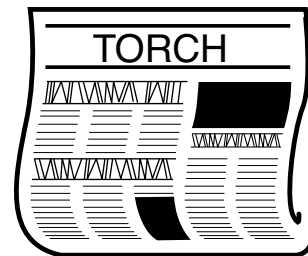

INTRODUCTION TO JOURNALISM (ETJ06100)

GRADE: 9,10,11,12 LENGTH: 1 Sem CREDIT: .50 GPA: All Subject
Introduction to Journalism is a one semester class that provides students with the opportunity to explore the field of journalism. This course is intended for students who are interested in participation in publication classes or clubs offered at GBN, or for those students who may be interested in a career in journalism. This class provides students with instruction on the basics of newswriting, interviewing techniques, newspaper design and layout, legal issues related to journalism, ethical considerations confronting the media, and computer technology utilized in the production of publications. PREREQUISITE: Concurrent enrollment in English.

CREATIVE WRITING 161 (ENW14100/ENW14200)

GRADE: 10,11,12 LENGTH: 1 Sem CREDIT: .50
GPA: All Subject & Academic
Creative Writing 161 is designed for selected sophomore, junior and senior students who have maintained writing grade averages of “B” or above or who have revealed creativity in writing. The course consists of writing projects which lead to final products of poetry, drama, and short fiction. Stress is placed upon imaginative use of language through individual writing exercises, group tasks, and journal writing. Students are provided the opportunity to revise their works based on individualized teacher response and critique. PREREQUISITE: English 163 or 173 and teacher recommendation, concurrent enrollment in English.

PUBLICATION STAFF SELECTION PROCESS

GBN Student Publications

Euphonium: 9th and 10th graders who wish to work on this publication, the GBN literary magazine for 9th and 10th grade students, should attend the opening-of-the-year meeting in September. *Euphonium* is entirely extracurricular; all students who apply are reviewed by our GBN Publications Committee. The advisor will work with the student staff to establish an editorial process and review that process with the committee. Once the editorial process is established, students make all selections of works for publication. Students may join the staff up to the end of the first nine weeks, but must agree to attend a minimum of 65% of meetings. In the spring, the staff completes a publication of student literary work and art and awards cash prizes for outstanding essays, poems, short stories, and art works.

Helicon: 11th and 12th graders who wish to work on this publication, the GBN literary magazine for 11th and 12th grade students, should attend the opening-of-the-year meeting in September. *Helicon* is entirely extracurricular; all students who apply are reviewed by our GBN Publications Committee. The advisor will work with the student staff to establish an editorial process and review that process with the committee. Once the editorial process is established, students make all selections of works for publication. Students may join the staff up to the end of the first nine weeks, but must agree to attend a minimum of 65% of meetings. In the spring, the staff completes a publication of student literary work and art and awards cash prizes for outstanding essays, poems, short stories, and art works.

Torch and Laconian: Enrollment in these production classes is by application and final selections of students are made by the GBN Publications Committee. Participation in these classes requires a significant out-of-school commitment and results in publication of a minimum of seven issues of the paper for *Torch* and the annual yearbook for *Laconian*.

S.C.H.O.O.L. Magazine: Students Collectively Harnessing Outlets Of Literature is a magazine dedicated to serving as a forum for free speech and expression, both written and visual. Participation is extracurricular and entirely voluntary. All students who wish to contribute and participate are welcome. Regular meetings are announced; to participate, students need only to attend. Participants make selections and create the magazine by a consensus process without designated editorial positions. It is the policy of *S.C.H.O.O.L. Magazine* to reject submissions attacking specific individuals within our community but otherwise to support the principle of free speech.

Application Process

Publications Committee Members

Euphonium Advisor

Helicon Advisor

Laconian Advisor

S.C.H.O.O.L. Advisor

Torch Advisor

ARC Coordinators

Application Process for *Torch* and *Laconian*

1. At the beginning of second semester, students complete applications for *Torch* or *Laconian* and return completed applications to the appropriate advisor.
2. Advisors review application forms and rank candidates, gathering supporting evidence from teacher references.
3. Publications Committee meets prior to due date for registration to review rankings and make final selections.
4. Applicants are informed of outcome.

Application Process for *Euphonium* and *Helicon*

Participation in the two literary magazines is not competitive. Students are welcomed on the basis of interest and willingness to work. Each advisor will review the list of staff members and the magazine's editorial process with the GBN Publications Committee.

Candidate Criteria for *Helicon* and *Euphonium*

Personal Qualities	Special Skills	Other
Evidence of responsibility and follow through.	Word Processing	All students with an interest in the arts and creative writing are welcome.
Maturity	InDesign, Photoshop	Number of outside-of-school commitments noted; can the student reasonably expect to add this activity and meet its expectations? Willingness to meet commitment to attend required number of meetings.
Independence (self-starter)	Organizational Skills	Interest in literary magazines.
Ability to take and give constructive criticism.	Layout Skills	Students who read many different kinds of literary works: essays, poetry, novels, belle letters, etc., bring an informed perspective to this endeavor.
Ability and willingness to participate in a consensus building process.	Artistic Skills	
Ability to follow directions and pay attention to details.	Literary Knowledge	
Ability to self-advocate.	Strong Basic Writing Skills	
Ability to seek creative perspectives and solutions to problems.	Cartooning Skills	
	Team Building Skills	

Candidate Criteria for *Torch* and *Laconian*

Personal Qualities	Special Skills	Other
Evidence of responsibility and follow through.	Word Processing	Academic Ability: Participation includes all academic levels. "B" average expected.
Maturity	InDesign, Photoshop	Number of outside-of-school commitments noted; can the student reasonably expect to add this activity and meet its expectations? Willingness to sign commitment to attend required number of press nights.
Independence (self-starter)	Business Skills	Interest in journalism
Ability to take and give constructive criticism.	Layout Skills	Two teacher references
Ability and willingness to participate in a consensus building process.	Artistic Skills	
Ability to follow directions and pay attention to details.	Sports Expertise	
Ability to self-advocate.	Interest in a variety of journalism writing areas: features, sports, news, opinion, humor, etc.	
Ability to seek creative perspectives and solutions to problems.	Strong Basic Writing Skills	
	Organizational Skills	
	Team Building Skills	

FINE ARTS

ART COURSES	FRESHMAN	SOPHOMORE	JUNIOR	SENIOR
Art Studio	Offered	Offered	Offered	Offered
Drawing/Design 161	Offered	Offered	Offered	Offered
Drawing/Design 261		Offered	Offered	Offered
Drawing/Design 361		Offered	Offered	Offered
Ceramics 161*	Offered	Offered	Offered	Offered
Ceramics 261		Offered	Offered	Offered
Ceramics 361		Offered	Offered	Offered
Ceramics 461			Offered	Offered
Computer Art 161*	Offered	Offered	Offered	Offered
Graphic Design 161*	Offered	Offered	Offered	Offered
Graphic Design 261		Offered	Offered	Offered
Graphic Design 361		Offered	Offered	Offered
Graphic Design 461			Offered	Offered
Painting 161*	Offered	Offered	Offered	Offered
Painting 261		Offered	Offered	Offered
Photography 161*	Offered	Offered	Offered	Offered
Photography 261		Offered	Offered	Offered
Photography 361		Offered	Offered	Offered
Photography 461			Offered	Offered
AP Studio Art 183			Offered	Offered
Honors Art 173			Offered	Offered

RADIO/TV COURSES	FRESHMAN	SOPHOMORE	JUNIOR	SENIOR
Introduction to Broadcasting 161	Offered	Offered	Offered	Offered
Radio Broadcasting 161	Offered/Sem 2	Offered	Offered	Offered
Radio Broadcasting 261		Offered	Offered	Offered
Radio Broadcasting 361		Offered	Offered	Offered
Radio Broadcasting 461		Offered	Offered	Offered
Sportscasting 161	Offered/Sem 2	Offered	Offered	Offered
Sportscasting 261		Offered	Offered	Offered
Sportscasting 361		Offered	Offered	Offered
Sportscasting 461		Offered	Offered	Offered
Television Broadcasting 161	Offered/Sem 2	Offered	Offered	Offered
Television Broadcasting 261		Offered	Offered	Offered
Television Broadcasting 361		Offered	Offered	Offered
Television Broadcasting 461		Offered	Offered	Offered

**Prerequisite: Art Studio or recommendation of the department*

FINE ARTS *(continued)*

MUSIC COURSES	FRESHMAN	SOPHOMORE	JUNIOR	SENIOR
BAND:				
Varsity	Offered			
Symphonic		Offered	Offered	Offered
Symphonic Wind Ensemble		Offered	Offered	Offered
Jazz Ensemble	Offered	Offered	Offered	Offered
Jazz Lab	Offered	Offered	Offered	Offered
CHOIR:				
Treble	Offered	Offered	Offered	Offered
Spartan	Offered	Offered	Offered	Offered
Varsity		Offered	Offered	Offered
Cecilian Singers		Offered	Offered	Offered
Chorale		Offered	Offered	Offered
ORCHESTRA:				
String Ensemble	Offered			
Symphonic		Offered	Offered	Offered
MUSIC/GENERAL:				
Electronic Music 161	Offered	Offered	Offered	Offered
Electronic Music 261	Offered/Sem 2	Offered	Offered	Offered
Intro to Music Theory & Composition	Offered/Sem 2	Offered	Offered	Offered
Advanced Placement Music Theory 183		Offered	Offered	Offered
Guitar 161	Offered	Offered	Offered	Offered
THEATRE/DRAMA COURSES	FRESHMAN	SOPHOMORE	JUNIOR	SENIOR
Advanced Acting/Directing 161		Offered	Offered	Offered
Advanced Improvisation 161		Offered	Offered	Offered
Drama 161		Offered	Offered	Offered
Drama 261	Offered	Offered	Offered	Offered
Performance Skills 161	Offered			

FINE ARTS

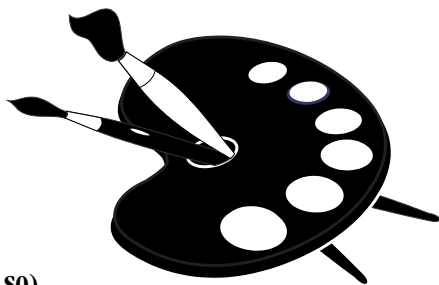

ART STUDIO 161 (AAF161S0)

GRADE: 9,10,11,12 LENGTH: 1 Sem CREDIT: .50 GPA: All Subject
Students are exposed to a variety of projects emphasizing hands-on studio experiences in Ceramics, Photography, Painting, Drawing and 2-D Design. Students will experiment with a variety of media to develop their artist's skills and creative process. No previous art experience is necessary. This course is a prerequisite for all courses in the Art Department. (Lab fee: \$25.00).
PREREQUISITE: None

DRAWING/DESIGN 161 (ADD16100 ADD16200)

GRADE: 9,10,11,12 LENGTH: 1 Sem CREDIT: .50 GPA: All Subject
This course offers students an opportunity to work with a variety of media such as colored pencil, marker, charcoal, pastels, and paintsticks to increase their visual awareness and creativity. Design concepts, abstraction, still life, figure, and landscapes will be among the subject matter that is explored in this hands-on studio experience. (Lab fee: \$25.00).
PREREQUISITE: Art Studio and department recommendation

DRAWING/DESIGN 261 (ADD26100 ADD26200)

GRADE: 10,11,12 LENGTH: 1 Sem CREDIT: .50 GPA: All Subject
Advanced design concepts are integrated within a variety of studio experiences. The assignments at this level require more individual personal expression and creative problem solving as students develop their own portfolios. Students will experiment with a range of materials and techniques. Increased emphasis will be placed on critiques and the daily maintenance of a sketchbook as evidence of the commitment to the artistic process. (Lab fee: \$25.00). PREREQUISITE: Art Studio, Drawing/Design 161 and department recommendation

DRAWING/DESIGN 361 (ADD36100 ADD36200)

GRADE: 10,11,12 LENGTH: 1 Sem CREDIT: .50 GPA: All Subject
This course is suggested for the advanced art student who wishes to develop a personal style through teacher-approved independent assignments that may include the areas of drawing, painting, and computer-generated arts. Students are expected to prepare a portfolio that can be used to pursue further study in college. The study of artists relevant to assignments will serve as a reference and guide for the development of personal expression. Daily maintenance of a sketchbook is required. (Lab fee: \$ 25.00). PREREQUISITE: Art Studio, Drawing/Design 161, 261 and department recommendation

GRAPHIC DESIGN 161 (AGD16100 AGD16200)

GRADE: 9,10,11,12 LENGTH: 1 Sem CREDIT: .50 GPA: All Subject
Students will explore various aspects of graphics through the development of original concepts and the creative use of typography, computer generated design and general illustration techniques. Students will develop computer art skills using the following programs: Photoshop, InDesign, and Illustrator. Media exploration and problem-solving design techniques will be included. (Lab fee: \$25.00). PREREQUISITE: Art Studio and department recommendation

GRAPHIC DESIGN 261 (AGD26100 AGD26200)

GRADE: 10,11,12 LENGTH: 1 Sem CREDIT: .50 GPA: All Subject
Students will employ a sophisticated use of design function in the problem-solving process. They will solve visual issues under real world deadline scenarios. Students will build on their computer generated art skills in Photoshop, InDesign, and Illustrator. Media and surface exploration are encouraged in two-dimensional and three-dimensional design. Development of a college oriented digital portfolio will begin. (Lab fee: \$25.00).
PREREQUISITE: Graphic Design 161 and department recommendation

GRAPHIC DESIGN 361 (AGD36100 AGD36200)

GRADE: 10,11,12 LENGTH: 1 Sem CREDIT: .50 GPA: All Subject
Students will explore the connection between design and visual communication as it relates to problem-solving activities; independent resource gathering will be encouraged to prepare students for advanced level solutions. Students will be introduced to web design using DreamWeaver. Advanced development of a college oriented digital portfolio will continue. (Lab fee: \$25.00).
PREREQUISITE: Graphic Design 161, 261 and department recommendation

GRAPHIC DESIGN 461 (AGD46100 AGD46200)

GRADE: 11,12 LENGTH: 1 Sem CREDIT: .50 GPA: All Subject
Students will be exposed to the visual communication process through authentic design production. Illustration, use of symbolism, and a research component will promote authentic client based scenarios. Advanced development of a college oriented digital portfolio will continue. (Lab fee: \$25.00). PREREQUISITE: Graphic Design 161, 261, 361 and department recommendation

HONORS ART 173 (AFF17300)

GRADE: 11,12 LENGTH: 2 Sem CREDIT: 1.00 GPA: All Subject & Academic
Students in this program follow a similar course of study as AP Studio Art students (program described below). However, they are not required to submit a portfolio to the College Board. (Lab fee: \$50.00).
PREREQUISITE: Art Studio, Drawing/Design 161, Graphic Design 161 and/or Photography 161, and department recommendation

ADVANCED PLACEMENT - STUDIO ART 183 (AAF58300)

GRADE: 12 LENGTH: 2 Sem CREDIT: 1.00 GPA: All Subject & Academic
This AP studio art situation affords students the opportunity to develop their personal aesthetic. Artistic growth is evidenced by a body of work which demonstrates a range of abilities ("breadth") and a sequential exploration of an idea which has personal meaning to the student ("concentration"). The concentration portion is accompanied by a written statement supporting the student's progress and rationale for his/her particular path of discovery. Both sections will be documented by the student in a digital portfolio. Other expectations include participation in ongoing individual and group critiques and the development of an independent course of art history study. Prospective students are encouraged to take a wide variety of art courses in preparation for this class and must present a portfolio for review. Board of Education policy requires that students take the Advanced Placement exam in order to receive AP credit. (Lab fee: \$50.00). PREREQUISITE: Art Studio, Drawing/Design 161, 261, Graphic Design 161 and/or Photography 161, department recommendation

CERAMICS 161 (ACE16100 ACE16200)

GRADE: 9,10,11,12 LENGTH: 1 Sem CREDIT: .50 GPA: All Subject
This introductory course focuses on experiences in hand-building and throwing on the potter's wheel. Students will also explore various firing procedures, glazing techniques and methods of surface embellishment. (Lab fee: \$25.00).
PREREQUISITE: Art Studio or department recommendation

CERAMICS 261 (ACE26100 ACE26200)

GRADE: 10,11,12 LENGTH: 1 Sem CREDIT: .50 GPA: All Subject
This advanced level course will continue the emphasis on the exploration of hand-building techniques and the development of basic throwing skills. Students will be expected to synthesize previous ceramic knowledge into their assignments. Examples of historical and contemporary ceramic artwork will provide the basis for the development of ideas. (Lab fee: \$25.00).
PREREQUISITE: Ceramics 161 and department recommendation

CERAMICS 361 (ACE36100 ACE36200)

GRADE: 10,11,12 LENGTH: 1 Sem CREDIT: .50 GPA: All Subject
 Enrollment in this advanced level course demonstrates an interest in the area of ceramic arts beyond the basics experienced in Ceramics 161 and 261. Emphasis will be placed on advanced level throwing techniques which will facilitate the realization of concepts and the articulation of shapes from clay. Students will be involved with clay mixing, kiln loading and unloading, various firing procedures, as well as advanced glaze and surface embellishment. (Lab fee: \$25.00). PREREQUISITE: Ceramics 161, 261 and department recommendation

CERAMICS 461 (ACE46100 ACE46200)

GRADE: 11,12 LENGTH: 1 Sem CREDIT: .50 GPA: All Subject
 Selected students who have displayed special talent and commitment to the exploration of advanced techniques in clay will work within an independent structure and develop a personal direction of study. Emphasis on the history of ceramic art as a knowledge/resource base will increase. Participation in this class will require a high level of maturity and self-motivation. (Lab fee: \$25.00). PREREQUISITE: Ceramics 161, 261, 361 and department recommendation

COMPUTER ART 161 (ACO16100)

GRADE: 9,10,11,12 LENGTH: 1 Sem CREDIT: .50 GPA: All Subject
 This electronic imaging course utilizes the Macintosh computer, graphic software, scanner and color printer to produce artwork which draws from the elements and principles of design as taught in Art Studio. Photoshop, InDesign, Illustrator, and DreamWeaver are among the programs which will be used to create assignments that might include logo and corporate identity, desktop publishing and website design, as well as projects described as more fine art in nature. (Lab fee: \$25.00). PREREQUISITE: Art Studio and department recommendation

PAINTING 161 (APA16100)

GRADE: 9,10,11,12 LENGTH: 1 Sem CREDIT: .50 GPA: All Subject
 This course is designed for students who wish to explore various painting media such as acrylic, watercolor, pastels, and paintstick as a means of visual expression. Students will expand on their knowledge of color theory, value, and composition while experiencing a variety of techniques. Students will participate in critiques and maintain a sketchbook. (Lab fee: \$25.00). PREREQUISITE: Art Studio and department recommendation

PAINTING 261 (APA26100)

GRADE: 10,11,12 LENGTH: 1 Sem CREDIT: .50 GPA: All Subject
 Advanced painting concepts serve as the focus of this course. Traditional and contemporary approaches to painting as well as utilizing a variety of media are emphasized. The student is encouraged to develop creative solutions to promote individual personal expression. The integration of both technical and intellectual skills will be explored through sketchbook practice and critiques. (Lab fee: \$25.00). PREREQUISITE: Painting 161 and department recommendation

PHOTOGRAPHY 161 (APH16100 APH16200)

GRADE: 9,10,11,12 LENGTH: 1 Sem CREDIT: .50 GPA: All Subject
 This course serves as an introduction to black-and-white photography. Camera operation, film and print development, photo history, and aesthetics of photographic composition will be covered. Students must supply 35mm single lens reflex camera, which must be approved by the instructor, in addition to film, photographic printing paper and mounting supplies. (Lab fee: \$25.00). PREREQUISITE: Art Studio and department recommendation

PHOTOGRAPHY 261 (APH26100 APH126200)

GRADE: 10,11,12 LENGTH: 1 Sem CREDIT: .50 GPA: All Subject
 Special effects such as multiple exposures, alternative processes, montages, solarization and photo stories are explored. Students will learn to photograph in low light or time exposure situations using a tripod and flash. (Lab fee: \$25.00 - plus additional cost of photographic materials). PREREQUISITE: Photography 161 and department recommendation

PHOTOGRAPHY 361 (APH36100 APH36200)

GRADE: 10,11,12 LENGTH: 1 Sem CREDIT: .50 GPA: All Subject
 Color processing of negative and reversal films and some printing on color papers will be introduced. Most color printing will be done on an inkjet printer. Students will learn to use Photoshop software and film scanning equipment. Medium and large format cameras will be used for black-and-white portraiture and still life work. A final portfolio will be required. (Lab fee: \$25.00 - plus additional cost of photographic materials). PREREQUISITE: Photography 161, 261 and department recommendation

PHOTOGRAPHY 461 (APH46100 APH46200)

GRADE: 11,12 LENGTH: 1 Sem CREDIT: .50 GPA: All Subject
 Students will produce 4" x 5" color transparencies of still life subjects. Strobe lighting will be used with small and medium format cameras for portrait photography. Students will document from a personal perspective an individual thematic issue in an extended series form, present a final portfolio and mount a one-person exhibit at the end of the semester. (Lab fee: \$25.00 - plus additional cost of photographic materials). PREREQUISITE: Photography 161, 261, 361 and department recommendation

Theatre/Drama

PERFORMANCE SKILLS 161 (EYP16100)

GRADE: 9 LENGTH: 1 Sem CREDIT: .50 GPA: All Subject
 The focus of this course is for the student to overcome apprehensions associated with performance. Introductory theater exercises are used to develop stage and speaking strengths. PREREQUISITE: None

DRAMA 161 (EYD16100)

GRADE: 10,11,12 LENGTH: 1 Sem CREDIT: 0.50 GPA: All Subject
 Especially appropriate for students who have not had an opportunity to perform, Drama 161 introduces the fundamental concepts of acting. Students learn by doing, performing in class, playing theatre games, and trying out improvisation. Topics of study include concentration, observation, imagination and skills for building an ensemble. In addition, students will write their own monologues and script original scenes. PREREQUISITE: Performance Skills 161 is highly recommended

DRAMA 261 (EYD26100)

GRADE: 10,11,12 LENGTH: 1 Sem CREDIT: 0.50 GPA: All Subject
 For students who wish to continue their drama studies, Drama 261 provides the opportunity to enhance improvisational skills and theatre experience. Students will focus on comedic improvisation, culminating in a class performance. PREREQUISITE: Drama 161 or instructor approval

ADVANCED ACTING AND DIRECTING 161 (EYN16100)

GRADE: 10,11,12 LENGTH: 1 Sem CREDIT: .50 GPA: All Subject
 Advanced Acting and Directing provides advanced study in drama with emphasis on the acting and directing of in-class performances. Assignments include performance and character-study, monologue development (for possible university audition material), and script writing. Students will form an ensemble and together they will write, direct, and create an original evening of theater, collaborating on all aspects of the production. PREREQUISITE: Performance Skills 161 and/or Drama 161 are highly recommended

ADVANCED IMPROVISATION (EYI16100)

GRADE: 10,11,12 LENGTH: 1 Sem CREDIT: 0.50 GPA: All Subject
 For students who wish to continue their drama skills, Advanced Improvisation is an accelerated course that emphasizes improvisational technique. Students will learn how to use drama exercises to create comedic "sketches", culminating in a sketch-comedy performance. PREREQUISITE: Drama 261 or instructor approval



MUSIC

BAND-VARSITY (MUB13300)

GRADE: 9 LENGTH: 2 Sem CREDIT: 1.00 GPA: All Subject

Varsity Band is preparatory to Symphonic Band. The student works to develop individual and group playing skills, appreciation, attitudes and habits. Extra-curricular requirements: attendance at all scheduled extra-curricular performances and rehearsals to include concerts and festivals. There is a semester rental fee for school owned instruments. PREREQUISITE: Previous playing experience in an instrumental (band) music ensemble or instructor's permission

BAND-SYMPHONIC (MUB14300)

GRADE: 10,11,12 LENGTH: 2 Sem CREDIT: 1.00 GPA: All Subject

Symphonic Band develops the skills of interpreting, performing and sight reading music, and provides opportunities for solo and small ensemble performance. The student is expected to practice a minimum of five hours per week outside of class. Symphonic Band can be repeated to a maximum of 4.00 credits. Extra-curricular requirements: attendance at all scheduled extra-curricular performances and rehearsals to include concerts, festivals, clinics and contests. There is a semester rental fee for school owned instruments. PREREQUISITE: Demonstration of musical competency determined by an audition and the musical balance needs of the organization, or successful completion of Varsity Band

BAND-SYMPHONIC WIND ENSEMBLE (MUB15300)

GRADE: 10,11,12 LENGTH: 2 Sem CREDIT: 1.00 GPA: All Subject

Symphonic Wind Ensemble enables the student to develop advanced skills through performances of a wide variety of music for winds and percussion. A minimum of seven hours per week of out-of-class practice is required. Players awarded positions in the Symphonic Wind Ensemble are required to serve as the wind and percussion members of the GBN Symphonic Orchestra. Symphonic Wind Ensemble can be repeated to a maximum of 3.0 credits. Extra-curricular requirements: Attendance at all scheduled, extra-curricular performances and rehearsals including concerts, festivals, clinics, and contests. There is a semester rental fee for school owned instruments. The male student is required to buy a prescribed shirt ensemble for concert wear. PREREQUISITE: Demonstration of music competency (determined by an audition) and the musical balance needs of the organization.

BAND-JAZZ ENSEMBLE (MUJ1730E)

GRADE: 9,10,11,12 LENGTH: 2 Sem CREDIT: .50 GPA: All Subject

Jazz Ensemble is designed to develop individual and group skills in jazz performance and improvisation. Daily out-of-class practice is required. The Jazz Ensemble players are expected to be concurrent members of either Varsity Band, Symphonic Band or Symphonic Wind Ensemble. The class meets from 6:55-7:35 a.m. on Monday, Tuesday, Thursday, Friday with select combos meeting on Wednesday. Students are expected to participate in the co-curricular concerts and contests that appear on the department calendar. There is a semester rental fee for school owned instruments.

PREREQUISITE: Demonstration of musical competency determined by a spring audition with the director

BAND-JAZZ LAB (MUJ16300)

GRADE: 9,10,11,12 LENGTH: 2 Sem CREDIT: .50 GPA: All Subject

Jazz Lab is designed to develop individual and group skills in basic jazz performance. The Jazz Lab members are expected to be concurrent members of either Varsity Band, Symphonic Band or Symphonic Wind Ensemble. The class meets from 6:55-7:35 a.m. on Monday, Tuesday, Thursday and Friday. The students are expected to participate in the co-curricular concerts and contests that appear on the department calendar. There is a semester rental fee for school-owned instruments. PREREQUISITE: Demonstration of musical competency determined by a spring audition with the director

TREBLE CHOIR (MUV13300)

GRADE: 9,10,11,12 LENGTH: 2 Sem CREDIT: 1.00 GPA: All Subject

This introductory girls' choral ensemble fosters and promotes the enjoyment of singing. Students singing in the soprano and alto registers will develop their vocal abilities through the study and performance of appropriate choral literature. Music sung will range from classical to pop. Treble Choir is recommended for students who plan to continue in choral ensembles. A requirement for this course is attendance at all scheduled extra-curricular rehearsals and performances. The student may be required to purchase the required shoes for concert wear. PREREQUISITE: None

SPARTAN CHOIR (MUV14300)

GRADE: 9,10,11,12 LENGTH: 2 Sem CREDIT: 1.00 GPA: All Subject
 This introductory choral ensemble fosters and promotes the enjoyment of singing. Students singing in the tenor and bass registers will develop their vocal abilities through the study and performance of appropriate choral literature. Music sung will range from classical to pop. Spartan Choir is recommended for students who plan to continue in choral ensembles. A requirement for this course is attendance at all scheduled extra-curricular rehearsals and performances. The student may be required to purchase the required shirt/shoes for concert wear. PREREQUISITE: None

VARSITY CHOIR (MUV15300)

GRADE: 10,11,12 LENGTH: 2 Sem CREDIT: 1.00 GPA: All Subject
 This intermediate level mixed choral ensemble fosters and promotes the enjoyment of singing. Students will continue to develop their vocal abilities through the study and performance of appropriate choral literature. Music sung will range from classical to pop. Varsity Choir is recommended for students who plan to continue in choral ensembles. A requirement for this course is attendance at all scheduled extra-curricular rehearsals and performances. The student may be required to purchase the required shoes for concert wear. PREREQUISITE: None

CECILIAN SINGERS (MUV16300)

GRADE: 10,11,12 LENGTH: 2 Sem CREDIT: 1.00 GPA: All Subject
 This advanced choral ensemble for women's voices fosters and promotes the enjoyment of singing. Students will continue to develop an advanced level of vocal production, sight-reading, music theory, and other music fundamentals. This course will explore a wide range of choral literature from pop to classical. A requirement for this course is attendance at all scheduled extra-curricular rehearsals and performances. The student may be required to purchase the required shoes for concert wear. PREREQUISITE: Demonstration of musical competency (to be determined by instructor) and the musical balance needs of the ensemble.

CHORALE (MUV17300)

GRADE: 10,11,12 LENGTH: 2 Sem CREDIT: 1.00 GPA: All Subject
 This advanced choral ensemble for mixed voices fosters and promotes the enjoyment of singing. Students will continue to develop an advanced level of vocal production, sight-reading, music theory, and other music fundamentals. This course will explore a wide range of choral literature from pop to classical. A requirement for this course is attendance at all scheduled extra-curricular rehearsals and performances. The student may be required to purchase the required shoes/shirt for concert wear. PREREQUISITE: Demonstration of musical competency (to be determined by instructor) and the musical balance needs of the ensemble.

ORCHESTRA-STRING ENSEMBLE (MUO15300)

GRADE: 9 LENGTH: 2 Sem CREDIT: 1.00 GPA: All Subject
 String Orchestra is preparatory to Symphonic Orchestra. The student works to develop individual and group playing skills, appreciation, attitudes and rehearsal habits. This group performs both by itself and occasionally with the Symphonic Orchestra. A requirement for this course is attendance at all scheduled extra curricular performances and rehearsals. There is a semester rental fee for school owned instruments. The male student is required to buy a prescribed shirt ensemble for concert wear. PREREQUISITE: Demonstration of musical competency (to be determined by an audition) and the musical balance needs of the organization

ORCHESTRA-SYMPHONIC (MUO16300)

GRADE: 10,11,12 LENGTH: 2 Sem CREDIT: 1.00 GPA: All Subject
 Symphonic Orchestra is for the student who has completed a successful experience in a String Orchestra. Emphasis is on individual adjustment to group participation, reading and performance of standard orchestral repertoire. Full orchestra music is performed when schedule and literature allow. The course can be repeated to a maximum of 4.00 units of credit. A requirement for this course is attendance at all scheduled extra-curricular performances and rehearsals. Members of the Symphonic Orchestra are required to partici-

pate in the extra-curricular Glenbrook Symphony Orchestra. There is a semester rental fee for school owned instruments. The male student is required to buy a prescribed shirt ensemble for concert wear. PREREQUISITE: Demonstration of musical competency (to be determined by an audition) and the musical balance needs of the organization

GENERAL-ELECTRONIC MUSIC 161 (MUE16100 MUE16200)

GRADE: 9,10,11,12 LENGTH: 1 Sem CREDIT: .50 GPA: All Subject
 This course is for the student with little or no previous formal training who wishes to learn the basics of electronic music. The student learns to use the instruments and software of the Electronic Music Lab, computers, synthesizers, samplers, sequencers, and digital recorders. The fundamentals of music theory are also covered. PREREQUISITE: None

INTRODUCTION TO MUSIC THEORY AND COMPOSITION (MUT16200)

GRADE: 9,10,11,12 LENGTH: 1 Sem CREDIT: .50 GPA: All Subject
 This introductory course is designed to give students a foundation knowledge of music writing, analysis and composition. Included will be a study of the basic principles of music theory, standard notation, scales, keys, intervals, chords, melody, harmony, and ear training. Students planning to continue their music studies or performance training should enroll in this course. Musical analysis and composition is an integral part of the sequence of instruction. The course may be used as a primer for Advanced Placement Music Theory. Students enrolling in this course should be able to read standard musical notation. PREREQUISITE: None

ADVANCED PLACEMENT MUSIC THEORY 183 (MUT18300)

GRADE: 10,11,12 LENGTH: 2 Sem CREDIT: 1.00
 GPA: All Subject & Academic
 Through the study of music literature and symbology, the class will explore four related concepts: composition, analysis, perception and cognition. At year's end, the student will have been presented all the tools and understanding necessary to utilize these concepts to be successful on the AP Music Theory Test. Although this course is geared toward the AP test, the curriculum is not exclusive of AP materials. Students enrolled in AP Music Theory receive instruction that would be the equivalent of a typical college first year harmony course. PREREQUISITE: Recommendation of the Music Department is required

GUITAR 161 (MUG16100)

GRADE: 9,10,11,12 LENGTH: 2 Sem CREDIT: 1.00 GPA: All Subject
 This is a beginning guitar class. No prior musical knowledge or playing experience is required. Basic guitar playing technique, including tuning, note reading and chord playing is included. Grades are based on knowledge of the guitar plus playing ability. PREREQUISITE: Each student must provide his own acoustic guitar. No amplifiers or electric guitars are allowed in class.





RADIO/TELEVISION BROADCASTING

INTRODUCTION TO BROADCASTING 161 (RTB06100 RTB06200)

GRADE: 9,10,11,12 **LENGTH:** 1 Sem **CREDIT:** .50 **GPA:** All Subject
Introduction to Broadcasting is an exciting course where students develop their interpersonal and group communication skills. This course is for students who are interested in radio broadcasting, television production, sports broadcasting, broadcast journalism, Internet broadcasting, or audio production. Principles of broadcasting are explored through the creation of student-produced radio and television projects. Through project-based instruction, students learn how to use the radio equipment in the Glenbrook North WGBK-FM on-air production studios. Students produce a variety of programs including commercials, news features, kicker stories, interviews and DJ music programs. In the television broadcasting component, students build on the skills learned in radio. Students learn how to operate the three camera studios through the production of editorials, newscasts and commercials. Students are required to participate in individual, team, and group projects and will be graded on these assignments. Career opportunities and the power of media will be investigated. **PREREQUISITE:** None

RADIO BROADCASTING 161 (RTR16100 RTR16200)

GRADE: 9,10,11,12 **LENGTH:** 1 Sem **CREDIT:** .50 **GPA:** All Subject
This first level course is designed for students interested in developing the "hands-on" skills necessary for radio broadcasting. Students learn about the various aspects of radio broadcasting by preparing for a weekly radio show that airs on our radio station, WGBK 88.5FM. WGBK-FM is licensed by the Federal Communications Commission (FCC), therefore, on-air behavior is governed by FCC guidelines, as well as the GBN Student Handbook. A solid understanding of appropriate content material is necessary. The radio show takes place after school and this additional time commitment is required. Students are required to participate in individual, team, and group projects and will be graded on these assignments. Students learn how to plan and conduct an interview in the radio studios using remote equipment. They also learn to use a digital audio editing system and are responsible for completing edited assignments. Outside class time may be required for completion of radio production assignments and is definitely required for radio shows. Above average performance in Introduction to Broadcasting and demonstrated maturity are expectations for advancement to higher levels of this sequence. **PREREQUISITE:** Introduction to Broadcasting and department recommendation

RADIO BROADCASTING 261 (RTR26100 RTR26200)

RADIO BROADCASTING 361 (RTR36100 RTR36200)

RADIO BROADCASTING 461 (RTR46100 RTR46200)

GRADE: 10,11,12 **LENGTH:** 1 Sem **CREDIT:** .50 **GPA:** All Subject
The advanced radio program is a multi-level classroom arrangement (i.e., Radio Broadcasting 261, 361, 461). Students are expected to contribute to the development of station goals and objectives, work independently and develop production projects which reflect technical and creative growth. In subsequent levels students will build upon previous knowledge in order to improve their abilities to relate a story in a concise manner and to synthesize multiple interviews into one coherent piece. Student development may be measured by their progression toward increasingly sophisticated and mature reflective thought. They are required to operate the digital audio editing equipment and remote broadcasting equipment in order to complete assignments. Students are required to participate in individual, team, and group projects and will be graded on these assignments. Outside class time is required for the completion of radio production assignments and for radio shows. Above average performance in the prior class and demonstrated maturity are expectations for advancement to higher levels of this sequence. Students in 261 receive assignments designed to expand upon basic production techniques. Students in 361 take a more active role in managing the radio shows. They are expected to understand advanced production techniques and be able to create work that demonstrates mastery and creativity. Students in 461 must be willing to accept the responsibilities of leadership in the radio broadcasting program. They are allowed more freedom to develop project topics and will contribute to the program as a whole by assisting peers and less advanced students in a team setting. **PREREQUISITE:** Appropriate credit in the previous course (i.e., 161, 261, 361) and department recommendation

SPORTSCASTING 161 (RTB16100 RTB16200)

GRADE: 9,10,11,12 **LENGTH:** 1 Sem **CREDIT:** .50 **GPA:** All Subject
This first level course for students interested in developing the skills necessary for sports broadcasting on radio and television introduces students to play-by-play and color commentary; students are able to practice these skills in a classroom situation. They are also taught how to plan and conduct an interview and are required to conduct them in the radio and television studios. Students learn how to use remote broadcasting equipment and are expected to do so responsibly. They will gain basic working knowledge of video cameras, audio recording, computer graphics, and video editing systems. Students are required to create a music video, conduct single and multiple camera interviews, videotape live sporting events and demonstrate broadcast writing skills. Students are required to participate in individual, team, and group projects and will be graded on these assignments. Outside class time is required for the completion of course assignments. Above average performance in Introduction to Broadcasting and demonstrated maturity are expectations for advancement to higher levels of this sequence. **PREREQUISITE:** Introduction to Broadcasting and department recommendation



SPORTSCASTING 261 (RTB26100 RTB26200)**SPORTSCASTING 361 (RTB36100 RTB36200)****SPORTSCASTING 461 (RTB46100 RTB46200)**

GRADE: 10,11,12 LENGTH: 1 Sem CREDIT: .50 GPA: All Subject

The advanced sportscasting program is a multi level classroom arrangement (i.e., Sports Broadcasting 261, 361, 461). Students are required to participate in individual, team, and group projects and will be graded on these assignments. In 261 students are required to produce segments that will be aired on a weekly program on GBN-TV. These segments must reflect solid interviewing skills and technical ability as well as responsibility and maturity. More advanced equipment will be introduced as students develop technical and artistic competence. In 361 students are expected to master and demonstrate competence in increasingly challenging assignments of an independent nature. They are expected to work independently. Students in 461 must be willing to accept the responsibilities of leadership in the sports broadcasting program. Freedom to develop program ideas will be encouraged. Students will assist peers and less advanced students, thereby contributing to the team work aspect of the program as a whole. Outside class time is required for the completion of course assignments. Above average performance in the prior class and demonstrated maturity are expectations for advancement to higher levels of this sequence. PREREQUISITE: Appropriate credit in the previous course (i.e., 161, 261, 361) and department recommendation

TELEVISION BROADCASTING 161 (RTT16100 RTT16200)

GRADE: 9,10,11,12 LENGTH: 1 Sem CREDIT: .50 GPA: All Subject

This first level course introduces students to the skills necessary for television broadcasting, broadcast journalism, film production and multimedia production. Through individual, team, and group projects students will learn the technical and creative aspects of various program types through individual and group projects. These may include the creation of music videos, single and multiple camera interviews, live television production and feature story presentation. Students are also required to develop a short program idea and execute it for their final evaluation. Students are introduced to and will gain basic working knowledge of video cameras, audio recording, computer graphics and video editing systems. Outside class time is required for the completion of class assignments. Success in Introduction to Broadcasting and demonstrated maturity are expectations for advancement to higher levels of this sequence. PREREQUISITE: Introduction to Broadcasting and department recommendation

TELEVISION BROADCASTING 261 (RTT26100 RTT26200)

GRADE: 10,11,12 LENGTH: 1 Sem CREDIT: .50 GPA: All Subject

Students will begin to produce video programming for presentation over GBN-TV, cable television channel 16. Students are expected to develop projects in their field of interest that demonstrate technical and creative growth. As students develop technical and artistic competence, individual, team, and group projects will be assigned focusing on aspects of production that will complement their individual skills and interests. Students will utilize more advanced and demanding hardware and software in the production process. Introduction to non-linear editing and cable programming techniques will begin once they demonstrate mastery of entry level equipment. Outside class time is required for the completion of class assignments. Success in Television Broadcasting 161 and demonstrated maturity are expectations for advancement to higher levels of this sequence. PREREQUISITE: Television Broadcasting 161 and department recommendation

TELEVISION BROADCASTING 361 (RTT36100 RTT36200)

GRADE: 10,11,12 LENGTH: 1 Sem CREDIT: .50 GPA: All Subject

Advanced levels of production, both technical and conceptual, are goals of this course. Students at this level should understand basic video production and are expected to attempt increasingly challenging assignments. Through individual, team, and group projects students will continue to develop and refine their video editing skills, graphic creation capabilities, interviewing techniques and story telling capabilities. Independence and leadership in the presentation of program materials over GBN-TV are an integral part of this course. Outside class time is required for the completion of class assignments. Success in Television Broadcasting 261 and demonstrated maturity, initiative, motivation and ability to work independently and as a team are all expectations for advancement to higher levels of this sequence. PREREQUISITE: Television Broadcasting 261 and department recommendation

TELEVISION BROADCASTING 461 (RTT46100 RTT46200)

GRADE: 11,12 LENGTH: 1 Sem CREDIT: .50 GPA: All Subject

This level of television production should be considered only by those with serious career interests. Teamwork is a serious focus of this level and students must accept the responsibilities of leadership throughout the program. Students will be allowed more freedom in the development of individual, team, and group project ideas and will be expected to assist peers and less advanced students in the completion of their projects. Students may investigate advanced computer graphic creations through 3D animation software and audio enhancement through non-linear computer-based editing. Outside class time is required for the completion of class assignments. Success in Television Broadcasting 361 and demonstrated maturity, initiative, motivation and ability to work independently and as a team are all expectations of this class. PREREQUISITE: Television Broadcasting 361 and department recommendation



MATHEMATICS

SEQUENCE	FRESHMAN	SOPHOMORE	JUNIOR	S	E	N	I	O	R
TEAM	Prealgebra 163	Algebra GTA 163	Geometry GA	Advanced Algebra GA					
	Algebra GTA 163	Geometry GA	Advanced Algebra GA	College Algebra GA 161 Trigonometry GA 161					
G	Algebra G 163	Geometry G 163	Adv. Algebra G 263	College Algebra G 161 Trigonometry G 161				Pre-Calculus/Trig 163 <i>OR</i> Discrete Mathematics 163	
REGULAR	Algebra 163	Geometry 163	Adv. Algebra 263	Pre-Calculus/Trig 163				Discrete Mathematics 163	
	Geometry 163	Advanced Algebra 263	Pre-Calculus/Trig 163	AP Calculus AB 183 <i>OR</i> AP Statistics 183				Discrete Mathematics 163	
	Advanced Algebra 263	Pre-Calculus/Trig 163	AP Calculus AB 183	AP Statistics 183 <i>OR</i> Discrete Mathematics 163					
HONORS	Geometry 173	Adv. Algebra/Trig 273	Pre-Calculus 173	AP Calculus AB 183 <i>OR</i> AP Calculus BC 183				AP Statistics 183 <i>OR</i> Advanced Topics 173	
	Adv. Algebra/Trig 273	Pre-Calculus 173	AP Calculus AB 183 <i>OR</i> AP Calculus BC 183	AP Statistics 183 <i>OR</i> Advanced Topics 173				AP Statistics 183	

All students enrolled in Prealgebra 163 must have a scientific calculator.

All other mathematics classes require graphing calculators.

Incoming 2010 freshmen will need TI-Nspire graphing calculators.

Calculus BC is the prerequisite for Advanced Topics.

Students may take AP Statistics and either AP Calculus or Advanced Topics concurrently.

Department permission is required if a student wants to take AP Statistics concurrently with Pre-calculus 163/173.

MATHEMATICS

All incoming freshmen are required to have the TI-Nspire handheld graphing calculator for their math class.

PREALGEBRA 163 (MAI10300)

GRADE: 9 LENGTH: 2 Sem CREDIT: 1.00 GPA: All Subject & Academic
PreAlgebra 163 is a prerequisite for enrollment in algebra. It is a bridge between the concrete ideas of arithmetic and geometric figures to the more abstract concepts of algebra and geometric reasoning. The course will reinforce basic computational skills with whole numbers and fractions. It will introduce algebraic ideas of integers, variables, the simplification of algebraic expressions and the solution of linear equations. The scores from the eighth grade testing program, input from eighth grade teachers, and the GBN instructional supervisor are used in student placement.

PREREQUISITE: Recommendation by GBN Mathematics Department

ALGEBRA GTA 163 (MAA14300)

GRADE: 9,10,11 LENGTH: 2 Sem CREDIT: 1.00

GPA: All Subject & Academic

Algebra GTA 163 is a college preparatory course that focuses on algebraic skills, concepts, and applications while strengthening arithmetic skills. This team course is taught by two teachers from the GBN mathematics department and the class meets every day. (90 minutes one day and 45 minutes the second day). Topics include operations with integers, simplifying expressions, factoring, absolute value, linear and quadratic functions, inequalities, and systems of equations. The scores from the eighth grade testing program, input from eighth grade teachers, and the GBN instructional supervisor are used in student placement for incoming freshmen. A graphing calculator is required for this course. PREREQUISITE: Prealgebra 163 or equivalent and GBN department recommendation

ALGEBRA G 163 (MAA15300)

GRADE: 9,10 LENGTH: 2 Sem CREDIT: 1.00 GPA: All Subject & Academic
Algebra G 163 is a college preparatory course that focuses on algebraic skills, concepts, and applications while strengthening arithmetic skills. Topics include operations with integers, simplifying expressions, factoring, absolute value, linear and quadratic functions, inequalities, and systems of equations. The scores from the eighth grade testing program, input from eighth grade teachers, and the GBN instructional supervisor are used in student placement for incoming freshmen. A graphing calculator is required for this course.

PREREQUISITE: Prealgebra 163 or equivalent and GBN department recommendation

ALGEBRA 163 (MAA16300)

GRADE: 9,10 LENGTH: 2 Sem CREDIT: 1.00 GPA: All Subject & Academic
Algebra 163 introduces the fundamental operations with directed numbers, linear equations, graphic and algebraic solutions to systems of equations, polynomial arithmetic and solutions to quadratic equations with applications. The scores from the eighth grade testing program, input from eighth grade teachers, and the GBN instructional supervisor are used in student placement for incoming freshmen. A graphing calculator is required for this course.

PREREQUISITE: Prealgebra 163 or equivalent and GBN department recommendation



GEOMETRY GA 163 (MAG14300)

GRADE: 10,11 LENGTH: 2 Sem CREDIT: 1.00 GPA: All Subject & Academic

Geometry GA 163 is a one-year course that focuses on topics such as area, volume, right triangles, parallelism, and a review of algebra. This course is designed to develop critical thinking skills through informal arguments and formal proof. Geometric relationships and properties are presented through manipulative tools, interactive computer explorations, and geometric constructions. A graphing calculator is required for this course. PREREQUISITES: Algebra GTA 163 or equivalent and GBN department recommendation

GEOMETRY G 163 (MAG15300)

GRADE: 10,11 LENGTH: 2 Sem CREDIT: 1.00 GPA: All Subject & Academic

Geometry G 163 is a one-year course that focuses on topics such as area, volume, right triangles, parallelism, and a review of algebra. This course is designed to develop critical thinking skills through informal arguments and formal proof. Proof is covered through triangle congruences and similarity. Geometric relationships and properties are presented through manipulative tools and interactive computer explorations. A graphing calculator is required for this course. PREREQUISITE: Algebra G 163 or equivalent and GBN department recommendation

GEOMETRY 163 (MAG16300)

GRADE: 9,10 LENGTH: 2 Sem CREDIT: 1.00 GPA: All Subject & Academic

Geometry 163 is a one-year plane geometry course with applications in three dimensions. Algebra is used as a transitional tool to relate geometric concepts with previously learned material. This course is designed to develop critical thinking through analytic reasoning and an understanding and appreciation of basic geometric relationships. Deductive proof is used in various topics throughout the course. Geometric relationships and properties are presented through manipulative tools and interactive computer explorations. The scores from the eighth grade testing program, input from eighth grade teachers, and the GBN instructional supervisor are used in student placement for incoming freshmen. A graphing calculator is required for this course.

PREREQUISITE: Algebra 163 or equivalent and GBN department recommendation

GEOMETRY 173 HONORS (MAG17300)

GRADE: 9,10 LENGTH: 2 Sem CREDIT: 1.00 GPA: All Subject & Academic
 Geometry 173 is a plane geometry course with applications in three dimensions. Topics include congruence, similarity, parallel lines and planes, perpendicular lines and planes, polygons, circles, area, volume, coordinate geometry, and advanced geometry concepts. This course is designed to develop critical thinking through analytic reasoning and an understanding and appreciation of basic geometric relationships. Problem solving and sophisticated deductive reasoning are emphasized. Technology is used as a tool for inductive reasoning. Algebra is used as a transitional tool to relate geometric concepts with previously learned material. The scores from the eighth grade testing program, input from eighth grade teachers, and the GBN instructional supervisor are used in student placement for incoming freshmen. A graphing calculator is required for this course. PREREQUISITE: Algebra 163 or equivalent and GBN department recommendation

ADVANCED ALGEBRA GA 263 (MAL24300)

GRADE: 11,12 LENGTH: 2 Sem CREDIT: 1.00 GPA: All Subject & Academic
 Advanced Algebra GA 263 includes a review of the major algebra topics and also includes systems of equations and inequalities, linear and quadratic functions, exponential and logarithmic functions, conic sections, complex numbers, probability and basic statistics. A graphing calculator is required for this course.
 PREREQUISITE: Geometry GA 163 or equivalent and GBN department recommendation

ADVANCED ALGEBRA G 263 (MAL25300)

GRADE: 11,12 LENGTH: 2 Sem CREDIT: 1.00 GPA: All Subject & Academic
 Advanced Algebra G 263 is an intermediate algebra course which focuses on the topics of systems of equations, polynomial arithmetic, complex numbers, solutions of quadratic equations, exponential and logarithmic functions, sequences and series, and applications of mathematics. A graphing calculator is required for this course.
 PREREQUISITE: Geometry G 163 or equivalent and GBN department recommendation

ADVANCED ALGEBRA 263 (MAL26300)

GRADE: 9,10,11,12 LENGTH: 2 Sem CREDIT: 1.00
 GPA: All Subject & Academic
 Advanced Algebra 263 reviews and extends the content of Algebra 163. Topics include inequalities, systems of equations, matrices, complex numbers, exponents, radicals, polynomials, sequences and series, probability and statistics and in-depth-work with functions (linear, quadratic, exponential, logarithmic, polynomial, and rational). A graphing calculator is required for this course.
 PREREQUISITE: Geometry 163 or equivalent and department recommendation

ADVANCED ALGEBRA/TRIGONOMETRY HONORS 273 (MAL27300)

GRADE: 9,10 LENGTH: 2 Sem CREDIT: 1.00 GPA: All Subject & Academic
 Advanced Algebra 273 is a challenging course which includes the topics of inequalities, complex numbers, functions (linear, quadratic, exponential, logarithmic, polynomial and rational) and trigonometry. A goal for this course is to develop a student's ability to problem solve. The scores from the eighth grade testing program, input from eighth grade teachers, and the GBN instructional supervisor are used in student placement for incoming freshmen. A graphing calculator is required for this course.
 PREREQUISITE: Geometry 173 or Geometry 163 and GBN department recommendation. (freshmen enrolled in Geometry 163 that receive a recommendation for this course will be required to take a placement test).

COLLEGE ALGEBRA GA 161/TRIGONOMETRY GA 161 (MAP14300)

GRADE: 12 LENGTH: 1 Sem Each CREDIT: 0.50 each
 GPA: All Subject & Academic
 College Algebra GA 161 is a continuation of concepts introduced in the Advanced Algebra GA 263. This course includes the study of probability, statistics, sequences and series, and functions and their graphs.
 Trigonometry GA 161 is designed to follow College Algebra GA 161. Topics include right triangle trigonometry, the unit circle, and trigonometric functions including their applications and graphs. Topics are presented through manipulative tools, interactive computer explorations, and graphing calculator activities. A graphing calculator is required for this course. PREREQUISITE: Advanced Algebra GA 263 and GBN department recommendation

COLLEGE ALGEBRA G 161/TRIGONOMETRY G 161 (MAP15300)

GRADE: 12 LENGTH: 1 Sem. Each CREDIT: 0.50 each
 GPA: All Subject & Academic
 College Algebra G 161 is a continuation of concepts introduced in the advanced algebra courses. Topics include theory of equations, rational functions and their graphs, exponential functions and their graphs, and logarithmic functions and their graphs.
 Trigonometry G 161 is designed to follow College Algebra G 161. Topics include right triangle trigonometry, the unit circle, and trigonometric functions including their applications and graphs. A graphing calculator is required for this course.
 PREREQUISITE: Advanced Algebra G 263 and GBN department

PRE-CALCULUS/TRIGONOMETRY 163 (MAP16300)

GRADE: 10,11,12 LENGTH: 2 Sem CREDIT: 1.00
 GPA: All Subject & Academic
 Pre-calculus 163 includes standard subject matter from college algebra, trigonometry, and analytic geometry. Students study complex numbers, trigonometric functions, identities, and formulae, circular functions, inverse matrices and determinants, graphing techniques with analytic geometry. Students who received credit in Advanced Algebra/Trigonometry 273 cannot receive credit for this course unless they have secured math department permission from the instructional supervisor. A graphing calculator is required for this course. PREREQUISITE: Advanced Algebra 263 and GBN department recommendation

PRE-CALCULUS HONORS 173 (MAP17300)

GRADE: 10,11 LENGTH: 2 Sem CREDIT: 1.00 GPA: All Subject & Academic
 Pre-calculus Honors 173 is designed to follow Advanced Algebra/Trigonometry 273 in order to complete topics in trigonometry, discrete mathematics, and analytic geometry. Students study trigonometric functions and their applications, matrix arithmetic, analytic geometry with the conic sections and vector analysis, combinatorics, probability, mathematical induction, and sequences. A goal of this course is the continued development of a student's ability to problem solve. A graphing calculator is required for this course. PREREQUISITE: Advanced Algebra/Trigonometry 273 and GBN department recommendation

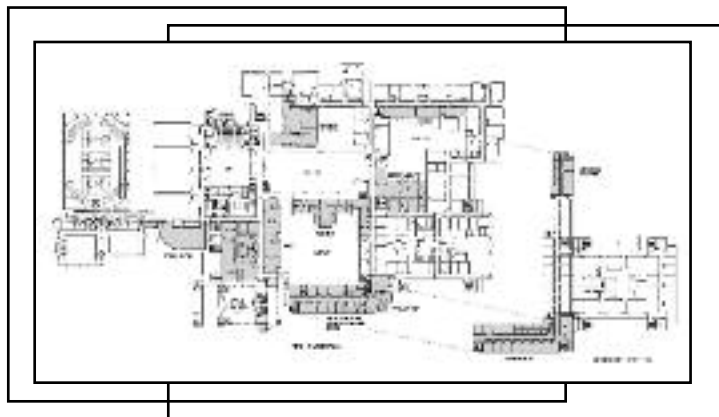

DISCRETE MATHEMATICS 163 (MAS16300)

GRADE: 12 LENGTH: 2 Sem CREDIT: 1.00 GPA: All Subject & Academic
Discrete Mathematics is a one-year class designed for seniors that have completed pre-calculus. This course will cover such topics as graph theory, matrices, statistics, recursion, logic, voting methods, and combinatorics. A graphing calculator is required for this course.
PREREQUISITE: Pre-calculus 163 and GBN department recommendation

STATISTICS AP 183 (MCS18300)

GRADE: 10,11,12 LENGTH: 2 Sem CREDIT: 1.00
GPA: All Subject & Academic
This course will follow the Advanced Placement Statistics syllabus as recommended by the College Board. Major themes of study include exploratory data analysis, planning a study, probability and statistical inference. This course is the equivalent to one semester college-level course in introductory statistics. Board of Education policy requires students to take the AP Exam in order to receive AP credit. A graphing calculator is required for this course.
PREREQUISITE: Pre-calculus 163/173 and GBN department recommendation.
Students that would like to enroll in AP Statistics concurrently with Pre-calculus must receive permission from the instructional supervisor of the mathematics department

CALCULUS AB AP 183 (MCC28300)

CALCULUS BC AP 183 (MCC48300)

GRADE: 11,12 LENGTH: 2 Sem each CREDIT: 1.00 Each
GPA: All Subject & Academic
Calculus AB includes analytic geometry with a least one full semester of single variable college calculus. Calculus BC is an intensive full year of college calculus and requires additional theoretical knowledge of calculus. The mathematics department designates AB or BC calculus on student recommendations. Board of Education policy requires students to take the AP Exam in order to receive AP credit. A graphing calculator is required for this course.
PREREQUISITE: Pre-calculus 163/173 and GBN department recommendation

ADVANCED TOPICS IN MATHEMATICS 173 (MCT87300)

GRADE: 12 LENGTH: 2 Sem CREDIT: 1.00 GPA: All Subject & Academic
Advanced topics is designed for students that have completed BC Calculus AP. Linear algebra and multi-variable calculus are studied in this course. A graphing calculator is required for this course.
PREREQUISITE: AP Calculus BC and GBN department recommendation



Computer Technology

Computer Science Java 371 (MMP37100)

GRADE: 9,10,11,12 LENGTH: 1 Sem CREDIT: 0.50
GPA: All Subject & Academic
This course is an introduction to structured programming using Java. Common programming themes-fundamental data types, methods, parameters, decisions, iteration, and object orientation- are presented in a formal practical approach. This course uses the language tested on the Advanced Placement Computer Science exam. PREREQUISITE: Geometry 163 or higher course work (may concurrently enroll with Geometry with GBN mathematics department permission).

Computer Science Advanced Placement 583 (MMP58300)

GRADED: 10,11,12 LENGTH: 2 Sem CREDIT: 1.00
GPA: All Subject & Academic
This course covers the Advanced Placement Computer Science course as recommended by the College Board. Emphasis is on advanced data structures and analysis of algorithms. Board of Education policy requires students to take the AP Exam in order to receive AP credit.
PREREQUISITE: Successful completion of Computer Science Java 371 and GBN department recommendation

NOTES

A large rectangular box with rounded corners, containing the word 'NOTES' at the top and several horizontal lines below it for writing.

PHYSICAL EDUCATION, HEALTH AND DRIVER EDUCATION

All Physical Education classes have a daily 20 minute fitness unit

Core Program

COURSES	FRESHMAN	SOPHOMORE	JUNIOR	SENIOR
PHYSICAL EDUCATION				
Freshman Boys 163	Offered			
Freshman Girls 163	Offered			
Health Education 161		Offered		
Health GT 161		Offered		
PHYSICAL EDUCATION				
Sophomore Boys 261		Offered		
Sophomore Girls 261		Offered		
Introduction to Strength Training 161		Offered		

Elective Offerings

PHYSICAL EDUCATION	FRESHMAN	SOPHOMORE	JUNIOR	SENIOR
Fundamentals of Personal Training 161			Offered	Offered
Aquatics 161		Offered	Offered	Offered
Dance 161			Offered	Offered
Dance II 261			Offered	Offered
Fit For Life		Offered	Offered	Offered
Adventure Education 161			Offered	Offered
Adventure Education 261			Offered	Offered
Lifetime Sports and Conditioning 161			Offered	Offered
Leaders Physical Education Juniors 163			Offered	
Leaders Physical Education Seniors 263				Offered
Physical Management 171		Offered	Offered	Offered
Team Sports and Conditioning 161			Offered	Offered
Strength Training and Conditioning 161			Offered	Offered
Strength Training and Conditioning 261			Offered	Offered
Adaptive Physical Education	Offered	Offered	Offered	Offered
Athletics - Boys			Offered	Offered
Athletics - Girls			Offered	Offered

DRIVER EDUCATION	FRESHMAN	SOPHOMORE	JUNIOR	SENIOR
Driver Education 161 CL/Lab		Offered	Offered	Offered
Driver Education G 161 CL/Lab		Offered	Offered	Offered



PHYSICAL EDUCATION, HEALTH & DRIVER EDUCATION

PHYSICAL EDUCATION FRESHMAN BOYS 163 (PEB16300)

GRADE: 9 LENGTH: 2 Sem CREDIT: 1.00 GPA: All Subject

The freshman curriculum is designed for the student to explore new activities while developing an attitude that participation in physical activities can lead to a lifetime of recreational fun and healthy living. Basic skills and physical fitness necessary to participate in a variety of conditioning and sport activities are introduced. These activities include: basketball, fitness, gymnastics, soccer, speedball, swimming, track and field, volleyball, weights, and wrestling.

PREREQUISITE: None

PHYSICAL EDUCATION FRESHMAN GIRLS 163 (PEG17300)

GRADE: 9 LENGTH: 2 Sem CREDIT: 1.00 GPA: All Subject

The freshman curriculum is designed for the student to explore new activities while developing an attitude that participation in physical activities can lead to a lifetime of recreational fun and healthy living. Basic skills and physical fitness necessary to participate in a variety of conditioning and sport activities are introduced. These activities include: aerobics, badminton, basketball, dance, fitness, gymnastics, soccer, swimming, volleyball, and strength training.

PREREQUISITE: None

HEALTH GT 161 (PAH15100)

GRADE: 10 LENGTH: 1 Sem CREDIT: .50 GPA: All Subject

The purpose of health GT is to acquaint team students with attitudes, values and practices enabling them to make wise decisions in matters of personal health. The areas of learning required by state law include human ecology, growth and development, emergency care, disease control, drug use and abuse, mental health, nutrition, harassment, conflict resolution and personal consumer health. Students will receive instruction in Cardio-Pulmonary Resuscitation and may be certified with additional course work.

PREREQUISITE: Placement recommendation by team teachers

HEALTH EDUCATION 161 (PAH16100 PAH16200)

GRADE: 10 LENGTH: 1 Sem CREDIT: .50 GPA: All Subject

The purpose of health education is to acquaint students with attitudes, values and practices in a way that will enable them to make wise decisions in matters of personal health. The areas of learning required by state law include human ecology, growth and development, emergency care, disease control, drug use and abuse, mental health, nutrition, harassment, conflict resolution and personal consumer health. Students will receive instruction in Cardio-Pulmonary Resuscitation and may be certified with additional course work.

PREREQUISITE: None

PHYSICAL EDUCATION SOPHOMORE BOYS 261 (PEB26100 PEB26200)

GRADE: 10 LENGTH: 1 Sem CREDIT: .50 GPA: All Subject

Sophomores continue to develop basic skills and learn fundamental strategies for use in game play. Students should demonstrate a knowledge of the rules, skills, strategies and etiquette necessary to participate in a variety of activities. Improvement of muscular and cardiovascular fitness will be included in this course. PREREQUISITE: Physical Education 163 or equivalent

PHYSICAL EDUCATION SOPHOMORE GIRLS 261 (PEG27100 PEG27200)

GRADE: 10 LENGTH: 1 Sem CREDIT: .50 GPA: All Subject

Sophomores continue to develop basic skills and learn fundamental strategies for use in game play. Students should demonstrate a knowledge of the rules, skills, strategies and etiquette necessary to participate in a variety of activities. Improvement of muscular and cardiovascular fitness will be included in this course. PREREQUISITE: Physical Education 163 or equivalent

AQUATICS 161 (PSW10100 PSW10200)

GRADE: 10,11,12 LENGTH: 1 Sem CREDIT: .50 GPA: All Subject

In this course the student will be introduced to a variety of aquatic activities. This course is designed to provide the student with knowledge and skills necessary to safely experience the scuba diving and lifeguard training environment. This is a performance course where the student must satisfactorily complete the academic and water skills requirements necessary for each certification. At completion of this course, the student should attain certification as a PADI certified scuba diver and as an American Red Cross Lifeguard. PREREQUISITE: 1.50 Units in Physical Education or equivalent. The student must demonstrate swimming ability.

DANCE 161 (PHD16100 PHD16200)

GRADE: 11,12 LENGTH: 1 Sem CREDIT: .50 GPA: All Subject

This course is designed to improve the student's dance techniques and skills. Styles incorporating ballet, modern, jazz, tap, choreography and improvisation will be included in the course. This is a performance based class. The students will learn and perform a variety of dance techniques that will demonstrate the student's knowledge of the dance combinations taught in class.

PREREQUISITE: 1.50 Units in Physical Education or equivalent

DANCE II 261 (PHD17100 PHD17200)

GRADE: 11,12 LENGTH: 1 Sem CREDIT: .50 GPA: All Subject

Dance II is a class for the experienced dancer. Students will learn a variety of advanced dance techniques and terminology. The students will concentrate on self-choreography in various dance styles. A study of history and appreciation of dance in our society will also be included in this course. This is a performance-based course. PREREQUISITE: 1.50 Units in Physical Education or equivalent, completion of Dance I with a grade of 85% or higher and the approval of the instructional supervisor and dance teacher

FIT FOR LIFE (PHF16100)

GRADE: 10,11,12 LENGTH: 1 Sem CREDIT: .50 GPA: All Subject

This course includes physical exercise and nutrition activities. The class introduces the student to the exploration of lifetime fitness activities, nutrition and health habits. Student understanding and assessment of personal lifestyle influences as well as the education of healthy physical fitness and the application of habits which encourage lifetime fitness are primary goals of this course. This course is taught by a teacher from the Physical Education Department and the Career and Life Skills Department.

PREREQUISITE: 1.00 Unit in Physical Education or equivalent

ADVENTURE EDUCATION 161 (PHA16100 PHA16200)

GRADE: 11,12 LENGTH: 1 Sem CREDIT: .50 GPA: All Subject

Students will participate in a variety of outdoor activities including the basics of rock climbing, rappelling, back packing, canoeing, cross-country skiing and camping. The students will climb the indoor climbing wall and complete activities designed for the high ropes challenge course. A strong emphasis is placed on safety, cooperation, team building and developing problem solving and communication skills. PREREQUISITE: 1.50 Units in Physical Education or equivalent

ADVENTURE EDUCATION 261 (PHA26100 PHA26200)

GRADE: 12 LENGTH: 1 Sem CREDIT: .50 GPA: All Subject

Students will participate in a variety of indoor and outdoor activities including problem-solving initiatives, advanced climbing techniques, kayaking, scuba, survival skills, winter activities and environmental concerns. A strong emphasis is placed on safety, cooperation, team building and developing problem solving and communication skills. Students may enroll in this course for only one semester. PREREQUISITE: 1.50 units in Physical Education or equivalent and successful completion of High Adventure I and approval of instructor

LIFETIME SPORTS & CONDITIONING 161 (PHL16100 PHL16200)

GRADE: 11,12 LENGTH: 1 Sem CREDIT: .50 GPA: All Subject

Lifetime Sports is a continuation of skill development in which students should demonstrate a knowledge of rules, strategies, skills and etiquette required to participate in a variety of lifetime activities such as: badminton, bowling, fitness, golf, pickleball, tennis and volleyball. An emphasis will be placed on understanding why sports, physical activity and the achievement of physical fitness are important in maintaining overall health. Students may enroll in this course for two semesters. PREREQUISITE: 1.50 Units of Physical Education or equivalent

LEADERS PHYSICAL EDUCATION - JUNIOR 163 (PEL76300)

GRADE: 11 LENGTH: 2 Sem CREDIT: 1.00 GPA: All Subject

The junior leader program is designed to focus on rules, officiating, analysis and correction of basic skills, class presentations, basic leadership skills, technique development and learning how to assist with instruction. This course may serve as an exploration for the student who has an interest in pursuing a career in Physical Education or a related field.

PREREQUISITE: Recommendation of Physical Education teacher and department

LEADERS PHYSICAL EDUCATION - SENIOR 263 (PEL77300)

GRADE: 12 LENGTH: 2 Sem CREDIT: 1.00 GPA: All Subject

The senior leader program allows the student the opportunity to work with freshman and sophomore students during their physical education class. Leaders assist with class activities, officiate and aid the teacher in classroom management. PREREQUISITE: Successful completion of the Junior Leader Program and recommendation of department

PHYSICAL MANAGEMENT 171 (PEM17100 PEM17200)

GRADE: 11,12 LENGTH: 1 Sem CREDIT: .50

GPA: All Subject & Academic

This is a course dedicated to the principles of teaching young people the importance of personal fitness and a healthy lifestyle, and the impact of those concepts in all aspects of their lives (physical, intellectual, emotional and social). Physical Management will introduce the application of fitness habits which will encourage a lifetime of fitness. Included are aerobic and anaerobic activities, strength, endurance, flexibility and cardiovascular education as well as basic principles of anatomy, kinesiology, exercise physiology, nutrition and sports injuries. Students may enroll in this course for two semesters. With the approval of the instructional supervisor, and recommendation of the department, a student may enroll for a third semester. Students can not waiver out of physical management. PREREQUISITE: 1.50 Units in Physical Education or equivalent

TEAM SPORTS & CONDITIONING 161 (PHT19100 PHT19200)

GRADE: 11,12 LENGTH: 1 Sem CREDIT: .50 GPA: All Subject

Team Sports is a continuation of skill development in which students should demonstrate a knowledge of rules, skills and strategies required to participate in a variety of sport activities which may include: basketball, pickleball, soccer, softball, touch football and volleyball. An emphasis will be placed on understanding why sports, physical activity and the achievement of physical fitness are important in maintaining overall health. Activities designed to promote cardiovascular and muscular fitness will be included in each unit. Students may enroll in this course for two semesters.

PREREQUISITE: 1.50 Units in Physical Education or equivalent



**STRENGTH TRAINING AND CONDITIONING 161
(PWT16100 PWT16200)**

GRADE: 11,12 LENGTH: 1 Sem CREDIT: .50 GPA: All Subject
Students will improve physical appearance, athletic performance or build self confidence through work out programs designed to meet the student's specific training needs. These programs include general conditioning, improvement of athletic performance and body building. The classroom curriculum emphasizes program assessment, principles of strength training, cardiovascular conditioning and develops positive lifetime fitness habits for each student. An emphasis will be placed on student understanding of strength training exercises and their affect on strength training and performance. Students may enroll in this course for two semesters. With the approval of the instructor, a student may enroll for a third semester. PREREQUISITE: 1.50 Units in Physical Education or equivalent

**STRENGTH TRAINING AND CONDITIONING 261
(PWT26100 PWT26200)**

GRADE: 12 LENGTH: 1 Sem CREDIT: .50 GPA: All Subject
Strength Training and Conditioning II is for students who want to greatly improve their overall strength and athletic abilities while gaining a better understanding of the anatomy and physiology of strength training. A variety of weight training principles, techniques and exercises will be studied, discussed and demonstrated. These exercises and techniques will be implemented into the student designed fitness and weight programs. The classroom curriculum emphasizes principles of strength training, cardiovascular conditioning and fitness and development of muscular strength and endurance. PREREQUISITE: 1.5 units of Physical Education or equivalent, completion of Strength Training and Conditioning I or Physical Management with a grade of 85% or higher and the approval of the instructional supervisor

INTRODUCTION TO STRENGTH TRAINING 161 (PEI16100 PEI16200)

GRADE: 10 LENGTH: 1 Sem GPA: All Subject
Sophomores will improve physical appearance, athletic performance or build self-confidence through workout programs designed to meet the student's specific training needs. These programs include general conditioning, improvement of athletic performance and body building. The classroom curriculum emphasizes program assessment, principles of strength training, cardiovascular conditioning and develops positive lifetime fitness habits for each student. An emphasis will be placed on student understanding of strength training exercises and their effect on strength training and performance. PREREQUISITE: Physical Education 163, or equivalent, and a recommendation from the instructional supervisor and department.

ADAPTIVE PHYSICAL EDUCATION (PEA16100 PEA16200)

GRADE: 9,10,11,12 LENGTH: 1 Sem CREDIT: .50 GPA: All Subject
The adaptive physical education class is designed for the student who cannot participate in regular physical education. Upon the presentation of a doctor's request, the student may be assigned permanently or temporarily to this class. Adapted exercises are planned to improve a particular physical condition based on a doctor's recommendation. PREREQUISITE: Physician's request

ATHLETICS

GRADE: 11,12 LENGTH: 1 Sem GPA: All Subject
Junior and Senior students who participate on a Board of Education approved interscholastic athletic team are eligible to substitute the athletic team participation for exemption in physical education. Exemption requests for first semester will include fall and winter sports. Exemption requests for second semester will include only spring sports.

FUNDAMENTALS OF PERSONAL TRAINING (PTT16100 PTT16200)

GRADE: 11,12 LENGTH: 1 Sem CREDIT: .50 GPA: All Subject
The concept of this course is to offer students the opportunity to become knowledgeable in the areas of Personal Training and Athletic Training. The students will work toward enhancing their knowledge in fitness and athletic training, whereas they could work as a weight room supervisor, personal trainer, and/or be certified to instruct fitness classes. Included are aerobic and anaerobic activities, as well as basic principles of anatomy, kinesiology, exercise physiology, nutrition, and sports injuries. Activities are designed for students to learn the importance of personal fitness, as well as preparing the students for career opportunities in fitness leadership. Students may enroll in this class for one semester only. PREREQUISITE: 1.50 units in Physical Education or equivalent.

DRIVER EDUCATION

DRIVER EDUCATION G 161 (DEC15100 DEC15200)

DRIVER EDUCATION 161 (DEC16100 DEC16200)

GRADE: 10,11,12 LENGTH: 1 Sem
CREDIT: .25 (Classroom) .25 (Laboratory) GPA: All Subject
The purpose of Driver Education is to develop citizens who will be competent and responsible users of the highway transportation system. Driver Education grades are given for the classroom and laboratory phases separately, although the phases are taught concurrently. Students must be a minimum of fifteen years of age at the beginning of the semester during which they are enrolled for the laboratory phase. Students who become 16 prior to the completion of the course are given priority in enrollment. In order to become qualified for an operator's license prior to age 18, the student must pass both phases of Driver Education.

Classroom Phase: The classroom phase is required by state law. State law requires a minimum of 30 clock hours attendance in the classroom phase in order to complete the course. (To be eligible for enrollment, the student must have received a passing grade in at least eight courses during the previous two semesters.) If students enroll in only the classroom phase, the enrollment must occur during the senior year.

Laboratory Phase: State law requires a minimum of six clock hours or its equivalent of attendance in order to complete the course. The lab phase is taken concurrently with the classroom phase.



SCIENCE

Core Courses

The courses listed below indicate paths normally taken by students

SEQUENCE	FRESHMAN	SOPHOMORE	JUNIOR	SENIOR
Team	Biology GT 163	Intro to Chemistry 163 <i>OR</i> Earth Science GT 163	Intro to Physics 163 <i>OR</i> Intro to Chemistry 163	Electives <i>OR</i> Intro to Physics 163
Regular	Biology 163	Chemistry 163	Physics 163	Electives
Honors	Biology 173 <i>OR</i> Physics 173	Chemistry 173	Physics 173 <i>OR</i> Biology 173	Advanced Placement: Biology Chemistry Physics Environmental Science <i>OR</i> Electives

Elective Offerings

COURSES	FRESHMAN	SOPHOMORE	JUNIOR	SENIOR
Anatomy & Physiology 161 & 162			Offered	Offered
Astronomy and Space Sciences 163 & 173		Offered	Offered	Offered
Brain Studies 161		Offered	Offered	Offered
Earth Science 163		Offered	Offered	Offered
Forensic Science 161			Offered	Offered
Horticulture 161 & 162		Offered	Offered	Offered
Materials Science 163 & 173				Offered
Medical Technology 161*		Offered	Offered	Offered
Principles of Applied Science and Technology 163		Offered	Offered	Offered
Science Projects 163 & 173		Offered	Offered	Offered

**Course offered at Glenbrook South Only*

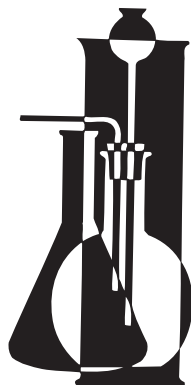

SCIENCE



BIOLOGY GT 163 (SCB15300)

GRADE: 9 LENGTH: 2 Sem CREDIT: 1.00 GPA: All Subject & Academic
A first year biology course that investigates characteristics of living things. Topics include: ecology, evolution, cell structure and function, human systems, DNA, and genetics. Emphasis is placed on graphing skills and content-related reading and writing. Students will be actively involved in this class and will participate in individual and group projects, laboratory exercises, and hands-on activities. PREREQUISITE: Recommendation of department

ELL BIOLOGY 163 (SBC13300)

GRADE: 9,10,11,12 LENGTH: 2 Sem CREDIT: 1.00
GPA: All Subject & Academic

A first year biology course that investigates cell structure and processes, DNA and genetics, biotechnology, human systems, and ecology. Students actively participate through hands-on learning experiences that emphasize listening, speaking, reading, and related vocabulary. In addition, students will enhance their problem-solving skills and will participate in several lab-based activities. Students will be expected to work on individual and group projects. PREREQUISITE: Recommendation of department

BIOLOGY 163 (SBC16300)

GRADE: 9 LENGTH: 2 Sem CREDIT: 1.00 GPA: All Subject & Academic
A first year biology course that investigates the common characteristics of all living organisms including: cell structure and function, energy in living systems, reproduction, growth, development, genetics, evolution, and interactions within and between species in a variety of environments. Throughout the year, students will experience a variety of laboratory activities designed to enhance their problem solving skills and understanding of scientific processes.

Upon registration, students may choose from a cellular approach or an ecological approach. A cellular approach to biology explores the characteristics of life by focusing on both cells and human systems. Dissection may be included in the laboratory activities of this approach. An ecological approach to biology focuses on using our community and local environments to explore the characteristics of life. In depth water/river analysis is included in the laboratory activities of this approach. PREREQUISITE: None

BIOLOGY 173 (9-SBC17300/11-SCB17300*)

GRADE: 9 LENGTH: 2 Sem CREDIT: 1.00 GPA: All Subject & Academic
An in-depth study of the topics typically studied in high school biology. At the honors level, students are expected to have high motivation and genuine curiosity about the subject. High expectations are placed on the students to acquire knowledge through the use of laboratory work, group work, and text-book and electronic reading. In addition, students need to be able to think critically and analytically, and then be able to apply the newfound knowledge to make various connections throughout the year. Due to these course requirements, the student's reading level should be well above average. Students enrolling in honors biology are typically those who will also take other, subsequent honors science courses leading to an Advanced Placement course their senior year. PREREQUISITE: Recommendation of department

BIOLOGY ADVANCED PLACEMENT 283 (SBC28300)

GRADE: 11,12 LENGTH: 2 Sem CREDIT: 1.00 GPA: All Subject & Academic
A fast paced college-level course following the curriculum of the National Advanced Placement Program. The course content includes molecules and cells, genetics and evolution, and organisms and populations. There are twelve required laboratory experiences; outside of class time is required. Board of Education policy requires that students register and take the Advanced Placement Exam in order to receive AP credit. PREREQUISITE: Completion of two years of lab science including biology and chemistry or recommendation of department. Preference will be given to students who have completed or are concurrently enrolled in a third year of lab science.

EARTH SCIENCE GT 163 (SCE15300)

GRADE: 10 LENGTH: 2 Sem CREDIT: 1.00 GPA: All Subject & Academic
This lab course focuses on the structure and composition of the earth. Processing skills, experimental design, data collection and analysis including appropriate graphing skills are learned in the context of a variety of student-centered laboratory experiences. Units cover topics such as earth's materials & surface, plate tectonics, historical geology, meteorology, and natural disasters. PREREQUISITE: Recommendation of department.

EARTH SCIENCE 163 (SCE16300)

GRADE: 11,12 LENGTH: 2 Sem CREDIT: 1.00
GPA: All Subject & Academic

This laboratory course focuses on the structure and composition of the earth including its oceans and atmosphere. Processing skills, experimental design, data collection and analysis including appropriate graphing skills are learned in the context of a variety of earth science labs. Units cover topics such as weather, mineralogy and petrology, and diastrophism (earthquakes, volcanoes, and crustal movement.). PREREQUISITE: None

ENVIRONMENTAL SCIENCE ADVANCED PLACEMENT 383 (SCE28300)

GRADE: 11,12 LENGTH: 2 Sem CREDIT: 1.00 GPA: All Subject & Academic
The AP Environmental Science course is a rigorous college-level course following the curriculum of the National Advanced Placement Program. The purpose of the course is to develop student understanding of major environmental issues facing mankind today and during the foreseeable future. This two-semester course includes extensive laboratory and fieldwork that integrates chemistry, biology, physics, and earth science, as well as statistics, economics and politics. The course is issue-oriented and requires the application of all science disciplines to analyze and propose solutions to important issues. Board of Education policy requires that students register and take the Advanced Placement Exam in order to receive AP credit. PREREQUISITE: Completion of two years of lab science, credit in Advanced Algebra and department recommendation. Preference will be given to upper classmen who have completed or are concurrently enrolled in physics.

INTRODUCTION TO CHEMISTRY 163 (SCC15300)

GRADE: 10,11,12 LENGTH: 2 Sem CREDIT: 1.00

GPA: All Subject & Academic

This laboratory intensive course is designed to teach the fundamental concepts of chemistry. This is a less quantitative, yet strongly lab oriented approach to chemistry. Units in the program include matter and its nomenclature, gas laws, chemical reactions and stoichiometry, solutions and acids/bases, and nuclear chemistry. Connections are made between the chemical concepts and everyday life experiences so that the students may make intelligent decisions related to societal, technological and environmental issues.

PREREQUISITE: Completion of an Algebra program & department recommendation

CHEMISTRY 163 (SCC16300)

GRADE: 10,11,12 LENGTH: 2 Sem CREDIT: 1.00

GPA: All Subject & Academic

This laboratory intensive course focuses on the scientific community, experimentation, and communicating research results. Topics studied include the particulate nature of matter, the periodic table, nomenclature, compounds, gas laws, the mole, atomic structure and history, reactions, stoichiometry, acids/bases, organic and nuclear chemistry. PREREQUISITE: Successful completion of an Algebra program and recommendation of department

CHEMISTRY 173 (SCC173P0) (SCC17300)

GRADE: 10,11,12 LENGTH: 2 Sem CREDIT: 1.00

GPA: All Subject & Academic

An intense course designed for those students with high math and science skills. The honors chemistry program includes the following topics: scientific community and experimentation, particulate nature of matter, gas laws and the mole, atomic history and structure, bonding and reactions, stoichiometry, solutions chemistry, thermochemistry, chemical kinetics, equilibrium, acids and bases and a culminating research-based lab project. Students participate in a holistic approach to science including experimental design and implementation, data analysis and communicating findings to a specified target audience. Greater emphasis is placed on mathematical analysis.

PREREQUISITE: Successful completion of an Algebra program and recommendation of department.

CHEMISTRY ADVANCED PLACEMENT 283 (SCC28300)

GRADE: 11,12 LENGTH: 2 Sem CREDIT: 1.00 GPA: All Subject & Academic

A college-level course following the curriculum of the National Advanced Placement Program. This includes a thorough presentation of the fundamental concepts of chemistry, including extensive laboratory work. It is recommended for students planning careers in science professions. Board of Education policy requires that students register and take the Advanced Placement Exam in order to receive AP credit. PREREQUISITE: Completion of two years of lab science including Chemistry, completion or concurrent enrollment in Pre-calculus, and recommendation of department. Preference will be given to students who have completed or are concurrently enrolled in a third year of lab science.

INTRODUCTION TO PHYSICS 163 (SCP15300)

GRADE: 11,12 LENGTH: 2 Sem CREDIT: 1.00 GPA: All Subject & Academic

Introduction to Physics is a laboratory course designed to teach the fundamental concepts of physics. The course stresses a conceptual understanding of physics, although algebra will be used to investigate physical phenomena. The course will include selected topics from mechanics, waves, electricity and modern physics. Students enrolling in Introduction to Physics have typically taken Introduction to Chemistry. PREREQUISITE: Completion of Algebra and Geometry and recommendation of department.

PHYSICS 163 (SCP16300)

GRADE: 11,12 LENGTH: 2 Sem CREDIT: 1.00 GPA: All Subject & Academic

Physics students study the physical universe by investigating the interactions between matter and energy. Discussion topics may include force, motion, energy, history, relativity, astrophysics, wave motion, sound, and optics. Application through laboratory work is stressed. A phenomenological approach is used. PREREQUISITE: Completion of an Algebra program and recommendation of department

PHYSICS 173 (9-SCP173F0/11,12-SCP17300)

GRADE: 9,11,12 LENGTH: 2 Sem CREDIT: 1.00

GPA: All Subject & Academic

The major goal of Physics 173 is to enable students to explain, predict, and control phenomena dealt with in Newtonian mechanics, waves, the nature of particulate matter and classical electricity. The content of the course consists of a set of core models that explain many common and important phenomena. Students create these models through pivotal experiments. Students sharpen their understanding of these models by using them to develop explanations in small groups and then presenting their findings to the class. The course is designed to attain the desired consensus through discussions.

PREREQUISITE: Completion or concurrent enrollment in an advanced Algebra program and recommendation of department.

PHYSICS ADVANCED PLACEMENT 283 (SCP28300)

GRADE: 12 LENGTH: 2 Sem CREDIT: 1.00 GPA: All Subject & Academic

In AP Physics C students develop and use particle and extended-body models in Newtonian mechanics to account for the motion of objects in terms of forces, energy, momentum, and angular momentum as well as classical models for electric and magnetic fields and basic circuits. Building on the foundation laid in Physics 173, we will freely use differential and integral calculus to expand the range of phenomena that students can describe, explain, predict, and control. The Board of Education requires that students register for and take the Advanced Placement exam in order to receive AP credit.

PREREQUISITE: Physics 173 or recommendation of the department, completion of or concurrent enrollment in AP Calculus AB or BC. Preference will be given to students who have completed or are concurrently enrolled in a third year of lab science

BRAIN STUDIES 161 (SBC46100 SCB46200)

GRADE: 10,11,12 LENGTH: 1 Sem CREDIT: .50

GPA: All Subject & Academic

A one semester, elective course dealing with how the recent studies in brain research have led to an understanding of one's capacity to learn and maximize their human potential. Along with learning basic brain/neuron biology, the student will experience methods for increasing memory, goal achievement, and stress management. Students will also explore brain research that considers multiple intelligences, learning styles, and self-improvement in academic, athletic, artistic and social skills. This is not considered a laboratory course. PREREQUISITE: One credit of laboratory science

HORTICULTURE 161 (SCH16100)

GRADE: 11,12 LENGTH: 1 Sem CREDIT: .50 GPA: All Subject & Academic

A one semester, laboratory science course designed to meet the needs and interests of a wide range of students. Students use the GBN greenhouse to produce a variety of flowering and foliage crops. Topics include: basic plant anatomy, an overview of the plant kingdom, environmental requirements for good plant growth, plant growth regulating chemicals, vegetative plant propagation, production of seasonal greenhouse crops, house plant identification and care, floral arts and specialty items such as hanging baskets, cactus planters, tropical dish gardens and terrariums. PREREQUISITE: One credit of laboratory science

HORTICULTURE 162 (SCH16200)

GRADE: 11,12 LENGTH: 1 Sem CREDIT: .50 GPA: All Subject & Academic

A one semester, laboratory science course designed to meet the needs and interests of a wide range of students. This semester deals with the identification and use of plants in the home landscape. Students will identify deciduous and evergreen trees, shrubs, groundcovers, herbaceous perennials, and flowering annuals. Detailed attention is given to plant propagation by seed. Also included are miscellaneous topics in floral arts and vegetable gardening. The culmination of the spring semester is an annual plant sale in mid May. PREREQUISITE: One credit of laboratory science

A large, stylized, black and white graphic of the equation E=mc² is positioned in the bottom right corner of the page, overlapping the text of the Horticulture 162 course description.

PRINCIPLES OF APPLIED SCIENCE & TECHNOLOGY 163 (SCT16300)

GRADE: 10,11,12 LENGTH: 2 Sem

CREDIT: .50 Applied Technology / .50 Science GPA: All Subject & Academic
 A project based course designed to have students learn the science behind a series of hands-on activities. Problem solving is utilized to overcome problems of design, development, production, and testing of a product. Topics are from both applied technology and science including: robotics, pneumatics, hydraulics, computer design, computer controlled machining, optics (including laser technology), mechanics, electricity, and magnetism. Students work in design teams and present achievements to the class. A team of staff is selected for this course from science and applied tech. Students completing only one semester will receive .50 credit in applied technology.

PREREQUISITE: One credit of laboratory science

ASTRONOMY AND SPACE SCIENCES 163 (SCA16300)

GRADE: 10,11,12 LENGTH: 2 Sem CREDIT: 1.00

GPA: All Subject & Academic

An overview of the fascinating universe will be opened up to students in this yearlong laboratory course. Students will learn about the mysteries of the universe and how its secrets are revealed. The night sky will be studied through direct observation of the motions of the moon, planets, and sun. Structure and composition of the universe will be discovered through the eyes of space telescopes and probes. Students will study the historical and scientific contributions of scientists and cosmology and the theory of relativity to theorize about the origin and ultimate destiny of the universe. Students will also look at the objects that make up the universe and their relationship to other sciences like geology and biology. The course will include a look at the solar system, black holes, and stellar evolution. Students will be expected to research a variety of topics using images, the Internet, current data and discoveries, and direct observation. PREREQUISITE: One credit of laboratory science & completion of a Geometry program

ASTRONOMY AND SPACE SCIENCES 173 (SCA17300)

GRADE: 10,11,12 LENGTH: 2 Sem CREDIT: 1.00

GPA: All Subject & Academic

The mysteries of the universe and how its secrets are revealed will be studied in-depth by students in this yearlong laboratory course. Direct observation of the night sky, current data and discoveries, computer-based image processing, and images of deep sky objects will be utilized to study the motion structure, and composition of the universe and the solar system. Students will study cosmology and the theory of relativity to theorize about the origin and ultimate destiny of the universe. A look at the historical and pivotal scientific contributions of scientists, the orbital mechanics associated with spacecraft travel, and the use of electromagnetic waves to image stellar objects will also be studied. Students will be expected to research a variety of topics using images, mathematics, the Internet, real data, and direct observation.

PREREQUISITE: One credit of laboratory science, recommendation of department, and completion of a Geometry program

ANATOMY & PHYSIOLOGY: BONES, MUSCLES, & NERVES (SCB36100)

GRADE: 11,12 LENGTH: 1 Sem CREDIT: 0.50 GPA: All Subject & Academic

The focus of this semester-long course is on the human anatomy and physiology necessary to pursue any healthcare career. The lessons are designed to develop a solid understanding of how the human body works. Material will be approached through case-based investigations using a whole-class inquiry approach. Anatomy and Physiology will enable students to develop an understanding of anatomical positions and a general overview of organ systems, to review the chemical composition of living matter (concepts of matter and energy, molecules and atoms, chemical bonding as related to biochemical processes), to identify and explain major cell types and tissues of the human body and to identify and explain the functions of the nervous system as well as the skeletal and muscular systems. PREREQUISITE: Completion of Biology and completion of or concurrent enrollment in third year of lab science.

FORENSIC SCIENCE 163 (SCF16100)

GRADE: 11,12 LENGTH: 1 Sem CREDIT: 0.50 GPA: All Subject & Academic

Forensic Science gives students the opportunity to use their scientific skills and knowledge in biology, chemistry, and physics as they analyze crime scenes and formulate conclusions. Students will learn how to secure a crime scene, analyze the situation, collect evidence, perform appropriate tests, and formulate conclusions. They will present their findings in the form of written "police reports," and oral presentations in front of a "jury." Topics presented will relate to Biology (fingerprint analysis, analysis of blood and DNA, hair analysis, footprint casting), Chemistry (toxicology studies, fiber analysis), Physics (car accident reconstruction, blood spatter analysis, ballistics), and other disciplines such as Anthropology and Criminal Justice.

PREREQUISITE: Completion of Biology and Chemistry and completion of or concurrent enrollment in third year of lab science. (Pending Board Approval)

MATERIALS SCIENCE (SCM16300/SCM17300)

GRADE: 12 LENGTH: 2 Sem CREDIT: 1.00 GPA: All Subject & Academic

The progress of civilization is an integral part of the history of Man and his materials - the Stone Age, the Iron Age, and today's Age of Silicon. Materials determine the technologies that provide protection, communication, information, construction, mechanization, agriculture, energy, transportation, and health. This laboratory-based course will introduce students to the production, processing, behavior, selection, and uses of six classes of materials: metals, ceramics, polymers, composites, semiconductors, and biomaterials. Knowing why glass shatters, steel is tough, rubber stretches and recovers, nylon can be drawn, and how nano gold is different from bulk gold, makes possible the selection of materials for enormously different applications. Studying failures such as the Titanic sinking, bridges collapsing, or smaller failures like light bulbs burning out or clothing staining are important parts of this course. Special attention is given to nanoscale materials and devices because of their potential for defining the next generation of important materials and machines. A student generated design project using science and engineering principles will culminate this year long course.

PREREQUISITE: Completion of Biology, Chemistry, and Physics.

SCIENCE PROJECTS 163/173 (SCX83300 SCX84300)

GRADE: 10,11,12 LENGTH: 2 Sem CREDIT: 1.00

GPA: All Subject & Academic

This course is for students wishing to explore a science topic in-depth, conduct scientific research, or see how art, music, or other interests apply to science. This innovative yearlong course will give students the opportunity to determine their own personal research interest and develop a research proposal to be pursued. It is designed for motivated students who want to know how science relates to the real world. A mixture of lecture, class discussions, hands-on activities, the Internet, and mentors will be used to develop a hypothesis, research, test, and draw conclusions. Students are expected to complete the research by writing a scientific paper and present an oral report. Topics and ideas come from a variety of sources including but not limited to meteorology, geology, oceanography, biology, chemistry, physics, and engineering. Students can also compete in national competitions such as Intel, Exploravision, and the NASA Student Involvement Program. This course may be repeated for credit. Honors credit is available and requires completion of additional activities/projects. PREREQUISITE: One credit in science

MEDICAL TECHNOLOGY 161* (SCM36105 SCM36205)

GRADE: 10,11,12 LENGTH: 1 Sem CREDIT: .50

GPA: All Subject & Academic

Medical Technology is a one-semester course designed to introduce students to the issues, practices, and technologies associated with the medical professions. This elective course is especially suited to those with an intention or interest in pursuing a career in a medical field. PREREQUISITE: Biology 163

**Course offered at Glenbrook South only*

SOCIAL STUDIES

Core Courses

SEQUENCE	FRESHMAN	SOPHOMORE	JUNIOR	SENIOR
Team	World Civ GT 163	It's The Law/Current Issues GT 161	U.S. History GT 163	
Regular	World Civ 163		U.S. History 163 American Studies History	
Honors	World Civ 173		U.S. History 173 U.S. History AP 183	
Academy	Social Studies Academy 193	Social Studies Academy 293	Social Studies Academy 393	Social Studies Academy 493

Elective Offerings

COURSES	FRESHMAN	SOPHOMORE	JUNIOR	SENIOR
Anthropology 161		Offered	Offered	Offered
Comparative Global Issues 171		Offered	Offered	Offered
European History 161		Offered	Offered	Offered
European History AP 183		Offered		
Government & Politics AP 183				Offered
Independent Study 161		Offered	Offered	Offered
International Relations 161		Offered	Offered	Offered
Macroeconomics AP 181		Offered	Offered	Offered
Political Science 161		Offered	Offered	Offered
Psychology 161			Offered	Offered
Psychology AP 183				Offered
Social Studies Simulation 161		Offered	Offered	Offered
Sociology 161		Offered	Offered	Offered
Urban Studies 161		Offered	Offered	Offered
World Geography 161		Offered	Offered	Offered
World History AP 183				Offered
World Religions 161		Offered	Offered	Offered

SOCIAL STUDIES



ANTHROPOLOGY 161 (SIA16100)

GRADE: 10,11,12 LENGTH: 1 Sem CREDIT: .50

GPA: All Subject & Academic

This course is a survey of anthropology. It consists of units of study that include an introduction (what is anthropology?), human evolution, the earliest cultures, culture and survival, the study of the past, social organization, social integration and the role of the anthropologist in the modern world.

PREREQUISITE: History of World Civilizations

COMPARATIVE GLOBAL ISSUES 171 (SIC17100)

GRADE: 10,11,12 LENGTH: 1 Sem CREDIT: .50 GPA: All Subject & Academic

This honors course will survey the modern development of three civilizations increasingly important to our interdependent world. The course will utilize a comparative thematic approach to study Africa, Latin America, and Asia. Special attention will be placed upon the transitions from colonialism to independence and beyond, as well as the historical roots of contemporary world problems. Student assessment will take the form of traditional objective tests, writing assignments, individual and group projects, and a current event component. PREREQUISITE: History of World Civilizations, grade of A or B

IT'S THE LAW/CURRENT ISSUES GT 161 (SII15300)

GRADE: 10 LENGTH: 2 Sem CREDIT: 1.00 GPA: All Subject & Academic

It's the Law/Current Issues GT is paired with sophomore English and comprises the second year of the TEAM program. The course has an integrated curriculum that combines English skills and the basic concepts of law. The course examines legal terms, the criminal process, jury system, landmark cases of the Supreme Court, and personal rights and responsibilities in a way that focuses on the practical impact the law has on students in their day-to-day lives. English skills include research, oral presentations, listening skills, independent reading, critical thinking, and writing. The course looks at current issues which have a legal orientation to provide relevance and application skills. PREREQUISITE: None

DEBATE 163 (ETD16300)

GRADE: 9,10,11,12 LENGTH: 2 Sem CREDIT: 1.00 GPA: All Subject

The beginning or novice debate class is designed to be taken for one or two semesters. The course stresses the fundamentals of research and argument development. Basic formalized debate theory is emphasized, with a concentration on helping students to understand that every issue, whether it is one of policy or value, has multiple sides. Students will learn research techniques, including on-line computer searches, gather data on specified topics, construct arguments based on the secured data and present the arguments in a traditional debate format. During the first semester, students will receive an introduction to the three most common formats of debate. Actual debating first semester is devoted to the policy debate format on the current national debate resolution. Second semester stresses value and congressional debate, while continuing policy debating. Students enrolled in Debate 163 will attend competitions outside the classroom confines during each semester.

PREREQUISITE: None

DEBATE SEMINAR (ETD18300, ETD19300)

GRADE: 10,11,12 LENGTH: 2 Sem CREDIT: 1.00 GPA: All Subject

Debate Seminar is an honors level course for those students who have had experience in either Debate 163 or in co-curricular debate activities. Students enrolled in Debate Seminar must participate on the competitive Glenbrook North debate team. ETD18300 is reserved for one-person Lincoln/Douglas debaters; ETD19300 enrolls two-person policy debaters. Debate theory is emphasized and the students are required to read scholarly journals on argumentation theory and practice. The course also stresses advanced argumentation skills and research techniques. Debaters are given instruction in evidence selection, argument organization, logic, and analysis. These arguments, both affirmative and negative, must be utilized in the competitive debates in which each student participates. Debate competitions are held after school and on most weekends. Students in Debate Seminar are required to attend at least three tournaments each semester. PREREQUISITE: Recommendation of instructor.

EUROPE/ADVANCED PLACEMENT 183 (SVE28300)

GRADE: 10 LENGTH: 2 Sem CREDIT: 1.00 GPA: All Subject & Academic

AP Europe is a college level course offered for potential college credit. The course examines the leading intellectual, cultural, social, and political elements of the European past from the High Middle Ages to the post-World War II era. Lectures and class discussions comprise the bulk of class time. Essay writing serves as the principal evaluative assessment. As per Board of Education policy, students enrolled in Advanced Placement courses must take AP examinations in order to receive AP credit. PREREQUISITE: History of World Civilizations and department recommendation

EUROPEAN HISTORY: 1920-PRESENT 161 (SIE16100)

GRADE: 10,11,12 LENGTH: 1 Sem CREDIT: .50 GPA: All Subject & Academic

The course is an examination and analysis of the major themes of 20th Century European history such as: the rise of dictatorships; the coming, waging, and aftermath of World War II; the Holocaust; the Cold War; and present day Europe. PREREQUISITE: History of World Civilizations

GOVERNMENT & POLITICS/ADVANCED PLACEMENT 183 (SVG28300)

GRADE: 12 LENGTH: 2 Sem CREDIT: 1.00 GPA: All Subject & Academic

Areas studied during the first semester include the constitutional foundations of American government, the citizen base of politics, political parties and interest groups, and the three branches of government. During the second semester, units include the source of public authority and political power, the relationship between the state and society and the relationships between citizens and states. The governments of Britain, Russia, China, Iran, Nigeria, and Mexico are emphasized. According to Board of Education Policy, students enrolled in Advanced Placement courses must take AP examinations in order to receive AP credit.

PREREQUISITE: U.S. History and department recommendation

HISTORY OF WORLD CIVILIZATIONS GT 163 (SHC15300)

GRADE: 9 LENGTH: 2 Sem CREDIT: 1.00 GPA: All Subject & Academic
A world history component of the Freshman TEAM Program. English and social studies teachers and curricula are paired to provide a specialized learning environment for students that need additional support and respond to a cooperatively taught, interrelated curriculum, that emphasizes individual student needs. PREREQUISITE: Placement recommendation by eighth grade Social Studies teacher and GBN Social Studies Department

HISTORY OF WORLD CIVILIZATIONS 163 (SHC16300)

GRADE: 9 LENGTH: 2 Sem CREDIT: 1.00 GPA: All Subject & Academic
Students will study the history of ancient and modern civilizations throughout the world. Students will examine the major institutions and events that have fostered the history of various countries in both the western and non-western world. This approach provides a greater understanding of the global perspective we all must strive to achieve as citizens of the world today. PREREQUISITE: Placement recommendation by eighth grade Social Studies teacher and GBN Social Studies Department

HISTORY OF WORLD CIVILIZATIONS 173 (SHC17300)

GRADE: 9 LENGTH: 2 Sem CREDIT: 1.00 GPA: All Subject & Academic
An honors course that examines the content of world history in depth with emphasis on cause and effect, analysis and synthesis of events, and extensive development of the student's ability to write a well organized and coherent essay that argues a position on a historical topic or theme. Strong abstract reasoning skills are needed for students to be successful in the honors course. PREREQUISITE: Placement recommendation by eighth grade Social Studies teacher and GBN Social Studies Department

ESL HISTORY OF WORLD CIVILIZATIONS (SHC13300)

GRADE: 9,10,11,12 LENGTH: 2 Sem CREDIT: 1.00
GPA: All Subject & Academic
This course will study the history of the world from ancient times to the present. The course looks at universal themes, key individuals, ideas, and events that have all converged to make the world what it is today. The course emphasizes the use of academic vocabulary within the context of world history. Students work on listening, speaking, reading, and vocabulary skills consistently throughout the course.

INDEPENDENT STUDY 161

GRADE: 10,11,12 LENGTH: 1 Sem CREDIT: .50 GPA: All Subject & Academic
This course serves two functions: one is to handle the remediation of students who have failed the Constitution Test in U.S. History (a state mandate); second, to provide an opportunity for students who wish to pursue a topic that time and curricula demands do not allow for in our regular courses. Students need to arrange their plan of study with a cooperating teacher in the Social Studies Department. PREREQUISITE: Approval by the Instructional Supervisor

INTERNATIONAL RELATIONS 161 (SIN16100)

GRADE: 10,11,12 LENGTH: 1 Sem CREDIT: .50 GPA: All Subject & Academic
International Relations is a course that examines the formation and function of foreign policy in the United States and in other nations. The focus is on contemporary world problems, with an emphasis on current events. Through readings, discussion, simulations and films, students will examine a variety of topics, including diplomacy, power, military conflict, and the global economy. Students will learn to think critically about international affairs in a way that allows them to understand today's news headlines, as well as yesterday's and more importantly, tomorrow's. PREREQUISITE: History of World Civilizations

MACROECONOMICS ADVANCED PLACEMENT 181 (SVM28200)

GRADE: 10,11,12 LENGTH: 1 Sem CREDIT: .50 GPA: All Subject & Academic
The primary goal of the course is to provide students with a basic understanding of economic principles. The curriculum emphasizes monetary and fiscal policy, the business cycle, economic growth, international trade and current economic problems. Differing philosophies such as the Keynesian, Monetarist, and supply-side viewpoints are examined. Text and course coverage is at an accelerated pace to allow students to be ready for the AP Macroeconomics exam in early May. According to Board of Education Policy,

students enrolled in Advanced Placement courses must take AP examinations in order to receive AP credit. PREREQUISITE: History of World Civilizations and Department recommendation

POLITICAL SCIENCE 161 (SPL16100)

GRADE: 10,11,12 LENGTH: 1 Sem CREDIT: .50 GPA: All Subject & Academic
A course that deals with the philosophic basis of the American political system; how our national, state, and local governments are structured; how our government functions; political behavior; and the application of our laws through the study of specific court cases. PREREQUISITE: None

PSYCHOLOGY 161 (SPY16100)

GRADE: 11,12 LENGTH: 1 Sem CREDIT: .50 GPA: All Subject & Academic
Psychology is the study of behavior and mental processes. Psychologists provide and invaluable service to our society. They research why people behave in ways that they do and more importantly what can be done to change behavior. Psychologists investigate issues that affect our daily lives. Therefore, the study of psychology will give you new ways to understand why people act, think, and feel as they do. We will engage in the exploration of such topics as learning, thinking, perception, personality, development, psychological disorders, motivation, and emotion. Students will explore these topics in a variety of ways, including through large and small group discussions, cooperative group work, experimental activities, films, and guest speakers. This is an excellent class to not only learn about why others behave as they do, but to learn about yourself as well. PREREQUISITE: None

PSYCHOLOGY/ADV. PLACEMENT 183 (SVP28300)

GRADE: 12 LENGTH: 2 Sem CREDIT: 1.00 GPA: All Subject & Academic
A full year course designed to give students a college level experience and prepare them for the College Board exam in Psychology. Content areas include: methods, approaches, and history of the discipline; biological basis of behavior; sensation and perception; states of consciousness; learning; cognition; motivation and emotion; developmental psychology; personality; testing and individual differences; abnormal psychology; treatment of disorders; and social psychology. According to Board of Education Policy, students enrolled in Advanced Placement courses must take AP examinations in order to receive AP credit. PREREQUISITE: Department recommendation

SOCIAL STUDIES SIMULATION 161 (SRS16100)

GRADE: 10,11,12 LENGTH: 1 Sem CREDIT: .50 GPA: All Subject & Academic
This course uses a computer simulation as a method of understanding, analyzing, and applying information relating to problems in our world today. Currently included in this program is an internet-based conferencing simulation on the Arab-Israeli conflict, sponsored by the University of Michigan. Students role-play and interact with students in high schools from other states and a number of foreign countries. PREREQUISITE: History of World Civilizations

SOCIOLOGY 161 (SOC16100)

GRADE: 10,11,12 LENGTH: 1 Sem CREDIT: .50 GPA: All Subject & Academic
Sociology deals with the basic principles of human interaction. Students are introduced to the rudiments of scientific investigation in the area of human behavior. Special attention is given to such topics as culture, status and role, social inequality, crime and deviance, and the institutions of education, religion, and the family. A thirty hour volunteer project is a required part of each student's final exam. PREREQUISITE: None

U.S. HISTORY GT 163 (SHU15300)

GRADE: 11 LENGTH: 2 Sem CREDIT: 1.00 GPA: All Subject & Academic
This course is the Social Studies component in the Junior TEAM program. English and Social Studies teachers and curricula are paired to provide a specialized learning environment for students that need additional support and respond to cooperatively taught, interrelated curriculum that emphasizes individual student needs. This class fulfills the requirement of the State of Illinois to pass a Constitution Test. PREREQUISITE: None

U.S. HISTORY 163 (SHU16300)

GRADE: 11 LENGTH: 2 Sem CREDIT: 1.00 GPA: All Subject & Academic
 The course traces the origin and development of the United States with emphasis on the political, economic, and social institutions. Significant time is devoted to the 20th century and to the rise of the United States as a world power. This class fulfills the requirement of the State of Illinois to pass a Constitution Test. PREREQUISITE: None

AMERICAN STUDIES: HISTORY 163 (SHU163A0)

GRADE: 11 LENGTH: 2 Sem CREDIT: 1.00 GPA: All Subject & Academic
 American Studies is an interdisciplinary option for regular level juniors to fulfill their English and U.S. History requirements. The American Studies curriculum and planning are integrated, capitalizing on the relationship among American history, culture, literature, art, and music. The course has a thematic framework and a chronological structure. Each section of Americana Studies is composed of a 90-minute block for English and a coordinating block for U.S. History. That is, both sections will be made up of a single group of students. The English/history teacher team will coordinate daily instruction. Scheduling will make possible shared large group presentations. PREREQUISITE: None

U.S. HISTORY 173 (SHU17300)

GRADE: 11 LENGTH: 2 Sem CREDIT: 1.00 GPA: All Subject & Academic
 An honors course that examines the history of the United States in depth with emphasis on cause and effect, analysis and synthesis of events, and extensive development of the student's ability to write a well organized and coherent essay that argues a position on a historical topic or theme. This class fulfills the requirement of the State of Illinois to pass a Constitution Test. PREREQUISITE: History of World Civilizations, grade of A or B

U.S. HISTORY/ADVANCED PLACEMENT 183 (SHU28300)

GRADE: 11 LENGTH: 2 Sem CREDIT: 1.00 GPA: All Subject & Academic
 A.P. U.S. History is an accelerated program that includes emphasis on individual work utilizing a seminar approach. American history is examined through the use of documents and college level interpretive materials from both a chronological and thematic viewpoint. This class fulfills the requirement of the State of Illinois to pass a Constitution Test. According to Board of Education Policy, students enrolled in Advanced Placement courses must take AP examinations in order to receive AP credit. PREREQUISITE: History of World Civilizations and department recommendation

ESL U.S. HISTORY 163 (SHU13300)

GRADE 10,11,12 LENGTH: 2 Sem CREDIT: 1.00

GPA: All Subject & Academic

This course will study the history of the United States, from those who first settled the land to the modern era. The course looks at universal themes, key individuals, ideas, and events that have all converged to make this country what it is today. The course emphasizes the use of academic vocabulary within the context of American history. Students work on listening, speaking, reading, and vocabulary skills consistently throughout the course. This course also fulfills the requirement of the State of Illinois to pass a Constitution Test.

URBAN STUDIES 161 (SRU16100)

GRADE 10,11,12 LENGTH: 1 Sem CREDIT: .50 GPA: All Subject & Academic
 Urban Studies considers the history, geography, politics, and ethnography of the city of Chicago. Students read *The City of Big Shoulders*, by R. Spinney, and other related texts. Particular emphases are the 1893 World's Columbian Exposition, Chicago in the 1920's and 1930's, and the tenure of Mayor Richard J. Daley. Each student must submit a photo or film project at the semester's end. PREREQUISITE: None

WORLD GEOGRAPHY: PEOPLE & PLACES 161 (SIG16100)

GRADE: 10,11,12 LENGTH: 1 Sem CREDIT: .50 GPA: All Subject & Academic
 This course is structured to analyze geographic issues in the world, and how man is affected by geography. The class places emphasis on the following geographic themes: location, place, relationships within places, movement, and how regions form and change. PREREQUISITE: History of World Civilizations

WORLD HISTORY ADVANCED PLACEMENT 183 (SVW28600)

GRADE: 12 LENGTH: 2 Sem CREDIT: 1.00 GPA: All Subject & Academic
 This course has students examining the world's development and human interactions from a global perspective. The approach is both chronological and regional, with emphasis on the most recent thousand years of history. The following themes are emphasized throughout the course: change and continuity over time, technology, demography and its impact upon peoples and environments, social and gender structure, cultural and intellectual developments, and the ways in which all of these are impacted by cultural contacts between peoples. As per Board of Education policy, students enrolled in Advanced Placement courses must take AP examinations in order to receive AP credit. PREREQUISITE: History of World Civilizations and department recommendation

WORLD RELIGIONS 161 (SRW16100)

GRADE: 10,11,12 LENGTH: 1 Sem CREDIT: 0.50

GPA: All Subject & Academic

This course will focus on exploration and analysis of comparative themes addressing world religious traditions. Students will analyze foundations, beliefs, and cultural impact for religions throughout our nation and world. Students will leave the class with a better understanding of the world's religions and of their world today. The course will include field trips to local houses of worship, as well as several guest speakers. PREREQUISITE: History of World Civilizations

GLENBROOK ACADEMY 193 GRADE: 9 (SSA19300)**GLENBROOK ACADEMY 293 GRADE: 10 (SSA29300)****GLENBROOK ACADEMY 393 GRADE: 11 (SSA39300)****GLENBROOK ACADEMY 493 GRADE: 12 (SSA49300)**

LENGTH: 2 Sem CREDIT: 1.00 GPA: All Subject & Academic

The Glenbrook Academy of International Studies is a four year District 225 program for those who have demonstrated a history of academic excellence and an interest in a concentrated program of international studies. The Academy meets daily for coordinated, intensive training in English, foreign languages, and history. Two years of World History, one year of U.S. History, and one year of current global issues is the current sequence.

PREREQUISITE: Entrance is by application only during the spring of 8th Grade

SPECIAL EDUCATION

COURSES	FRESHMAN	SOPHOMORE	JUNIOR	SENIOR
Beginning DLS English 1	Offered	Offered	Offered	Offered
Beginning DLS English 2	Offered	Offered	Offered	Offered
Beginning DLS English 3	Offered	Offered	Offered	Offered
Beginning DLS English 4	Offered	Offered	Offered	Offered
Intermediate DLS English 1	Offered	Offered	Offered	Offered
Intermediate DLS English 2	Offered	Offered	Offered	Offered
Intermediate DLS English 3	Offered	Offered	Offered	Offered
Intermediate DLS English 4	Offered	Offered	Offered	Offered
Advanced DLS English 1	Offered	Offered	Offered	Offered
Advanced DLS English 2	Offered	Offered	Offered	Offered
Advanced DLS English 3	Offered	Offered	Offered	Offered
Advanced DLS English 4	Offered	Offered	Offered	Offered
English 163	Offered			
English 263		Offered		
English 363			Offered	
English 463				Offered
<hr/>				
Beginning Algebra	Offered	Offered	Offered	Offered
Algebra 1	Offered	Offered	Offered	Offered
Algebra 2	Offered	Offered	Offered	Offered
Beginning DLS Mathematics 1	Offered	Offered	Offered	Offered
Beginning DLS Mathematics 2	Offered	Offered	Offered	Offered
Beginning DLS Mathematics 3	Offered	Offered	Offered	Offered
Beginning DLS Mathematics 4	Offered	Offered	Offered	Offered
Business Math	Offered	Offered	Offered	Offered
Geometry	Offered	Offered	Offered	Offered
<hr/>				
World Civilization 163	Offered			
U.S. History 163			Offered	
<hr/>				
DLS Science	Offered	Offered	Offered	Offered
Science	Offered	Offered	Offered	Offered
<hr/>				
Health 163		Offered		
<hr/>				
Consumer Education 161				Offered
<hr/>				
Driver Education		Offered	Offered	Offered
Current Events 163	Offered	Offered	Offered	Offered
Reading Strategies 161	Offered	Offered	Offered	Offered
Independent Study 161	Offered	Offered	Offered	Offered
Art 163	Offered	Offered	Offered	Offered
Social Issues 161	Offered	Offered	Offered	Offered
Single Living	Offered	Offered	Offered	Offered
<hr/>				
Step Class			Offered	Offered
Transitions for Life	Offered	Offered	Offered	Offered
Self Determination			Offered	Offered
<hr/>				
Peer Mentoring 161			Offered	Offered
<hr/>				
Study Strategies 163	Offered			
Study Strategies 263		Offered		
Study Strategies 363			Offered	
College 101				Offered



SPECIAL EDUCATION

COLLEGE 101

GRADE: 12 LENGTH: 1 Sem CREDIT: .50 GPA: All Subject & Academic
This course is designed to help students identify, develop and strengthen the skills and abilities that will support their efforts to succeed in college and beyond. Topics include: exploring what it means to be responsible for one's own learning; examining, assessing and building on past learning experiences; identifying and using ways (strategies/methods) strengthening reading, writing, listening, speaking and critical thinking skills; identifying or clarifying reasons for being in college; and exploring the roles they might play in the global community.

CONSUMER EDUCATION 161 (TBC11100 TDC11100 TDE11100)

GRADE: 12 LENGTH: 1 Sem CREDIT: .50 GPA: All Subject
Consumer Education assists students toward adult independence. Areas covered include banking, loans, automobile purchase, insurance, and independent living skills. This class meets the state graduation requirement.
PREREQUISITE: None

CURRENT EVENTS 163 (TDT12300) (Based on a rotation)

GRADE: 9,10,11,12 LENGTH: 2 Sem CREDIT: 1.00
GPA: All Subject & Academic
This class focuses on understanding local, national and international events by utilizing newspapers, news magazines, computer networks and television news broadcasts. Discussion centers on identifying historical themes, using history as a predictor of future events, listening to diverse opinions and forming coherent personal opinions about news events, and news figures.
PREREQUISITE: None

BEGINNING DLS ENGLISH 1, 2, 3, 4

(TDE10300 TDE20300 TDE30300 TDE40300)

GRADE: 9,10,11,12 LENGTH: 2 Sem CREDIT: 1.00
GPA: All Subject & Academic
This beginning DLS English class is designed to enhance student abilities in Basic and Life Skills English. The class covers basic reading, writing and language concepts. The skills addressed are as follows: sight work, vocabulary and spelling, grammar rules and structure, sentence and paragraph writing, and reading comprehension. Daily class work involves journal writing, vocabulary and spelling, grammar, and novel reading. PREREQUISITE: Successful completion of previous year or equivalent course

INTERMEDIATE DLS ENGLISH 1, 2, 3, 4

(TDE11300 TDE21300 TDE31300 TDE41300)

GRADE: 9,10,11,12 LENGTH: 2 Sem CREDIT: 1.00
GPA: All Subject & Academic
This intermediate DLS English class is designed to enhance a student's skills in English usage and applications. Skills to be developed are writing compound sentences and paragraphs. Reading comprehension will concentrate on reading literature for details, main ideas and simple inferencing. Daily class work includes journal writing, sentence writing and grammar rule application, reading literature and paragraph writing.
PREREQUISITE: Successful completion of previous year or equivalent course

ADVANCED DLS ENGLISH 1, 2, 3, 4

(TDE12300 TDE22300 TDE32300 TDE42300)

GRADE: 9,10,11,12 LENGTH: 2 Sem CREDIT: 1.00
GPA: All Subject & Academic
This advanced DLS English class is designed to enhance more complex language arts skills. A variety of reading, writing, and language concepts are covered. Areas of instruction include grammar, vocabulary, spelling, writing skills, reading comprehension, and public speaking. Students will conduct research and participate in creative writing assignments.
PREREQUISITE: Successful completion of previous year or equivalent course

ENGLISH 163, 263, 363, 463

(TBE16300 TBE26300 TBE36300 TBE46300)

GRADE: 9,10,11,12 LENGTH: 2 Sem CREDIT: 1.00 each year
GPA: All Subject & Academic
Students at each grade level follow the curriculum, content, and objectives established by the English Department. Instruction is modified as needed. Students work on composition, reading comprehension, and analysis of literature. PREREQUISITE: Successful completion of previous year or equivalent course

HEALTH 161 (TBH12200 TDH12200)

GRADE: 10,11 LENGTH: 1 Sem CREDIT: .50 GPA: All Subject
Health is a class designed to fulfill the state requirement for students who are unable to participate in the standard health curriculum. Topics covered include physical and emotional health, sexuality, wellness, first-aid and CPR.
PREREQUISITE: None

HISTORY OF WORLD CIVILIZATION 163 (TBW11300 TDT14300)

GRADE: 9 LENGTH: 2 Sem CREDIT: 1.00 GPA: All Subject & Academic
This course is a survey of world history from primitive civilizations to the present. A broad range of cultures and civilizations are covered, focusing on multiple perspectives of history. Students are presented with methods to further improve study skills and interpret data. PREREQUISITE: None

BEGINNING DLS MATH 1, 2, 3, 4

(TDM10300 TDM20300 TDM30300 TDM40300)

GRADE: 9,10,11,12 LENGTH: 2 Sem CREDIT: 1.00
GPA: All Subject & Academic
This beginning DLS math class is designed to teach students everyday life skills. The skills addressed are as follows: the four basic operations (addition, subtraction, multiplication, division), money concepts, and time.
PREREQUISITE: Successful completion of previous year or equivalent course

BUSINESS MATHEMATICS (TDM52300) (Based on a rotation)

GRADE: 9,10,11,12 LENGTH: 2 Sem CREDIT: 1.00
GPA: All Subject & Academic
This class is designed for students who need a functional daily life math curriculum. Students will learn check writing and balancing, endorsing checks, debit cards, estimating prices and amounts, percents and decimals, income taxes, charge accounts and credit cards, transportation and housing costs, insurance and investing, saving accounts and deposits, and budgeting.
PREREQUISITE: Teacher recommendation

GEOMETRY (TEM17300)

GRADE: 9,10,11,12 LENGTH: 2 Sem CREDIT: 1.00
GPA: All Subject & Academic
This course focuses on topics such as area, volume, right triangles, parallelism, and a review of algebra. This course is designed to develop critical thinking skills through informal arguments and formal proof. Geometric relationships and properties are presented through manipulative tools and geometric constructions. PREREQUISITE: Successful completion of Algebra and teacher recommendation

ALGEBRA 1 (TBM11300)

GRADE: 9,10,11,12 LENGTH: 2 Sem CREDIT: 1.00

GPA: All Subject & Academic

This course focuses on algebraic skills, concepts, and application while strengthening arithmetic skills. Topics include operations with integers, simplifying expressions, factoring, absolute value, linear and quadratic functions, inequalities, and systems of equations.

PREREQUISITE: Pre Algebra or equivalent and teacher recommendation

ALGEBRA 2 (TBM11300)

GRADE: 9,10,11,12 LENGTH: 2 Sem CREDIT: 1.00

GPA: All Subject & Academic

This course focuses on algebraic skills, concepts, and application while strengthening arithmetic skills. Topics include operations with integers, simplifying expressions, factoring, absolute value, linear and quadratic functions, inequalities, and systems of equations.

PREREQUISITE: Pre Algebra or equivalent and teacher recommendation

BEGINNING ALGEBRA (TDM50300)

GRADE: 9,10,11,12 LENGTH: 2 Sem CREDIT: 1.00

GPA: All Subject & Academic

This course is designed to identify deficit areas and strengthen skills that may not have been previously mastered. Units include standard pre-algebra topics such as integer manipulations, evaluating expressions, solutions to simple linear equations, and solutions to systems of equations. Additional concepts and skills will be introduced and application of all skills will be used as we explore geometric concepts. PREREQUISITE: Pre Algebra or equivalent and teacher recommendation

PEER MENTORING (ULPM5100 ULPM5200)

GRADE: 10,11,12 LENGTH: 1 Sem CREDIT: .50

GPA: All Subject & Academic

The purpose of this course is to partner students with other students with disabilities to develop a mutually beneficial, caring relationship. The peer mentor will assist the student with special needs to further develop academic and/or social skills. Peer mentors are placed into both regular and special education (DLS or ELS) classrooms. Students are required to attend regularly, participate in periodic discussion groups and will be evaluated by the assigned teacher. PREREQUISITE: Recommendation of teacher and school counselor, with final approval of peer mentor sponsor

**READING STRATEGIES 161 (TER12300 TER22300)**

GRADE: 9,10,11,12 LENGTH: 1 Sem CREDIT: .50

GPA: All Subject & Academic

Reading Strategies is offered to the student currently below grade level in reading comprehension. An individualized diagnostic reading assessment identifying strengths and weaknesses is developed for each student. Strategies to improve retention and overall comprehension are emphasized.

PREREQUISITE: Recommendation of staff

DLS SCIENCE (TDS16300)

GRADE: 9,10,11,12 LENGTH: 2 Sem CREDIT: 1.00

GPA: All Subject & Academic

This DLS Science class is designed to teach students basic skills and knowledge in the areas of: unified science, biology, and chemistry. Hands-on activities are used on a daily basis as well as reading and writing. Multi-sensory methods are used for daily course work. PREREQUISITE: None

SCIENCE (TBS11300)

GRADE: 9,10,11,12 LENGTH: 2 Sem CREDIT: 1.00

GPA: All Subject & Academic

A laboratory course stressing scientific process skills and the relationship between science and the students' daily life. During this general survey course students will study the following areas: earth science, life science, physical science, biology and chemistry. PREREQUISITE: None

SELF DETERMINATION (TDT16300)

GRADE: 9,10,11,12 LENGTH: 2 Sem CREDIT: 1.00

GPA: All Subject & Academic

This course is designed for students within the DLS program and is an advanced level class in a sequence pertaining to transition. The philosophy of this class is to design activities and simulations based on individual goals. The four major components of self-determination are self-knowledge, decision-making, problem-solving, and goal setting. Students in this course will gain skills that will lead to a greater degree of independence and self-determination. PREREQUISITE: Teacher recommendation

SINGLE LIVING (TDH12300)

GRADE: 9,10,11,12 LENGTH: 2 Sem CREDIT: 1.00

GPA: All Subject & Academic

This course provides students in the DLS program with independent living skills in both the educational system and in the community. Single Living assists students in developing the skills essential to become productive and independent citizens. Students will gain practical knowledge and skills in the areas of self-care, budgeting, consumer education, vocational options and recreation and leisure. Coursework focuses on skill acquisition at the student's individual level rather than at his or her year in school.

PREREQUISITE: Recommendation of staff

SOCIAL ISSUES 161 (TBT18100 TDT18100)

GRADE: 9,10,11,12 LENGTH: 2 Sem CREDIT: 1.00

GPA: All Subject & Academic

Social Issues is a social studies course designed for the special education student. The course has been developed to teach students about social issues and current events within the world today. This is intended to further develop citizenship skills and social awareness. The course requires hands-on activities, group discussions, field trips, research, and a community service project each semester. PREREQUISITE: None

STEP CLASS/STEP WORK (TDV12300 TBV11300 TEW12300)

GRADE: 9,10,11,12 LENGTH: 2 Sem CREDIT: 1.00 for each segment

GPA: All Subject

The Student Transitional Educational Program provides career education instruction for special education students. This course will focus on career exploration and job readiness skills. Students are presented with a range of information regarding vocations and given tools to assess their own career interests. STEP class assists students in developing the skills necessary to become productive members of the work force. STEP work provides an opportunity for students to apply classroom vocational skills to a school-based job site or competitive community employment situation. A job coach is available to assist students in finding and maintaining a job.

PREREQUISITE: Recommendation of staff

STUDY STRATEGIES 163, 263, 363 (TEU11300 TEU12300 TEU17300)

GRADE: 9,10,11,12 LENGTH: 2 Sem CREDIT: 1.00

GPA: All Subject

Emphasis is placed on developing skills to meet the individual learning needs of students as well as on facilitating the transfer of these skills to academic areas. This course earns .5 credit per semester, up to 2 credits total. Study Strategies I is designed to assist students in developing the study skills they need to be successful high school students. Instruction is provided in areas such as paraphrasing, note-taking, and organization. Study Strategies 263 and 363, open to sophomores, juniors and seniors, continues to focus on students' individual academic needs; this is an adjunct to mainstream courses.

PREREQUISITE: Recommendation of staff

TRANSITIONS FOR LIFE/TRANSITIONS FOR LIFE WORK (TDV14300 TEW90300)

GRADE: 9, 10, 11, 12 LENGTH: 2 Sem CREDIT: 1.00 GPA: All Subject

This class is designed for students within the DLS program and is a beginning level class in a sequence pertaining to transition. The curriculum directly relates to student's IEP goals in the area of transition. Topics will relate to life activities and pursuits: work, education, leisure, transportation, housing, community access, etc. PREREQUISITE: None

UNITED STATES HISTORY 163 (TBU11300 TDU12300)

GRADE: 10,11 LENGTH: 2 Sem CREDIT: 1.00 GPA: All Subject & Academic

This course fulfills the requirement established by the State of Illinois - a one year course in United States History and satisfactory completion of a test on the Constitution of the United States. Although designed for juniors, sophomores may enroll if approved by the Instructional Supervisor.

PREREQUISITE: None

INDEPENDENT STUDY 161

GRADE: 9,10,11,12 LENGTH: 1 Sem CREDIT: .50

GPA: All Subject & Academic

Independent Study is designed to offer the opportunity for students to take or make up a variety of courses that they may have failed or have had difficulty in scheduling. Students work independently on coursework with instruction geared to their level and learning style. Students work on a contractual basis focusing on attendance, behavior and work production.

PREREQUISITE: Recommendation of staff

ART 163 (TBA11300 TBA21300)

GRADE: 9,10,11,12 LENGTH: 2 Sem CREDIT: 1.00 GPA: All Subject

This course is designed to be a comprehensive survey of various art techniques, styles, and artists. Students will be learning the use of many art media, including watercolors, pastels, oil paint, computer, and colored pencils, as well as gaining knowledge of Impressionism, abstraction, expressionism, commercial art and mosaics. Students will be encouraged to expand their art knowledge, and appreciate and try different art styles and techniques over the course of the class. PREREQUISITE: Recommendation of staff

DRIVER EDUCATION (TDD12300) (Offered on a rotation)

GRADE: 10,11,12 LENGTH: 2 Sem CREDIT: 1.00 GPA: All Subject

The purpose of Driver Education is to develop citizens who will be competent and responsible users of the highway transportation system. Driver Education grades are given for the classroom and laboratory phases separately, although the phases are taught concurrently.

Classroom Phase: The classroom phase is required by state law. State law requires a minimum of thirty (30) clock hours of attendance in the classroom phase in order to complete the course.

Laboratory Phase: State law requires a minimum of six (6) clock hours or its equivalent of attendance in order to complete the course. The lab phase is taken concurrently with the classroom phase. This course is spread over two semesters in order to give students more practice time.

TRANSITION FOR LIFE CLASS/TRANSITIONS FOR LIFE WORK (TDV14300 TEW90300)

GRADE: 10,11 LENGTH: 2 Sem CREDIT: 1.00 GPA: All Subject

This class has a focus on life activities and pursuits, such as work, education, leisure, transportation, housing, community access, etc. Students will also learn about laws that protect individuals with disabilities. A general exploration of post high school education and skills needed for careers that students might be interested in pursuing is emphasized. Transitions for Life Work provides an opportunity for students to relate classroom vocational skills to a school-based job site or competitive community employment situation. A job coach is available to assist students in finding and maintaining a job. Student job skills will be evaluated by staff and employer, as well as student self-evaluations. PREREQUISITE: Teacher recommendation

PHYSICAL EDUCATION (TBP13300 TBP12300)

GRADE: 9,10,11,12 LENGTH: 2 Sem CREDIT: 1.00 GPA: All Subject

This course is designed for the students to explore new activities while developing an attitude that participation in physical activities can lead to a lifetime of recreational fun and healthy living. Basic skills and physical fitness necessary to participate in a variety of conditioning, team sports, and lifetime sports activities are individualized based on student needs.

PREREQUISITE: Teacher recommendation



WORLD LANGUAGES

FRESHMAN	SOPHOMORE	JUNIOR	SENIOR
French 163	French 263	French 363	French 463 French 551/552 <i>OR</i> French 563 <i>OR</i> French AP Language
French 263	French 363	French 463	French 573 <i>OR</i> French AP Language
French 273	French 373	French 473	French AP Literature
French 373	French 473	French 573 <i>OR</i> French AP Language	
German 163	German 263 German 273	German 363 German 373	German 463 German 473
Modern Hebrew 163 Modern Hebrew 263	Modern Hebrew 263		
Latin 163	Latin 263 Latin 273	Latin 363 Latin 373	Latin 463 Latin 473
Mandarin Chinese 163	Mandarin Chinese 263 Mandarin Chinese 273	Mandarin Chinese 363 Mandarin Chinese 373	
Russian 163	Russian 263 Russian 273	Russian 363 Russian 373	Russian 463 Russian 473 Russian 563 <i>OR</i> Russian 573 <i>OR</i> Russian AP Prototype 583
Spanish G163 Spanish 163 Spanish 263 Spanish 273 Spanish 373	Spanish G263 Spanish 263 Spanish 363 Spanish 373 Spanish 473	Spanish G363 Spanish 363 Spanish 463 Spanish 473 Spanish 573 <i>OR</i> Spanish AP Language	Spanish G463 Spanish 463 Spanish 563 Spanish 573 <i>OR</i> Spanish AP Language <i>OR</i> Spanish AP Literature

WORLD LANGUAGES

Foreign language students at all levels work in the language laboratory on a weekly basis to perfect their speaking and listening skills. Each language course has as its goal to reach a particular degree of oral proficiency in the target language. From beginning through advanced levels students are expected to participate in the target language in the classroom, as well as in the lab.

French

FRENCH 163 (FFR16300)

FRENCH 263 (FFR26300)

FRENCH 363 (FFR36300)

FRENCH 463 (FFR46300)

FRENCH 563 (FFR56300)

GRADE: 9,10,11,12 LENGTH: 2 Sem CREDIT: 1.00

GPA: All Subject & Academic

French 163 and 263 focus on communication through the acquisition of French vocabulary and grammar in meaningful contexts. Students are trained in all four skills - listening, speaking, reading and writing. French culture is an integral part of each course. Students apply what they have learned in beginning and intermediate level projects. In French 363, 463 and 563 students complete their study of French grammar and continue to refine their conversation, reading and writing skills. Authentic sources provide much of the material for these courses - French magazines, contemporary short stories, videos and current news bulletins. PREREQUISITE: Credit in the previous course or equivalent & department recommendation

FRENCH 273 (FFR27300)

FRENCH 373 (FFR37300)

FRENCH 473 (FFR47300)

FRENCH 573 (FFR57300)

GRADE: 9,10,11,12 LENGTH: 2 Sem CREDIT: 1.00

GPA: All Subject & Academic

The honors program differentiates itself from the regular program early on with its accelerated pacing, higher expectations and greater use of French in the classroom. Honors students are regularly engaged in research and project-based applications to demonstrate their language competency. The French 273 curriculum focuses on the four language skills with special emphasis on speaking, the writing of essays and the reading of short stories. French 373, 473 and 573 expose students to the contemporary culture of France and Francophone areas through the reading of French magazines and contemporary literature - both short stories and novels. Interactive CD ROM's, videos and audio cassettes serve these advanced students' needs well as they expand and refine their language skills with communication as the primary goal. PREREQUISITE: Credit in the previous honors course or equivalent & department recommendation

French CONVERSATION & CULTURE 551 & 552 (FFR55100/FFR55200)

GRADE: 11,12 LENGTH: 1 or 2 Sem CREDIT: 0.50 or 1.00

GPA: All Subject & Academic

Students will focus on French conversation but will also work on listening, reading, and writing skills. Students will discuss current events, read stories, study movies, create travel itineraries, take cultural field trips, and learn about French cooking, art, and music. An on-line course will be utilized to improve speaking, listening, and reading skills in French. Assessments will be project based. PREREQUISITE: successful completion of four years of high school French.

French Advanced Placement (Language) 583 (FFR58300)

GRADE: 11,12 LENGTH: 2 Sem CREDIT: 1.00 GPA: All Subject & Academic
Advanced Placement French Language is an intense college level course taught for potential college credit. It emphasizes the ability to understand spoken French in various conversational situations and to express oneself accurately both in conversation and in writing with reasonable fluency. Students acquire an extensive vocabulary and a grasp of structures to allow

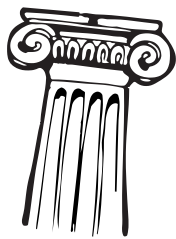

the easy, accurate reading of newspaper and magazine articles, as well as of French literary texts. Short stories, novels and poetry serve to implement written and oral skills. A variety of authentic primary sources, CD's, videos and CD ROM's are used to enhance comprehension and oral expression. Board of Education policy requires that students register and take the Advanced Placement exam in order to receive AP credit. PREREQUISITE: Credit in French 473, 573 or equivalent & department recommendation

French Advanced Placement (Literature) 583 (FFR68300)

GRADE: 11,12 LENGTH: 2 Sem CREDIT: 1.00 GPA: All Subject & Academic
Advanced Placement French Literature is a college level course taught for potential college credit. It is a literature course with lectures and discussions in French. French literary works are analyzed both orally and in writing. Board of Education policy requires that students register and take the Advanced Placement exam in order to receive AP credit in the course. PREREQUISITE: Credit in French 573, AP French Language 583 or equivalent & department recommendation

German

GERMAN 163 (FGE16300)

GERMAN 263 (FGE26300)

GERMAN 363 (FGE36300)

GERMAN 463 (FGE46300)

GRADE: 9,10,11,12 LENGTH: 2 Sem CREDIT: 1.00

GPA: All Subject & Academic

German 163 and 263 stress the four language skills of listening, speaking, reading and writing. The fundamentals of pronunciation and grammar are integrated into these courses along with a geographical and cultural introduction to Germany. Short stories and video provide authentic source material for students. German is the language of the German 363 and 463 classroom. Grammar is reviewed and refined for use in compositions and readings. Students read selected pieces of twentieth century literature and strengthen their listening and speaking skills through communicative activities and videos. PREREQUISITE: Credit in the previous course or equivalent & department recommendation

GERMAN 273 (FGE27300)

GERMAN 373 (FGE37300)

GERMAN 473 (FGE47300)

GRADE: 10,11,12 LENGTH: 2 Sem CREDIT: 1.00

GPA: All Subject & Academic

The extensive use of German in the classroom and increased student responsibility for learning and investigation are the distinctive characteristics of these courses. Honors courses require more independent work, higher level thinking and proceed at a faster pace than their regular level counterparts. In German 273 training in all four language skills continues. Advanced cultural topics are introduced. German 373 and 473 focus on readings of a more sophisticated nature - German plays, poetry and masterpieces of twentieth century literature. PREREQUISITE: Credit in the previous honors course or equivalent & department recommendation

Latin

LATIN 163 (FLA16300)

LATIN 263 (FLA26300)

LATIN 363 (FLA36300)

LATIN 463 (FLA46300)

GRADE: 9,10,11,12 LENGTH: 2 Sem CREDIT: 1.00

GPA: All Subject & Academic

Latin 163 and 263 present the fundamentals of Latin grammar and vocabulary. Emphasis is placed on English word studies, mythology, Roman history and the cultural debt of western civilization to ancient Roman society. Appropriate readings, including selections from Julius Caesar's Gallic Wars (Latin 263), are studied. In Latin 363 and 463 students are exposed to the writings of such authors as Cicero, Virgil and Plautus, as well as to the history

of the times. Students continue to fine tune their understanding of Latin grammar and to increase their English vocabulary through their ever-expanding knowledge of Latin vocabulary. PREREQUISITE: Credit in the previous course & department recommendation

LATIN 273 (FLA27300)

LATIN 373 (FLA37300)

LATIN 473 (FLA47300)

GRADE: 10,11,12 LENGTH: 2 Sem CREDIT: 1.00

GPA: All Subject & Academic

In the honors courses pacing is more rapid and there is more emphasis on discovering and applying knowledge about the Latin language and Roman culture. Some independent reading of Latin sources is required. Latin 273 focuses on the writings of Julius Caesar, Martial and Livy. Latin 373 and 473 offer a review of advanced syntax and vocabulary. The readings include selections from Cicero, Ovid, Virgil, and Plautus. Students study the use of language in both Latin literary prose and poetry. In Latin 473 students learn poetic analysis. PREREQUISITE: Credit in the previous honors course or equivalent & department recommendation

Mandarin Chinese

Mandarin CHINESE 163 (FMC16300)

GRADE: 9,10,11,12 LENGTH: 2 Sem CREDIT: 1.00

GPA: All Subject & Academic

Mandarin Chinese 163 stresses all four skills: listening, speaking, reading and writing. Emphasis will be placed on building a core vocabulary, acquainting students with essential grammatical structures, and developing near-native pronunciation. Additionally, students will study aspects of Chinese culture, geography, and history. PREREQUISITE: None

Mandarin CHINESE 263 (FMC26300)

GRADE: 9,10,11,12 LENGTH: 2 Sem CREDIT: 1.00

GPA: All Subject & Academic

This course continues the development of the student's four communication skills in Mandarin Chinese. In addition to listening, speaking, reading, and writing, students will continue to study various aspects of Chinese culture. The use of authentic materials and instructional technology are components of this course. PREREQUISITE: Successful completion of Mandarin Chinese 163.

Mandarin CHINESE 273 (FMC27300)

GRADE: 9,10,11,12 LENGTH: 2 Sem CREDIT: 1.00

GPA: All Subject & Academic

This course is for students who have demonstrated above average ability in the study of Mandarin Chinese, and continues the development of the student's four communication skills in the language. In addition to listening, speaking, reading, and writing, students will continue to study various aspects of Chinese culture. The use of authentic materials and instructional technology are components of this course. PREREQUISITE: Recommendation of the Mandarin Chinese teacher and approval of the instructional supervisor.

Mandarin CHINESE 363 (FMC36300)

GRADE: 10,11,12 LENGTH: 2 Sem CREDIT: 1.00

GPA: All Subject & Academic

This course builds on previously learned communication skills as well as deepens the understanding of Chinese culture. Development of vocabulary and advanced grammatical structures is highlighted. Greater emphasis is placed on reading and writing, in addition to the refinement of listening and speaking skills. PREREQUISITE: successful completion of Mandarin Chinese 263.

Mandarin CHINESE 373 (FMC37300)

GRADE: 10,11,12 LENGTH: 2 Sem CREDIT: 1.00

GPA: All Subject & Academic

This course builds on previously learned communication skills as well as deepens the understanding of Chinese culture. Formal composition work is continued, in addition to the refinement of listening and speaking skills. Development of vocabulary and advanced grammatical structures is highlighted. PREREQUISITE: recommendation of Mandarin Chinese teacher and approval of the instructional supervisor.

Hebrew

MODERN HEBREW 163 (FHE16300)

GRADE: 9,10,11,12 LENGTH: 2 Sem CREDIT: 1.00

GPA: All Subject & Academic

This course initiates the student into the basic communication skills: listening, speaking, reading, and writing. Emphasis will be placed on building a core vocabulary, acquainting students with essential structure, and developing near-native pronunciations. Additionally, students will study aspects of Israeli culture, geography, and history. *(Pending Board approval)

MODERN HEBREW 263 (FHE26300)

GRADE: 9,10,11,12 LENGTH: 2 Sem CREDIT: 1.00

GPA: All Subject & Academic

This course continues the development of the student's four communication skills in Hebrew. In addition to listening, speaking, reading, and writing, students will continue to study various aspects of Israeli culture. The use of authentic materials and instructional technology are components of this course. PREREQUISITE: successful completion of Modern Hebrew 163 or approval of the instructional supervisor.

Russian

RUSSIAN 163 (FRU16300)

RUSSIAN 263 (FRU26300)

RUSSIAN 363 (FRU36300)

RUSSIAN 463 (FRU46300)

RUSSIAN 563 (FRU56300)

GRADE: 9,10,11,12 LENGTH: 2 Sem CREDIT: 1.00

GPA: All Subject & Academic

Russian 163 and 263 stress the skills of listening, speaking, reading and writing. The student receives a thorough grounding in grammar and learns some aspects of Russian culture, geography, and history. The reading of literature is a key component of Russian 363, 463, and 563. Videos, movies, and radio broadcasts provide authentic cultural material. PREREQUISITE: Credit in the previous course or equivalent & department recommendation

RUSSIAN 273 (FRU27300)

RUSSIAN 373 (FRU37300)

RUSSIAN 473 (FRU47300)

RUSSIAN 573 (FRU57300)

RUSSIAN 583 (FRU58300)

GRADE: 10,11,12 LENGTH: 2 Sem CREDIT: 1.00

GPA: All Subject & Academic

The material used in honors courses is covered at a more rapid pace than in the regular Russian program. Russian 273 focuses on the learning of grammar, the spoken language and simple readings from Russian folk literature. In Russian 373 students begin to apply their advanced grammar in more sophisticated writing situations and in the reading of short stories. Russian 473, 573, and 583 students are expected to exhibit a high degree of maturity and critical thinking as they study short stories and the poetry of nineteenth and twentieth century Russian literature. Russian 583 students will follow the prescribed curriculum in preparation for the Russian prototype AP exam. PREREQUISITE: Credit in the previous honors course or equivalent & department recommendation

Spanish

SPANISH 163 (FSP16300)

SPANISH 263 (FSP26300)

SPANISH 363 (FSP36300)

SPANISH 463 (FSP46300)

SPANISH 563 (FSP56300)

GRADE: 9,10,11,12 LENGTH: 2 Sem CREDIT: 1.00

GPA: All Subject & Academic

Spanish 163 and 263 focus on language competency through the acquisition of Spanish vocabulary and grammar in meaningful contexts. The student is trained in all four language skills - listening, speaking, reading and writing. In Spanish 363 students begin to apply and expand language skills with communication as the primary goal. Appropriate Spanish selections are read. The Spanish 463 course uses topical vocabulary units as a catalyst for communicative activities and the spoken language. The reading of short stories and the study of Spanish art and artists provide a focus for the refinement of all four language skills. Spanish 563 is designed for the student who wants to take a senior year Spanish language course but does not want to take Advanced Placement. The course emphasizes oral proficiency, practical vocabulary, grammar review and reading. PREREQUISITE: Credit in the previous course & department recommendation

SPANISH G 163 (FSP15300)

SPANISH G 263 (FSP25300)

SPANISH G 363 (FSP35300)

SPANISH G 463 (FSP45300)

GRADE: 9,10,11,12 LENGTH: 2 Sem CREDIT: 1.00

GPA: All Subject & Academic

Spanish G 163 begins a language sequence for students who are motivated to learn Spanish but would meet with limited success in a traditional Spanish curriculum. This course focuses on language competency through the acquisition of Spanish vocabulary and grammar in meaningful context. Students will learn all four skills: speaking, listening, reading, and writing. Students will be guided to success by an emphasis on explicit organizational skills training and language learning strategies, as well as through the teacher's use of a more kinesthetic style of learning. Assessment will be based on what students can do with the language rather than what they know about the language. Spanish G 263, 363 and 463 continue the learning sequence into the second, third and fourth years. PREREQUISITE: Placement recommendation by eighth grade foreign language teacher or high school teacher recommendation and instructional supervisor approval.

SPANISH 273 (FSP27300)

SPANISH 373 (FSP37300)

SPANISH 473 (FSP47300)

SPANISH 573 (FSP57300)

GRADE: 9,10,11,12 LENGTH: 2 Sem CREDIT: 1.00

GPA: All Subject & Academic

Spanish 273 differentiates itself from the regular program early on with its accelerated pacing, higher expectations and greater use of Spanish in the classroom. In Spanish 373 and 473 speaking and writing skill work are video-based. The video series Destinos also provides the cultural basis for these two courses. Students fine tune their grammar skills as they apply them daily in meaningful communication. Spanish 373 focuses on the history and culture of Spain while Spanish 473 emphasizes Spanish art and the reading of literature in the form of short stories and plays. Spanish 573 is designed for talented, motivated students who want to use their language skills in authentic contexts rather than focus on Advanced Placement college credit. Students expand and refine their language skills with fluency in communication as the primary goal. PREREQUISITE: Credit in the previous honors course or equivalent & department recommendation

Spanish Advanced Placement (Language) 583 (FSP58300)

GRADE: 11,12 LENGTH: 2 Sem CREDIT: 1.00

GPA: All Subject & Academic

Advanced Placement Spanish Language is a college level course taught for potential college credit. It emphasizes conversation through various communicative activities and the discussion of contemporary issues. Students will acquire an extensive vocabulary and a grasp of structures to allow the easy, accurate reading of newspaper and magazine articles, as well as of modern Hispanic literature. Extensive training in composition organization and writing will be an integral part of the course. Board of Education policy requires that students register and take the Advanced Placement exam in order to receive AP credit in the course. PREREQUISITE: Credit in Spanish 473, 563, 573, AP Spanish Literature 583 or equivalent & department recommendation

Spanish Advanced Placement (Literature) 583 (FSP68300)

GRADE: 11,12 LENGTH: 2 Sem CREDIT: 1.00

GPA: All Subject & Academic

Advanced Placement Spanish Literature is a college level course taught for potential college credit. It is a literature course with lectures and discussions in Spanish. Hispanic literary works are analyzed both orally and in writing. Board of Education policy requires that students register and take the Advanced Placement exam in order to receive AP credit. PREREQUISITE: Credit in Spanish 473, 573, AP Spanish Language 583 or equivalent & department recommendation

Academy

The Glenbrook Academy of International Studies is a four-year district-wide program for those who have demonstrated a history of academic excellence and an interest in a concentrated program of international studies. The Academy meets daily for coordinated, intensive training in English, foreign languages and social studies. Entrance is by application only during the spring of the eighth grade. Each entering Academy class is assigned a language to be studied during the four-year program.

FRENCH - ACADEMY 193

FRENCH - ACADEMY 293

FRENCH - ACADEMY 393

FRENCH - ACADEMY 493

FRENCH - ACADEMY 593

GRADE: 9,10,11,12 LENGTH: 2 Sem CREDIT: 1.00

GPA: All Subject & Academic

PREREQUISITE: Credit in the previous course & department recommendation

GERMAN - ACADEMY 193

GERMAN - ACADEMY 293

GERMAN - ACADEMY 393

GERMAN - ACADEMY 493 (FGE47300)

GRADE: 9,10,11,12 LENGTH: 2 Sem CREDIT: 1.00

GPA: All Subject & Academic

PREREQUISITE: Credit in the previous course & department recommendation

MANDARIN CHINESE - ACADEMY 193

MANDARIN CHINESE - ACADEMY 293

MANDARIN CHINESE - ACADEMY 393 (FMC39300)

MANDARIN CHINESE - ACADEMY 493

GRADE: 9,10,11,12 LENGTH: 2 Sem CREDIT: 1.00

GPA: All Subject & Academic

PREREQUISITE: Credit in the previous course & department recommendation

SPANISH - ACADEMY 193

SPANISH - ACADEMY 293 (FSP29300)

SPANISH - ACADEMY 393

SPANISH - ACADEMY 493

SPANISH - ACADEMY 593

GRADE: 9,10,11,12 LENGTH: 2 Sem CREDIT: 1.00

GPA: All Subject & Academic

PREREQUISITE: Credit in the previous course & department recommendation

INDEX

Absences and Make-up Work	5
Advanced Placement Course Policy	3
Athletic/Physical Education Waiver	7
Career and Life Skills	11-16
Applied Technology	12-13
Business Education	14-15
Family and Consumer Sciences	15-16
Class Size	9
Computer Technology	36
Correspondence and Internet Courses	6
Course Designations	3
Course Placement	1
Credits	3
Driver Education	40
Early Dismissal/Late Arrival	8
Early Graduation	5
English	17-24
Final Examinations	5
Fine Arts	25-32
Art	27-28
Theatre/drama	28
Music	29-30
Radio/Television Broadcasting	31-32
Glenbrook Academy of International Studies	3, 20
Glenbrook Scholars	4
Glenbrook Team Program	3
Grade Point Average	3
Grading and Grading Symbols	2
Graduation Requirements	2
Honors Courses Differentiation	3
Honor Roll	4
Instructional Supervisors	9
Laboratory Assistant Program	9
Mathematics	33-36
National Honor Society	4
Pass-Fail Program	4
Peer Mentoring	51
Physical Education, Health and Driver Education	7, 37-40
Policy on Courses Taken in Non-Glenbrook Summer Programs	6
Repeat of Course	5
Schedule Changes	8
Science	41-44
Second Semester Senior Final Exam Policy	6
Social Studies	45-48
Special Education	49-52
State Universities in Illinois	10
Testing	7
Withdrawal from Class	5
World Languages	53-56
Writing Advisory Grade	5

Photo credits: Kathy Barnes, Diane Freeman & Cindie Kozelub